

LIBERTY TWP
ADA SD

00230

Hardin County, Ohio
Michael T. Bacon, Auditor

24-160017.0000
G03

RES
2023

sale

Eff Rate:- 52.58 — 51.79 — 46.64 — 40.58 — a/r

2020 ALLEN III ROBERT & JA
2021 ALLEN III ROBERT & JA
2022 ALLEN III ROBERT & JA
2023 ALLEN III ROBERT & JANI
2511 SR 235
ADA OH 45810

| | | | | | |
|------------|---------|---------|---------|---------|---------|
| Tax Year | 2020 | 2021 | 2022 | 2023 | CAMA |
| Prop Cls | 511 | 511 | 511 | 511 | 511 |
| Acres | 7.0000 | 7.0000 | 7.0000 | 7.0000 | |
| Land100% | 36460 | 36460 | 36460 | 68740 | 68750 |
| Bldg100% | 177340 | 177340 | 177340 | 196710 | 196700 |
| Totl100% | 213800t | 213800t | 213800t | 265460t | 265450t |
| Cauvl00% | | | | | |
| Tax Value: | | | | | |
| Land 35% | 12760 | 12760 | 12760 | 24060 | 24060 |
| Bldg 35% | 62070 | 62070 | 62070 | 68850 | 68850 |
| Totl 35% | 74830t | 74830t | 74830t | 92910t | 92910t |
| Hmstd35% | 64190 | 47350 | 47350 | 59240 | |
| Owner Oc | 70.62 | 51.22 | 42.76 | 49.38 | |
| Hmstd RB | | | | | |
| Net Tax | 3534.78 | 3500.44 | 3177.30 | 3411.20 | |
| Sp-Asmnt | 21.00 | 23.00 | 21.00 | 21.00 | |

\$0
N PT NE 1/4 SE 1/4 S16
7.00A
01.0-01-16-017

| | | | | | | | |
|------|------|------|------|-------|-------|---|-------|
| SHB+ | CONS | TYPE | FACT | SQ-FT | VALUE | a | *MAIN |
| 1HB | F | M | | 1548 | | b | ADDTN |
| 1 | F/C | A | | 234 | | c | PORCH |
| | FFP | P | | 24 | 960 | d | GRAGE |
| | F3 | G | | 888 | 21310 | e | PORCH |
| | OFF | P | | 88 | 2640 | f | PORCH |
| | PAT | P | | 504 | 1510 | | |

| | | | | | | | |
|-------|-------|------------|-------|---------------|--------|---------|---------|
| Sale# | #p | sale date | To | Type/Invalid? | Sale\$ | co:land | co:blgd |
| 571 | 0 | 1988-07-27 | | * | 40000 | 0 | 64800 |
| Year | Land | Bldg | Total | Net Tax | | | |
| 2019 | 12340 | 55290 | 67630 | 3168.92 | | | |
| 2018 | 12340 | 55290 | 67630 | 3097.14 | | | |

project
110 HOG CREEK MAINLINE - HOG CR. XA/2023
500 HARDIN COUNTY LANDFILL XA/2023
577 OTTAWA RIVER PROJECT MAINT XA/2021

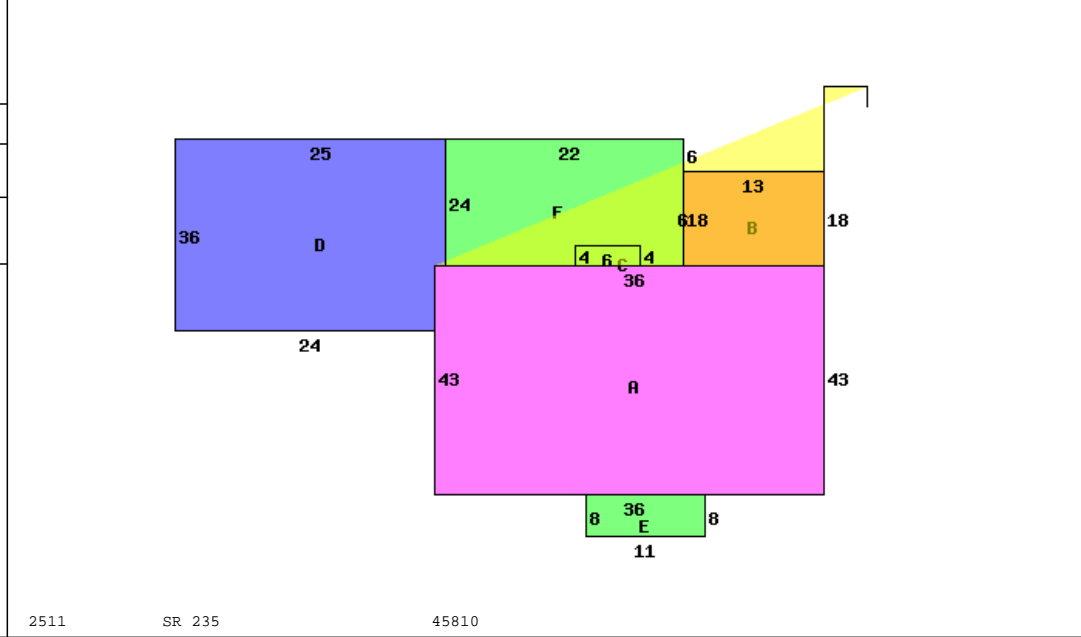

2511 SR 235 45810

| | | |
|-----------------|-----------------|---------------------------|
| Occupancy | 1 Single Family | *DWELLING COMPUTATIONS |
| Story Height | 1H | Sq-Ft Value |
| Floor Level | Main | FRAME 1782 130070 |
| | Part Upper | FRAME 1548 45250 |
| | Basement | 1161 21630 |
| | Subtotal | 196950 |
| Shingle | Roof | GABLE |
| Plaster/Drywall | X X | Fireplaces 4000 |
| Unfinished Wall | X | Plumbing 2100 |
| Floor/Carpet | X X | Garages and Carpets 21310 |
| Floor/Tile-Lino | X | Extra Features 5110 |
| Number of Rooms | 1 7 4 | Total Value 229470 |
| Bedrooms | 3 | |
| Fireplace | | PUB ELECTRIC |
| Openings | 2 | PUB GAS |
| Stacks | 2 | PRIV WATER |
| Central Heat | A | PRIV SEWER |
| HOT WATER | | PUB PAVED ST/RD |
| Plumbing | | Neighborhood: |
| Standard | 1 | Code: 2400 |
| Extra 3 Fixture | 1 | Dwl/Gar/NC% 1.2700 |

| | | | | | | | | |
|---------------|----------|-----------|-------|-----------|---------------|----------|-------|--------|
| Bldg Type | SHB+Cons | DixHt | Unit | Blt/Renov | Replace | Phy | Fnc | True |
| 1 DWELLING | 1HB F | FtxFt | Area | Cond | Value | Dpr | Dpr | Value |
| 6 Pole Barn | | 60X36 | 2160 | C+ | OLD/AV 252420 | .55 | | 144260 |
| | | | | C | 1997AV 25920 | .55 | | 11660 |
| homesite | acres/ | effective | depth | actual | effective | extended | true | |
| small acreage | frontage | frontage | depth | rate | rate | value | value | |
| homesite | 1.0000 | 25000 | 25000 | 25000 | 25000 | 25000 | 25000 | |
| | 5.0000 | 5000 | 3750 | 18750 | 18750 | | | |
| | 1.0000 | 25000 | 25000 | 25000 | 25000 | 25000 | 25000 | |

Call Back: Sign: PSN Date: 2015-08-20 Lister: 24-160017.0000-v082020R
Call Back: Sign: PSN Date: 2015-08-20 Lister:

LIBERTY TWP
ADA SD

00230

Hardin County, Ohio
Michael T. Bacon, Auditor

24-160017.0000
G03

RES
2023

CAMA / Cont: 1

| SHB+ | CONS | TYPE | FACT | SQ-FT | VALUE | | |
|------|------|------|------|-------|-------|---|-------|
| 1H | F/C | M | | 252 | | a | *MAIN |
| 1 | F/C | A | | 396 | | b | ADDTN |
| | STP | P | | 16 | 60 | c | PORCH |

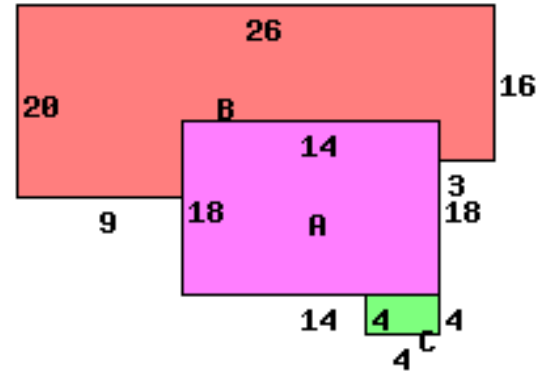

2511 SR 235 45810

| Occupancy 1 Single Family | | *DWELLING COMPUTATIONS | |
|---------------------------|------------|------------------------|-----------------|
| | | Sq-Ft | Value |
| Story Height | 1H | | |
| Floor Level | Main | FRAME | 648 86550 |
| | Part Upper | FRAME | 252 15330 |
| | | | Subtotal 101880 |
| Metal | Roof | GABLE | |
| | B 1 2 U A | | |
| Plaster/Drywall | X X | Extra Features | 60 |
| Floor/Carpet | X X | Total Value | 101940 |
| Number of Rooms | 3 1 | | |
| Bedrooms | 1 | | |
| Central Heat | A | | |
| HOT WATER | | | |
| Plumbing | | | |
| Standard | 1 | | |

| Bldg Type | SHB+Cons | DixHt | Area | Unit | Grade | Blt/Renov | Replace | Phy | Fnc | True |
|------------|----------|-------|------|------|-------|-----------|---------|-----|-----|-------|
| 7 DWELLING | 1H F/C | FtxFt | | Rate | | Cond | Value | Dpr | Dpr | Value |
| | | | 900 | | D- | OLD/AV | 71360 | .55 | | 40780 |

Call Back: - - - - Sign: Date: Lister: 24-160017.0000-v082020R