

LIBERTY TWP
ADA SD

00230

Hardin County, Ohio
Michael T. Bacon, Auditor

24-140023.0000
Q09

RES
2025

sale

Eff Rate:- 46.64 — 40.58 — 40.81 — 41.27 — a/r

2022	MUSSELMAN BRADLEY J &	2016-11-17	
2023	MUSSELMAN BRADLEY J &	2016-11-17	
2024	MUSSELMAN BRADLEY J &	2016-11-17	
2025	MUSSELMAN BRADLEY J & L	2016-11-17	PT N2 N2 NW4 S14 5.062A
	4406 TR 30		1WD
	ADA OH 45810	\$0	

Tax Year	2022	2023	2024	2025	2025	
Prop Cls	511	511	511	511	511	CAMA
Acres	5.0620	5.0620	5.0620	5.0620	5.0620	511
Land100%	22310	41200	41200	41200	41200	41210
Bldg100%	184510	210000	210000	210000	210000	209990
Totl100%	206830t	251200t	251200t	251200t	251200t	251200t
Cauv100%						

Orig Tax Year 1997
Parent: 24-140001.0000

Tax Value:						
Land 35%	7810	14420	14420	14420	14420	14420
Bldg 35%	64580	73500	73500	73500	73500	73500
Totl 35%	72390t	87920t	87920t	87920t	87920t	87920t
Hmstd35%	60360	72870	72870	72870	72870	
Owner Oc	54.52	60.72	60.40	60.32	60.70	hmstd 8750 l 64120 b
Hmstd RB						
Net Tax	3060.54	3213.98	3236.90	3254.54	3274.58	
Sp-Asmnt	24.00	24.00	21.00	24.00		

SHB+	CONS	TYPE	FACT	SQ-FT	VALUE	
1 B	F	M		1447		a *MAIN
	PAT	P		206	620	b PORCH
	F	G		624	14980	c GRAGE
	OFF	F		294	8820	d PORCH

gas fireplace

Sale#	#p	sale date	To	Type/Invalid?	Sale\$	co:land	co:bldg
454	1	2016-11-17	MUSSELMAN BRADLEY J & LYN	1WD *	0	20200	160910
627	1	1998-10-28	MUSSELMAN BRAD J & LYNET	1WD	20000	10740	0
537	1	1996-08-30	RISNER ALAN S & TAMARA K	1SD	19500	0	0

Year	Land	Bldg	Total	Net Tax
2021	7810	64580	72390	3370.56
2020	7810	64580	72390	3421.44

Project	ben acres	/ %	factor
107 GRASS RUN #933 - HOG CREEK			XA/2025
110 HOG CREEK MAINLINE - HOG CR.			XA/2025
500 HARDIN COUNTY LANDFILL			XA/2025
577 OTTAWA RIVER PROJECT MAINT			XA/2021

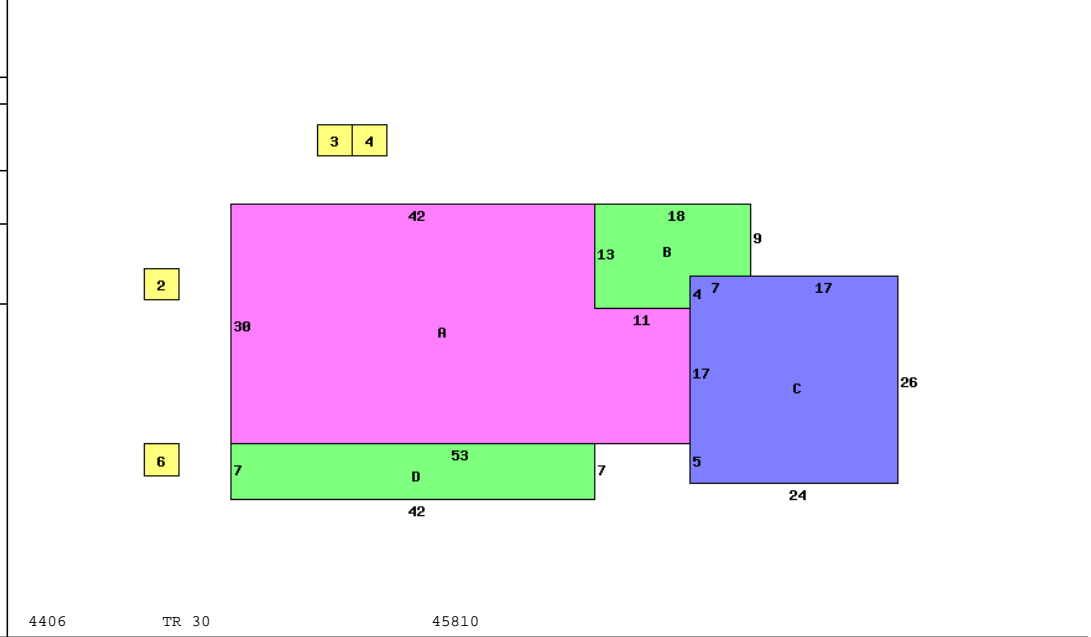

Occupancy 1 Single Family		*DWELLING COMPUTATIONS	
Story Height	1	Sq-Ft	Value
Floor Level	Main	FRAME	1447 114400
	Basement		1447 26780
	Subtotal		141180
Shingle	Roof	GABLE	
	B 1 2 U A		
Plaster/Drywall	D	723 sq ft	Basement Finish 7870
Unfinished Wall	X		Air Conditioning 2530
Floor/Carpet	X		Plumbing 2100
Floor/Concrete	X		Garages and Carports 14980
Floor/Tile-Lino	X		Extra Features 9440
Number of Rooms	1 6		Total Value 178100
Bedrooms	3		
Central Heat	A		PUB ELECTRIC
FORCED AIR			PRIV WATER
Central A/C	A		PRIV SEWER
Plumbing			PUB PAVED ST/RD
Standard	1		Neighborhood:
Extra 3 Fixture	1		Code: 2400
			Dwl/Gar/NC% 1.2700

Bldg Type	SHB+Cons	DixHt	Unit	Blt/Renov	Replace	Phy	Fnc	True
1 DWELLING	1 B F	2170		C	1999GD	178100	.19	183210
2 Shed	*PP	10X14	140		OLD/	0		0
3 Pole Build		24X38	912	C	2007AV	15410	.45	8480 LOFT
4 P	CAN	8X38	304	C	2007AV	2430	.45	1340
5 P	PAT	8X38	304	C	2007AV	910	.45	500
6 Garage		24X30	720	C	2015AV	17280	.25	16460
		acres/	effective	depth	actual	effective	extended	true
homesite		frontage	frontage	depth	rate	rate	value	value
small acreage		1.0000		factor	25000	25000	25000	25000
		4.0620			5000	3990	16210	16210

Call Back: Sign: PSN Date: 2015-08-26 Lister: 24-140023.0000-v082020R