

LIBERTY TWP
ADA SD

00230

Hardin County, Ohio
Michael T. Bacon, Auditor

24-140016.0000
Q08

RES
2025

sale

Eff Rate:- 46.64 — 40.58 — 40.81 — 41.27 — a/r

| | |
|------------------------------|---------------------------------|
| 2022 SHAW JR GEORGE A & KI | 1994-01-28 |
| 2023 SHAW JR GEORGE A & KI | 1994-01-28 |
| 2024 SHAW JR GEORGE A & KI | 1994-01-28 |
| 2025 SHAW JR GEORGE A & KIMB | 1994-01-28 PT NE1/4 NW1/4 5.07A |
| 4470 TR 30 | LSJ |
| ADA OH 45810 | \$119,500 |

| | | | | | | |
|------------|---------|---------|---------|---------|---------|----------------------|
| Tax Year | 2022 | 2023 | 2024 | 2025 | 2025 | CAMA |
| Prop Cls | 511 | 511 | 511 | 511 | 511 | 511 |
| Acres | 5.0700 | 5.0700 | 5.0700 | 5.0700 | 5.0700 | |
| Land100% | 22340 | 41200 | 41200 | 41200 | 41200 | 41200 |
| Bldg100% | 221400 | 281830 | 281830 | 281830 | 281830 | 281820 |
| Totl100% | 243740t | 323030t | 323030t | 323030t | 323030t | 323020t |
| Cauvl00% | | | | | | |
| Tax Value: | | | | | | |
| Land 35% | 7820 | 14420 | 14420 | 14420 | 14420 | 14420 |
| Bldg 35% | 77490 | 98640 | 98640 | 98640 | 98640 | 98640 |
| Totl 35% | 85310t | 113060t | 113060t | 113060t | 113060t | 113060t |
| Hmstd35% | 79080 | 99450 | 99450 | 96090 | 96090 | |
| Owner Oc | 71.42 | 82.88 | 82.44 | 79.54 | 80.04 | hmstd 8750 l 87340 b |
| Hmstd RB | | | | | | |
| Net Tax | 3599.60 | 4128.20 | 4157.70 | 4183.14 | 4208.92 | |
| Sp-Asmnt | 24.00 | 24.00 | 21.00 | 24.00 | | |

| | | | | | | | |
|------|-----|------|------|-------|-------|---|-------|
| SHB+ | CON | TYPE | FACT | SQ-FT | VALUE | a | *MAIN |
| 1H | F/C | M | | 960 | | b | ADDTN |
| 1Q | F/C | A | | 224 | | c | PORCH |
| | RFX | P | | 112 | 1120 | d | GRAGE |
| | F2 | G | | 528 | 12670 | e | PORCH |
| | OFP | P | | 240 | 7200 | f | PORCH |
| | STP | P | | 112 | 450 | g | ADDTN |
| 1 | F | A | | 1152 | | h | PORCH |
| | PAT | P | | 862 | 2590 | | |

| | | | | | | | |
|-------|----|------------|--------------------------|---------------|--------|---------|---------|
| Sale# | #p | sale date | To | Type/Invalid? | Sale\$ | co:land | co:blgd |
| 66 | 1 | 1994-01-28 | SHAW JR GEORGE A & KIMBE | LSJ | 119500 | 0 | 79510 |
| 539 | 2 | 1992-06-11 | | 2WD | 16000 | 6600 | 0 |

| | | | | |
|------|------|-------|-------|---------|
| Year | Land | Bldg | Total | Net Tax |
| 2021 | 7820 | 77490 | 85310 | 3963.54 |
| 2020 | 7820 | 77490 | 85310 | 4023.34 |

project ben acres / % factor

| | | |
|-----|------------------------------|---------|
| 107 | GRASS RUN #933 - HOG CREEK | XA/2025 |
| 110 | HOG CREEK MAINLINE - HOG CR. | XA/2025 |
| 500 | HARDIN COUNTY LANDFILL | XA/2025 |
| 577 | OTTAWA RIVER PROJECT MAINT | XA/2021 |

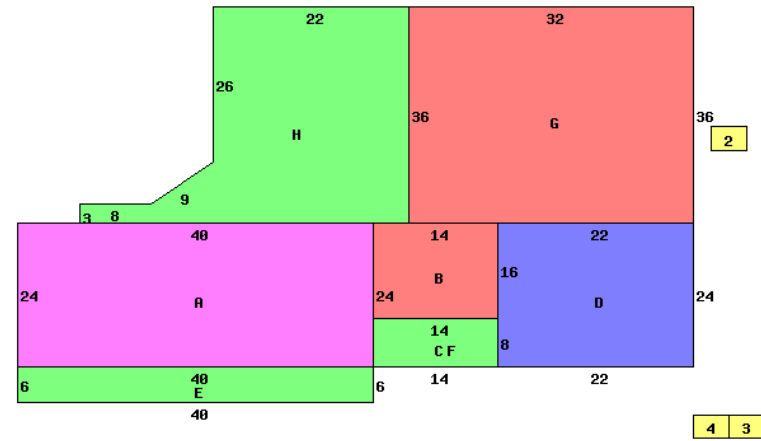

4470 TR 30 45810

| | |
|---------------------------|--------------------------------|
| Occupancy 1 Single Family | *DWELLING COMPUTATIONS |
| Story Height 1H | Sq-Ft Value |
| Floor Level | |
| Main | FRAME 2336 155510 |
| Part Upper | FRAME 960 37400 |
| Qtr Story | FRAME 224 4270 |
| Subtotal | 197180 |
| Shingle | Roof GABLE |
| Plaster/Drywall | X X X Air Conditioning 5690 |
| Floor/Carpet | X X X Plumbing 2100 |
| Floor/Tile-Lino | X X Garages and Carports 12670 |
| Number of Rooms | 6 4 1 Extra Features 11360 |
| Bedrooms | 1 2 Total Value 229000 |
| Heat Pump | A PUB ELECTRIC |
| Central A/C | A PRIV WATER |
| Plumbing | PRIV SEWER |
| Standard | 1 PUB PAVED ST/RD |
| Extra 3 Fixture | 1 |
| Neighborhood: | |
| Code: | 2400 |
| Dwl/Gar/NC% | 1.2700 |

| | | | | | | | | |
|---------------|----------|------------|-------|-----------|-----------|----------|-------|------------------|
| Bldg Type | SHB+Cons | DixHt | Unit | Blt/Renov | Replace | Phy | Fnc | True |
| 1 DWELLING | 1H F/C | 3296 | Rate | Grade | Cond | Value | Dpr | Value |
| 2 Pole Build | | 32X48 1536 | | C | 1994GD | 251900 | .22 | 249530 |
| 3 Pole Build | | 30X44 1320 | | C | 1997AV | 22270 | .55 | 10020 CONCRET FL |
| 4 P | OFP | 20X20 400 | | C | 2017AV | 15840 | .20 | 12670 |
| | | | | | 2017AV | 12000 | .20 | 9600 |
| homesite | acres/ | effective | depth | actual | effective | extended | true | |
| small acreage | frontage | frontage | depth | rate | rate | value | value | |
| | 1.0000 | | | 25000 | 25000 | 25000 | 25000 | |
| | 4.0700 | | | 5000 | 3980 | 16200 | 16200 | |