

LIBERTY TWP  
ADA SD

00230

Hardin County, Ohio  
Michael T. Bacon, Auditor

24-130004.0000  
P15

RES  
2025

sale

Eff Rate:- 46.64 — 40.58 — 40.81 — 41.27 — a/r

|                              |                              |  |  |  |  |
|------------------------------|------------------------------|--|--|--|--|
| 2022 BURRIS KATHRYN L        | 2021-11-03                   |  |  |  |  |
| 2023 WYSS FARMS HOLDING CO   | 2022-10-06                   |  |  |  |  |
| 2024 WYSS FARMS HOLDING CO   | 2022-10-06                   |  |  |  |  |
| 2025 WYSS FARMS HOLDING CO L | 2022-10-06 NE 1/4 S13 7.608A |  |  |  |  |
| 2445 CR 75                   | LWD                          |  |  |  |  |
| ADA OH 45810                 | \$150,000                    |  |  |  |  |

|            |         |         |         |         |         |         |
|------------|---------|---------|---------|---------|---------|---------|
| Tax Year   | 2022    | 2023    | 2024    | 2025    | 2025    | CAMA    |
| Prop Cls   | 511     | 511     | 511     | 511     | 511     | 511     |
| Acres      | 7.6080  | 7.6080  | 7.6080  | 7.6080  | 7.6080  |         |
| Land100%   | 28400   | 49400   | 49400   | 49400   | 49400   | 49410   |
| Bldg100%   | 70910   | 83490   | 83490   | 83490   | 83490   | 83480   |
| Totl100%   | 99310t  | 132890t | 132890t | 132890t | 132890t | 132890t |
| Cauv100%   | 38770   | 38770   | 38770   | 38770   |         |         |
| Tax Value: |         |         |         |         |         |         |
| Land 35%   | 9940    | 17290   | 17290   | 17290   | 17290   | 17290   |
| Bldg 35%   | 24820   | 29220   | 29220   | 29220   | 29220   | 29220   |
| Totl 35%   | 34760t  | 46510t  | 46510t  | 46510t  | 46510t  | 46510t  |
| Hmstd35%   |         |         |         |         |         |         |
| Owner Oc   |         |         |         |         |         |         |
| Hmstd RB   |         |         |         |         |         |         |
| Net Tax    | 1495.78 | 1732.34 | 1744.28 | 1753.58 | 1764.36 |         |
| Sp-Asmnt   | 21.00   | 21.00   | 18.00   | 21.00   |         |         |

|      |      |      |      |       |       |   |       |
|------|------|------|------|-------|-------|---|-------|
| SHB+ | CONS | TYPE | FACT | SQ-FT | VALUE | a | *MAIN |
| 2    | F/C  | M    |      | 640   |       |   |       |
| 1    | F/C  | A    |      | 144   |       |   | ADDTN |
|      | STP  | P    |      | 24    | 100   |   | PORCH |
|      | PAT  | P    |      | 738   | 2210  |   | PORCH |
| 1    | F/C  | A    |      | 132   |       |   | ADDTN |
|      | OFFP | P    |      | 20    | 600   |   | PORCH |

241300220000 2.643A

| Sale# | #p | sale date  | To                        | Type/Invalid? | Sales\$ | co:land | co:bldg |
|-------|----|------------|---------------------------|---------------|---------|---------|---------|
| 522   | 1  | 2022-10-06 | WYSS FARMS HOLDING CO LLC | LWD           | 150000  | 28400   | 70910   |
| 46    | 2  | 2022-01-24 | BURRIS KATHRYN L TRUSTEE  | 2WD *         | 0       | 28400   | 70910   |
| 488   | 2  | 2021-11-03 | BURRIS KATHRYN L          | 2AF *         | 0       | 28400   | 70910   |
| 1094  | 1  | 1993-11-04 | BURRIS DENNIS L & KATHRY  | 1FD           | 224000  | 0       | 272230  |

| Year | Land | Bldg  | Total | Net Tax |
|------|------|-------|-------|---------|
| 2021 | 9940 | 24820 | 34760 | 1649.82 |
| 2020 | 9940 | 24820 | 34760 | 1674.78 |

| project                          | ben acres | / % | factor  |
|----------------------------------|-----------|-----|---------|
| 110 HOG CREEK MAINLINE - HOG CR. |           |     | XA/2025 |
| 500 HARDIN COUNTY LANDFILL       |           |     | XA/2025 |
| 577 OTTAWA RIVER PROJECT MAINT   |           |     | XA/2021 |

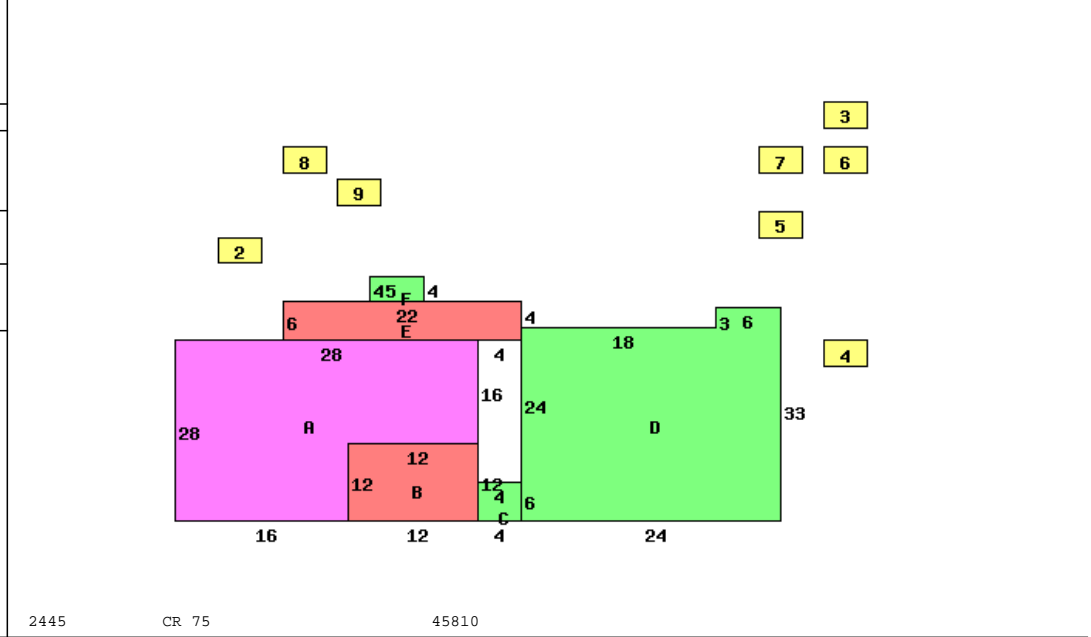

|                           |                        |                 |        |
|---------------------------|------------------------|-----------------|--------|
| Occupancy 1 Single Family | *DWELLING COMPUTATIONS |                 |        |
| Story Height 2            | Sq-Ft                  | Value           |        |
| Floor Level               |                        |                 |        |
|                           | Main                   | FRAME           |        |
|                           | Full Upper             | FRAME           |        |
|                           | Subtotal               | 151640          |        |
| Metal                     | Roof                   | GABLE           |        |
|                           | B 1 2 U A              |                 |        |
| Plaster/Drywall           | P P                    | Fireplaces      | 2000   |
| Floor/Carpet              | X X                    | Extra Features  | 2910   |
| Floor/Tile-Lino           | L L                    | Total Value     | 156550 |
| Number of Rooms           | 3 3                    |                 |        |
| Bedrooms                  | 3                      |                 |        |
| Fireplace                 |                        | PUB ELECTRIC    |        |
| Openings                  | 1                      | PUB GAS         |        |
| Stacks                    | 1                      | PRIV WATER      |        |
| Central Heat              | A                      | PRIV SEWER      |        |
| ELEC-GAS                  |                        | PUB PAVED ST/RD |        |
| Plumbing                  |                        | Neighborhood:   |        |
| Standard                  | 1                      | Code:           | 2400   |
|                           |                        | Dwl/Gar/NC%     | 1.2700 |

|               |          |           |       |           |           |          |       |       |
|---------------|----------|-----------|-------|-----------|-----------|----------|-------|-------|
| Bldg Type     | SHB+Cons | DixHt     | Unit  | Blt/Renov | Replace   | Phy      | Fnc   | True  |
| 1 DWELLING    | 2 F/C    | 1556      |       | C-        | 1920AV    | .55      | Dpr   | 80520 |
| 2 Shed        | *NV      | 6X8       | 0     |           | OLD/FR    | 0        |       | 0     |
| 3 Grain Bin   | *PP      | 36X21     | 756   | C         | 1986AV    | 0        |       | 0     |
| 4 POND        | *.36AC   |           | 0     |           | OLD/      | 0        |       | 0     |
| 5 Quonset     | *SV      | 0 26X60   | 1560  |           | 1965FR    | 1000     |       | 1000  |
| 6 Grain Bin   | *PP      | 24X79     | 1896  | C         | 1984AV    | 0        |       | 0     |
| 7 Grain Bin   | *PP      | 0 16X14   | 224   | C         | 1986AV    | 0        |       | 0     |
| 8 Shed        |          | 10X24     | 240   | D         | 2020AV    | 2300     | .15   | 1960  |
| 9 Shed        | *PP      | 12X12     | 144   |           | 2020AV    | 0        |       | 0     |
| homesite      | acres/   | effective | depth | actual    | effective | extended | true  |       |
| small acreage | frontage | frontage  | depth | rate      | rate      | value    | value |       |
| road          | 1.0000   | 25000     | 5000  | 25000     | 25000     | 25000    | 25000 |       |
| site value    | 6.1880   | 5000      | 3460  | 21410     | 21410     | 21410    | 21410 |       |
|               | .1700    |           |       |           |           | 3000     | 3000  |       |
|               | .2500    |           |       |           |           |          |       |       |

Call Back:

Sign: PSN Date: 2015-08-25 Lister:

24-130004.0000-v082020R