

LIBERTY TWP
ADA SD

00230

Hardin County, Ohio
Michael T. Bacon, Auditor

24-080007.0000
E16

AGR
2025

sale

Eff Rate:- 46.64 — 40.58 — 40.81 — 41.27 — a/r

| | | | |
|------|-------------------------|------------|---------------------|
| 2022 | DUDGEON RODGER D TRUS | 2020-10-16 | |
| 2023 | DUDGEON RODGER D TRUS | 2020-10-16 | |
| 2024 | DUDGEON RODGER D TRUS | 2020-10-16 | |
| 2025 | DUDGEON RODGER D TRUSTE | 2020-10-16 | PT SE1/4 S8 140.00A |
| | 1811 TR 30 | | 1WD |
| | ADA OH 45810 | \$0 | |

| | | | | | | |
|------------|----------|----------|----------|----------|----------|---------------------|
| Tax Year | 2022 | 2023 | 2024 | 2025 | 2025 | |
| Prop Cls | 111 | 111 | 111 | 111 | 111 | CAMA |
| Acres | 140.0000 | 140.0000 | 140.0000 | 140.0000 | 140.0000 | 111 |
| Land100% | 696460 | 772400 | 772400 | 772400 | 772400 | 772400 |
| Bldg100% | 14860 | 19940 | 19940 | 19940 | 19940 | 19930 |
| Totl100% | 711310t | 792340t | 792340t | 792340t | 792340t | 792330t |
| Cauv100% | 150860 | 327140 | 327140 | 327140 | 327140 | 327130 |
| Tax Value: | | | | | | |
| Land 35% | 52800 | 114500 | 114500 | 114500 | 114500 | 270340 |
| Bldg 35% | 5200 | 6980 | 6980 | 6980 | 6980 | 6980 |
| Totl 35% | 58000t | 121480t | 121480t | 121480t | 121480t | 277320t |
| Hmstd35% | 6870 | 11610 | 11610 | 11610 | 11610 | |
| Owner Oc | 6.20 | 9.68 | 9.62 | 9.62 | 9.68 | hmstd 8750 l 2860 b |
| Hmstd RB | | | | | | |
| Net Tax | 2489.62 | 4515.02 | 4546.30 | 4570.54 | 4598.70 | |
| Cauv Sav | 8217.34 | 5804.48 | 5844.52 | 5875.64 | 5875.64 | |
| Sp-Asmnt | 38.25 | 38.25 | 18.00 | 58.52 | 58.52 | |

| | | | | | | | |
|------|------|------|------|-------|-------|---|-------|
| SHB+ | CONS | TYPE | FACT | SQ-FT | VALUE | a | *MAIN |
| 2 B | F | M | | 640 | | b | ADDTN |
| 1 | F/C | A | | 339 | | c | PORCH |
| | BAY | P | | 24 | 910 | d | PORCH |
| | DK | P | | 237 | 3560 | e | PORCH |
| | EFP | P | | 60 | 2400 | f | PORCH |
| | STP | P | | 24 | 100 | | |

| Sale# | #p | sale date | To | Type/Invalid? | Sale\$ | co:land | co:bldg |
|-------|----|------------|--------------------------|---------------|--------|---------|---------|
| 412 | 1 | 2020-10-16 | DUDGEON RODGER D TRUSTEE | 1WD * | 0 | 695860 | 14060 |
| 332 | 1 | 2020-08-21 | DUDGEON MICHAEL D | 1CT * | 0 | 695860 | 14060 |
| 33 | 1 | 2001-01-18 | DUDGEON MICHAEL D & LIND | 1WD | 280000 | 191400 | 29260 |
| 419 | 2 | 2000-10-10 | LAMAN LINDA S & JAMES W | 2CT * | 0 | 191400 | 29260 |

| Year | Land | Bldg | Total | Net Tax |
|------|-------|------|-------|---------|
| 2021 | 52800 | 5200 | 58000 | 2745.40 |
| 2020 | 52800 | 5200 | 58000 | 2786.96 |

| project | ben acres | % | factor |
|----------------------------------|-----------|---|---------|
| 110 HOG CREEK MAINLINE - HOG CR. | | | XA/2025 |
| 500 HARDIN COUNTY LANDFILL | | | XA/2025 |
| 577 OTTAWA RIVER PROJECT MAINT | | | XA/2021 |

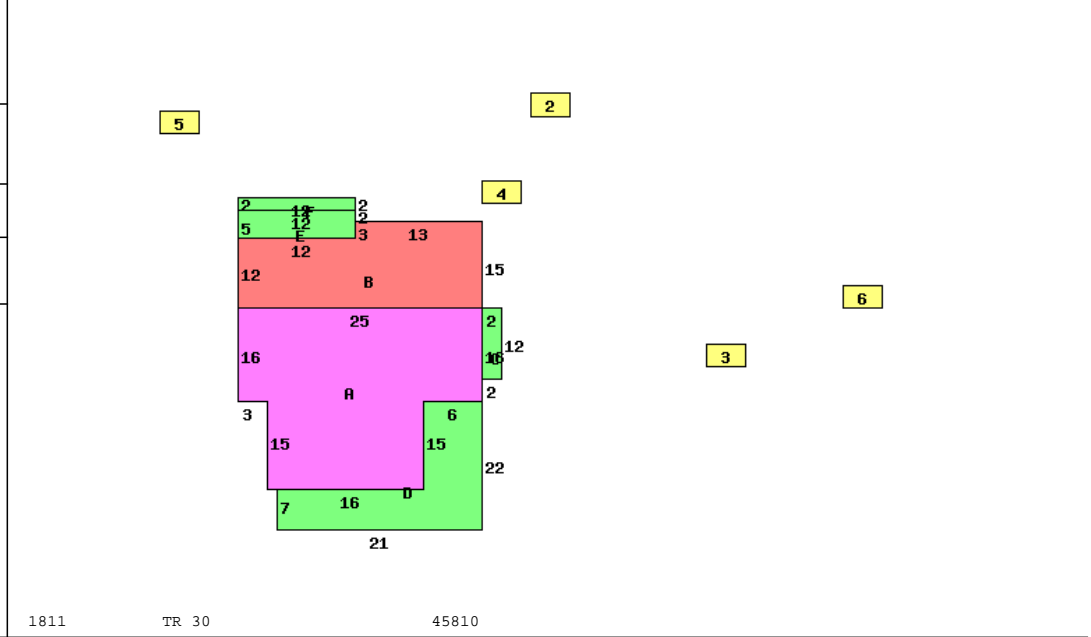

1811 TR 30 45810

| Occupancy | 1 Single Family | *DWELLING COMPUTATIONS |
|--------------|-----------------|------------------------|
| Story Height | 2 | Sq-Ft Value |
| Floor Level | Main | FRAME 979 102780 |
| | Full Upper | FRAME 640 51320 |
| | Basement | 320 6220 |
| | Subtotal | 160320 |
| Slate | Roof | GABLE |
| | B 1 2 U A | |

| | | | |
|-----------------|-------|----------------|--------|
| Plaster/Drywall | X X | Heating | -810 |
| Floor/Pine | X X | Plumbing | 700 |
| Number of Rooms | 1 4 3 | Extra Features | 6970 |
| Bedrooms | 3 | Total Value | 167180 |
| Central Heat | X | | |
| FORCED AIR | | Neighborhood: | |
| Plumbing | | Code: | 2400 |
| Standard | 1 | Dwl/Gar/NC% | 1.2700 |
| Extra Fixture | 1 | | |

| Bldg Type | SHB+Cons | DixHt | Area | Unit Rate | Grade | Blt/Renov | Cond | Replace Value | Phy Dpr | Fnc Dpr | True Value |
|--------------|----------|-------|------|-----------|-------|-----------|------|---------------|---------|---------|------------|
| 1 DWELLING | 2 B F | 1619 | | | C | OLD/VP | | 167180 | .85 | .75 | 7960 |
| 2 Flat Barn | | 30X60 | 1800 | | D | OLD/VP | | 17280 | .80 | .50 | 1730 |
| 3 Grain Bin | *PP | 16X18 | 0 | | C | 1972FR | | 0 | | | 0 |
| 4 Garage | *SV 0 | 12X20 | 240 | | | OLD/PR | | 200 | | | 200 |
| 5 Pole Build | | 30X48 | 1440 | | C | 1967PR | | 13820 | .75 | | 3460 |
| 6 Hog House | | 26X90 | 2340 | | C | 1972PR | | 35100 | .75 | .25 | 6580 |

| Tab # | S O I L | Acres | Mkt/Ac | Market | Au/Ac | Cauv |
|-------|--------------------------|---------|--------|--------|-------|--------|
| C 1 | BOA BLOUNT SILT LOAM 0- | 1.3601 | 6030 | 8200 | 2660 | 3620 |
| C 2 | BOB BLOUNT SILT LOAM, 2 | 58.6024 | 5770 | 338140 | 2360 | 138300 |
| C 14 | GWB GLYNWOOD SILT LOAM | 26.3028 | 5400 | 142040 | 1750 | 46030 |
| C 30 | MRD2 MORLEY CLAY LOAM 12 | 3.7475 | 4670 | 17500 | 350 | 1310 |
| C 39 | PM PEWAMO SILTY CLAY L | 3.9389 | 6490 | 25560 | 3560 | 14020 |
| C 47 | SO SLOAN SILT LOAM, FR | 16.0535 | 6490 | 104190 | 2920 | 46880 |
| C 51 | WSTL WASTE LAND | 8.4000 | 120 | 1010 | 50 | 420 |
| C 52 | PKA PEWAMO SICL 0-1% SL | 12.6627 | 6490 | 82180 | 3560 | 45080 |
| W 2 | BOB BLOUNT SILT LOAM, 2 | 2.4956 | 3130 | 7810 | 470 | 1170 |
| W 14 | GWB GLYNWOOD SILT LOAM | 1.0659 | 2830 | 3020 | 750 | 800 |
| W 30 | MRD2 MORLEY CLAY LOAM 12 | .0497 | 420 | 20 | 230 | 10 |
| W 47 | SO SLOAN SILT LOAM, FR | 2.6323 | 4560 | 12000 | 1030 | 2710 |
| W 52 | PKA PEWAMO SICL 0-1% SL | 1.0664 | 5370 | 5730 | 1670 | 1780 |
| 672 | HSITE HOMESITE | 1.0000 | 25000 | 25000 | 25000 | 25000 |
| 980 | ROAD ROAD | .6222 | | | | |

140 772400 (100%) 327130 CAUV # 4378
270340 (35%) 114500