

JACKSON TWP
FOREST CORP

00220

Hardin County, Ohio
Michael T. Bacon, Auditor

23-190031.0000
H15

RES
2025

sale

Eff Rate:- 40.15 — 34.89 — 35.26 — 35.21 — a/r

2022	MOWERY KENNETH & KARE				
2023	MOWERY KENNETH & KARE				
2024	MOWERY KENNETH & KARE				
2025	MOWERY KENNETH & KAREN				
	310 WELLS ROAD				
	FOREST OH 45843				
				\$0	

Tax Year	2022	2023	2024	2025	CAMA
Prop Cls	510	510	510	510	510
Acres					
Land100%	11170	12140	12140	12140	12130
Bldg100%	106690	131230	131230	131230	131240
Totl100%	117860t	143370t	143370t	143370t	143370t
Cauv100%					
Tax Value:					
Land 35%	3910	4250	4250	4250	4250
Bldg 35%	37340	45930	45930	45930	45930
Totl 35%	41250t	50180t	50180t	50180t	50180t
Hmstd35%					
Owner Oc	35.80	38.74	38.68	38.62	
Hmstd RB					
Net Tax	1477.12	1557.00	1576.12	1573.82	
Sp-Asmnt	18.00	22.00	18.00	18.00	

SHB+	CONS	TYPE	FACT	SQ-FT	VALUE	a	*MAIN
1	F/C	M		1144			ADDTN
1	F/C	A		320			PORCH
	DK	P		160	2400		GRAGE
	F2	G		520	12480		ADDTN
1	F/C	A		288			PORCH
	OFFP	P		132	3960		PORCH
	CAN	P		160	1280		PORCH
	DK	P		754	11310		PORCH

Year	Land	Bldg	Total	Net Tax
2021	3910	37340	41250	1602.90
2020	3910	37340	41250	1606.50

project	ben acres	/ %	factor
921 BLANCHARD RIVER MAINT			
500 HARDIN COUNTY LANDFILL			

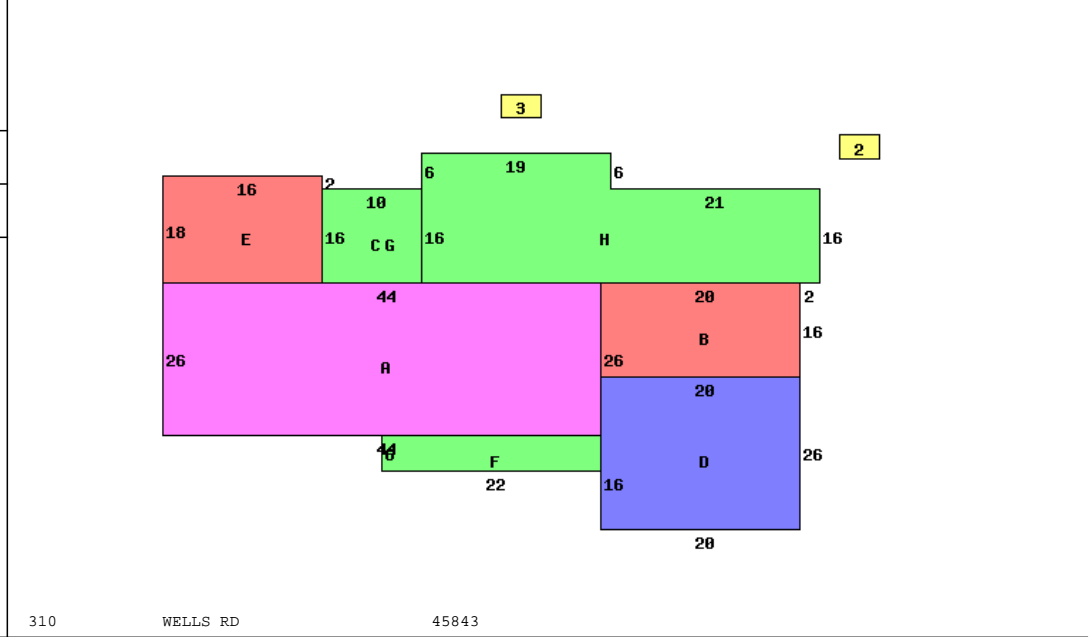

310 WELLS RD 45843

Occupancy 1 Single Family		*DWELLING COMPUTATIONS	
Story Height	1	Sq-Ft	Value
Floor Level	Main	FRAME	1752 127880
	Subtotal		127880
Shingle	Roof	GABLE	
Plaster/Drywall	X	Air Conditioning	3050
Floor/Carpet	X	Plumbing	2100
Floor/Tile-Lino	L	Garages and Carports	12480
Number of Rooms	8	Extra Features	18950
Bedrooms	4	Total Value	164460
Central Heat	A	PUB PAVED ST/RD	
FORCED AIR			
Central A/C	A	Neighborhood:	
Plumbing		Code:	2300
Standard	1	Dwl/Gar/NC%	1.0500
Extra 3 Fixture	1		

Bldg Type	SHB+Cons	DixHt	Unit	Blt/Renov	Replace	Phy	Fnc	True
1 DWELLING	1 F/C	Area	Rate	Cond	Value	Dpr	Dpr	Value
2 Shed	*PP	8X10	80	OLD/	0			0
3 Pool	*PP		0	2019AV	0			0
front lot	acres/	effective	depth	depth	effective	extended	true	
	frontage	frontage	factor	actual	rate	value	value	
		125.00	335	121	80	97	12130	12130

Call Back: Sign: PSN Date: 2018-06-29 Lister: 23-190031.0000-v082020R