

JACKSON TWP  
FOREST CORP

00220

Hardin County, Ohio  
Michael T. Bacon, Auditor

23-050015.0000  
E64

RES  
2025

sale

Eff Rate:- 40.15 — 34.89 — 35.26 — 35.21 — a/r

2022 LAWRENCE VIRGINIA I	1987-05-01	
2023 LAWRENCE VIRGINIA I	1987-05-01	
2024 LAWRENCE VIRGINIA I	1987-05-01	
2025 LAWRENCE VIRGINIA I	1987-05-01	CAMPBELLS 3RD OL 31 & OL
414 S CAMPBELL ST		34 .834A
FOREST OH 45843	\$9,000	

Tax Year	2022	2023	2024	2025	CAMA
Prop Cls	511	511	511	511	511
Acres	.8340	.8340	.8340	.8340	
Land100%	13030	14030	14030	14030	14030
Bldg100%	70540	95230	95230	95230	95240
Totl100%	83570t	109260t	109260t	109260t	109270t
Cauvl00%					
Tax Value:					
Land 35%	4560	4910	4910	4910	4910
Bldg 35%	24690	33330	33330	33330	33330
Totl 35%	29250t	38240t	38240t	38240t	38240t
Hmstd35%					
Owner Oc	25.38	29.52	29.48	29.42	
Hmstd RB	313.34	284.54	307.78	318.32	
Net Tax	734.08	901.98	893.30	881.02	
Sp-Asmnt	18.00	26.00	18.00	18.00	

SHB+	CONS	TYPE	FACT	SQ-FT	VALUE	a	*MAIN
1	F/C	M		946		b	PORCH
	RFX	P		216	2160	c	GRAGE
	F2	G		768	18430	d	PORCH
	PAT	P		136	410	e	PORCH
	DK	P		374	5610	f	PORCH
	STP	P		60	240		

#: 20 L/W  
230500200000

Sale#	#p	sale date	To	Type/Invalid?	Sale\$	co:land	co:bldg
324	0	1987-05-01		*	9000	0	8910
304	0	1987-04-24		*	0	0	8910

Year	Land	Bldg	Total	Net Tax
2021	4560	24690	29250	796.62
2020	4560	24690	29250	798.36

project	ben acres	%	factor
921 BLANCHARD RIVER MAINT			XA/2023
500 HARDIN COUNTY LANDFILL			XA/2025

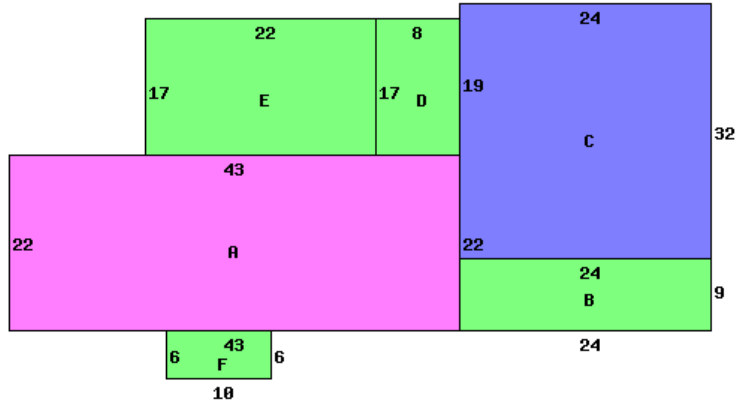

414 S CAMPBELL ST 45843

Occupancy 1 Single Family	*DWELLING COMPUTATIONS
Story Height 1	Sq-Ft Value
Floor Level	946 103610
Metal	103610
Plaster/Drywall	X
Floor/Carpet	X
Number of Rooms	7
Bedrooms	3
Fireplace	
Openings	1
Stacks	1
Central Heat	A
FORCED AIR	
Central A/C	A
Plumbing	
Standard	1
Extra 3 Fixture	1
Fireplaces	2000
Air Conditioning	1630
Plumbing	2100
Garages and Carports	18430
Extra Features	8420
Total Value	136190
PUB PAVED ST/RD	
Neighborhood:	
Code:	2300
Dwl/Gar/NC%	1.0500

Bldg Type	SHB+Cons	DixHt	Unit	Blt/Renov	Replace	Phy	Fnc	True
1 DWELLING	1 F/C			C-	1988AV	122570	.26	95240
front lot	effective	depth	depth	actual	effective	extended	true	
	204.00	178	108	80	86	17540	14030	Shape / Si

Call Back:

Sign: MJT Date: 2010-05-14 Lister:

23-050015.0000-v082020R