

JACKSON TWP
FOREST CORP

00220

Hardin County, Ohio
Michael T. Bacon, Auditor

23-010045.0000
E31

RES
2025

sale

Eff Rate:- 40.15 — 34.89 — 35.26 — 35.21 — a/r

2022 KISSLING CARLTON TRUS	2010-01-22	
2023 KISSLING CARLTON TRUS	2010-01-22	
2024 KISSLING CARLTON TRUS	2010-01-22	
2025 KISSLING CARLTON TRUSTE	2010-01-22	CAMPBELLS 2ND OL 20 PT
616 W DIXON ST	1WD	
FOREST OH 45843	\$0	

Tax Year	2022	2023	2024	2025	CAMA
Prop Cls	510	510	510	510	510
Acres	8090	8800	8800	8800	8800
Land100%	50740	52260	52260	52260	52250
Bldg100%	58830t	61060t	61060t	61060t	61050t
Totl100%					
Cauv100%					
Tax Value:					
Land 35%	2830	3080	3080	3080	3080
Bldg 35%	17760	18290	18290	18290	18290
Totl 35%	20590t	21370t	21370t	21370t	21370t
Hmstd35%					
Owner Oc	17.88	16.50	16.48	16.44	
Hmstd RB					
Net Tax	737.32	663.08	671.22	670.24	
Sp-Asmnt	18.00	22.00	18.00	18.00	

SHB+	CONS	TYPE	FACT	SQ-FT	VALUE	a	*MAIN
1	F/C	M		592			ADDTN
1H	F/C	A		240			PORCH
	OFF	P		150	4500		PORCH
	RFK	P		40	400		GRAGE
	F3	G		936	22460		PORCH
	DK	P		80	1200		

Sale#	#p	sale date	To	Type/Invalid?	Sale\$	co:land	co:blgd
30	1	2010-01-22	KISSLING CARLTON TRUSTEE	1WD *	0	8060	47260
Year	Land	Bldg	Total	Net Tax			
2021	2830	17760	20590	800.10			
2020	2830	17760	20590	801.90			

project
921 BLANCHARD RIVER MAINT XA/2023
500 HARDIN COUNTY LANDFILL XA/2025
ben acres / % factor

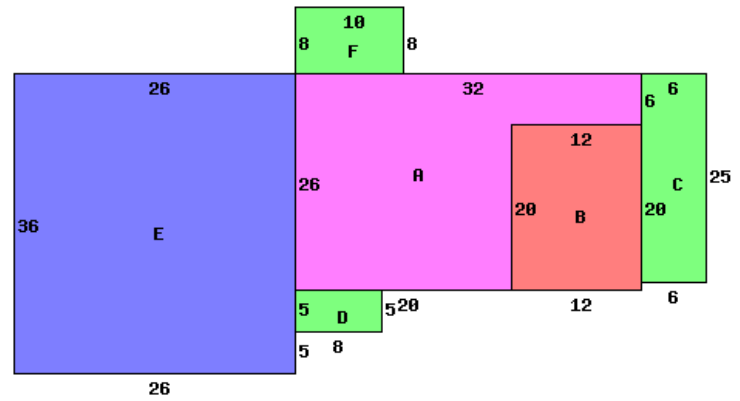

616 W DIXON ST 45843

Occupancy 1 Single Family	*DWELLING COMPUTATIONS	Sq-Ft	Value
Story Height 2	Main	FRAME	832 98580
Floor Level	Part Upper	FRAME	240 15030
	Subtotal		113610
Shingle	Roof	GABLE	
Panelled Wall	X X	Garages and Carports	22460
Floor/Pine	X X	Extra Features	6100
Floor/Carpet	X X	Total Value	142170
Number of Rooms	4 2		
Bedrooms	1 2	PUB PAVED ST/RD	
Central Heat	A	Neighborhood:	
FORCED AIR		Code:	2300
Plumbing		Dwl/Gar/NC%	1.0500
Standard	1		

Bldg Type	SHB+Cons	DixHt	Unit	Blt/Renov	Replace	Phy Fnc	True
1 DWELLING	1 F/C	FtxFt	Area	Grade	Value	Dpr Dpr	Value
		1072	1072	C	142170	.65	52250
	acres/	effective	depth	depth	effective	extended	true
front lot	frontage	frontage	factor	rate	rate	value	value
	100.0000	100.00	185	110	80	8800	8800