

JACKSON TWP
FOREST CORP

00220

Hardin County, Ohio
Michael T. Bacon, Auditor

23-010034.0000
E26

RES
2025

sale

Eff Rate:- 40.15 — 34.89 — 35.26 — 35.21 — a/r

2022 HECKATHORN RUTH B	2001-06-05	
2023 HECKATHORN RUTH B	2001-06-05	
2024 HECKATHORN RUTH B	2001-06-05	
2025 HECKATHORN RUTH B	2001-06-05	CAMPBELLS 2ND PT OL 24
615 W GAGE ST	ITD	.476A
FOREST OH 45843	\$0	

Tax Year	2022	2023	2024	2025	CAMA
Prop Cls	510	510	510	510	510
Acres	.4800	.4760	.4760	.4760	
Land100%	8400	9110	9110	9110	9100
Bldg100%	66540	76570	76570	76570	76570
Totl100%	74940t	85690t	85690t	85690t	85670t
Cauv100%					

2027 TILTON BRAD & LORI A	2026-02-02	
615 W GAGE ST	LWD	
FOREST OH 45843		

Tax Value:					
Land 35%	2940	3190	3190	3190	3190
Bldg 35%	23290	26800	26800	26800	26800
Totl 35%	26230t	29990t	29990t	29990t	29980t
Hmstd35%	24970	28320	28320	28320	
Owner Oc	21.68	21.86	21.84	21.80	hmstd 3190 l 25130 b
Hmstd RB	313.34	284.54	307.78	318.32	
Net Tax	627.02	647.30	635.44	623.54	
Sp-Asmnt	18.00	22.00	18.00	18.00	

SHB+	CONS	TYPE	FACT	SQ-FT	VALUE	a	*MAIN
1	F/C	M		1188			
	STP	P		36	140	b	PORCH
	F	G		360	8640	c	GRAGE
	DK	F		192	2880	d	PORCH

Sale#	#p	sale date	To	Type/Invalid?	Sale\$	co:land	co:bldg
33	1	2026-02-02	TILTON BRAD & LORI A	LWD	124000	9110	76570
67	1	2026-02-02	HECKATHORN RONALD L ETAL	1AF *	0	9110	76570
233	1	2001-06-05	HECKATHORN RUTH B	1TD *	0	6110	53740
341	0	1987-05-05		*	0	0	39400

Year	Land	Bldg	Total	Net Tax
2021	2940	23290	26230	680.46
2020	2940	23290	26230	681.96

Project
921 BLANCHARD RIVER MAINT XA/2023
500 HARDIN COUNTY LANDFILL XA/2025

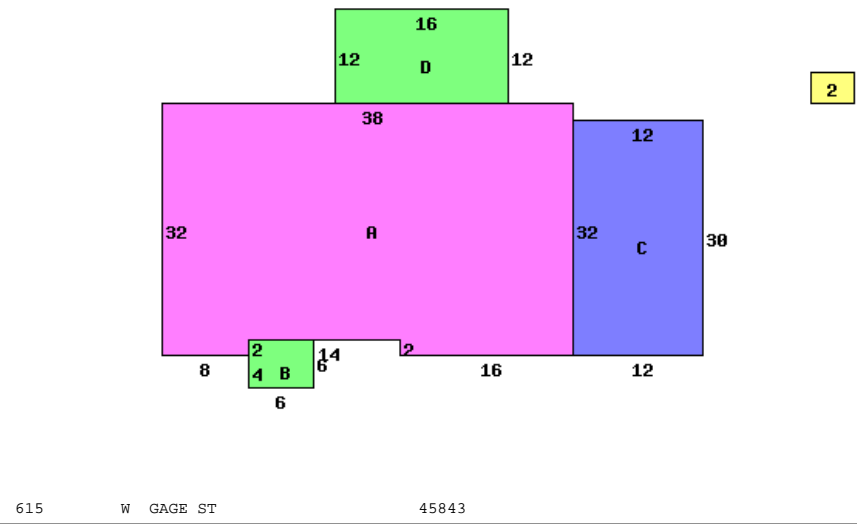

Occupancy 1 Single Family	*DWELLING COMPUTATIONS	
Story Height 1	Sq-Ft	Value
Floor Level	1188	105250
Shingle	Main Subtotal	105250
	Roof	
Plaster/Drywall	X	Garages and Carports 8640
Floor/Pine	X	Extra Features 3020
Floor/Carpet	X	Total Value 116910
Number of Rooms	5	
Bedrooms	2	PUB PAVED ST/RD
Central Heat	A	Neighborhood:
ELECTRIC		Code: 2300
Plumbing		Dwl/Gar/NC% 1.0500
Standard	1	

Bldg Type	SHB+Cons	DixHt	Unit	Blt/Renov	Replace	Phy	Fnc	True
1 DWELLING	1 F/C	18X30	540	C-	1976AV	.35	Dpr	71810
2 Garage				C	1979AV	.65	Dpr	4760
front lot	100.0000	100.00	207	114	80	91	9100	9100