

JACKSON TWP  
RIVERDALE SD

00190

Hardin County, Ohio  
Michael T. Bacon, Auditor

20-150005.0000  
L69

RES  
2025

sale

Eff Rate:- 38.35 — 33.09 — 33.46 — 33.41 — a/r

|      |                         |            |                        |  |  |
|------|-------------------------|------------|------------------------|--|--|
| 2022 | GOODBAR GREGORY & STO   | 2007-08-30 |                        |  |  |
| 2023 | GOODBAR GREGORY & STO   | 2007-08-30 |                        |  |  |
| 2024 | GOODBAR GREGORY & STO   | 2007-08-30 |                        |  |  |
| 2025 | GOODBAR GREGORY & STORM | 2007-08-30 | PT S1/2 NE1/4 NW1/4 S7 |  |  |
|      | 18689 TR 22             |            | 1QC 11.515A            |  |  |
|      | FOREST OH 45843         | \$0        |                        |  |  |

|            |         |         |         |         |         |
|------------|---------|---------|---------|---------|---------|
| Tax Year   | 2022    | 2023    | 2024    | 2025    | CAMA    |
| Prop Cls   | 512     | 512     | 512     | 512     | 512     |
| Acres      | 11.5200 | 11.5150 | 11.5150 | 11.5150 |         |
| Land100%   | 27510   | 39910   | 39910   | 39910   | 39920   |
| Bldg100%   | 126630  | 143170  | 143170  | 143170  | 143170  |
| Totl100%   | 154140t | 183090t | 183090t | 183090t | 183090t |
| Cauv100%   |         |         |         |         |         |
| Tax Value: |         |         |         |         |         |
| Land 35%   | 9630    | 13970   | 13970   | 13970   | 13970   |
| Bldg 35%   | 44320   | 50110   | 50110   | 50110   | 50110   |
| Totl 35%   | 53950t  | 64080t  | 64080t  | 64080t  | 64080t  |
| Hmstd35%   | 46630   | 52520   | 52520   | 52520   |         |
| Owner Oc   | 38.38   | 38.18   | 38.12   | 38.06   |         |
| Hmstd RB   |         |         |         |         |         |
| Net Tax    | 1852.96 | 1895.78 | 1920.16 | 1917.22 |         |
| Sp-Asmnt   | 18.00   | 26.00   | 18.00   | 18.00   |         |

|      |      |      |      |       |       |   |       |
|------|------|------|------|-------|-------|---|-------|
| SHB+ | CONS | TYPE | FACT | SQ-FT | VALUE |   |       |
| 1    | F/C  | M    |      | 1584  |       | a | *MAIN |
|      | OPF  | P    |      | 24    | 720   | b | PORCH |
|      | F2   | G    |      | 480   | 11520 | c | GRAGE |
|      | PAT  | P    |      | 192   | 580   | d | PORCH |

#: 060, L/W  
201500600000 .18a

| Sale# | #p | sale date  | To                       | Type/Invalid? | Sale\$ | co:land | co:blgd |
|-------|----|------------|--------------------------|---------------|--------|---------|---------|
| 334   | 1  | 2007-08-30 | GOODBAR GREGORY & STORMY | 1QC *         | 0      | 24860   | 110710  |
| 625   | 1  | 1999-11-15 | GOODBAR STORMY B         | 1AF *         | 0      | 23060   | 92600   |
| 348   | 1  | 1997-08-26 | PETERS BILLY JO          |               | 0      | 13860   | 35060   |
| 349   | 1  | 1997-08-26 | PETERS BILLY JO & STORMY | 1WD *         | 0      | 13860   | 35060   |
| 305   | 1  | 1997-08-05 | PETERS BILLY JO & STORMY | 1 *           | 0      | 13860   | 35060   |
| 444   | 1  | 1997-08-04 | PETERS BILLY JO          | 1WD *         | 108500 | 13860   | 35060   |
| 1224  | 1  | 1995-12-13 | CONOVER BRADLEY E        | 1QC *         | 0      | 13860   | 29030   |
| 92    | 1  | 1994-02-04 | CONOVER BRADLEY E & LYNN | 1WD *         | 10000  | 0       | 0       |

| Year | Land | Bldg  | Total | Net Tax |
|------|------|-------|-------|---------|
| 2021 | 9630 | 44320 | 53950 | 2018.08 |
| 2020 | 9630 | 44320 | 53950 | 2022.84 |

| Project                    | ben acres | / % | factor  |
|----------------------------|-----------|-----|---------|
| 921 BLANCHARD RIVER MAINT  |           |     | XA/2023 |
| 500 HARDIN COUNTY LANDFILL |           |     | XA/2025 |

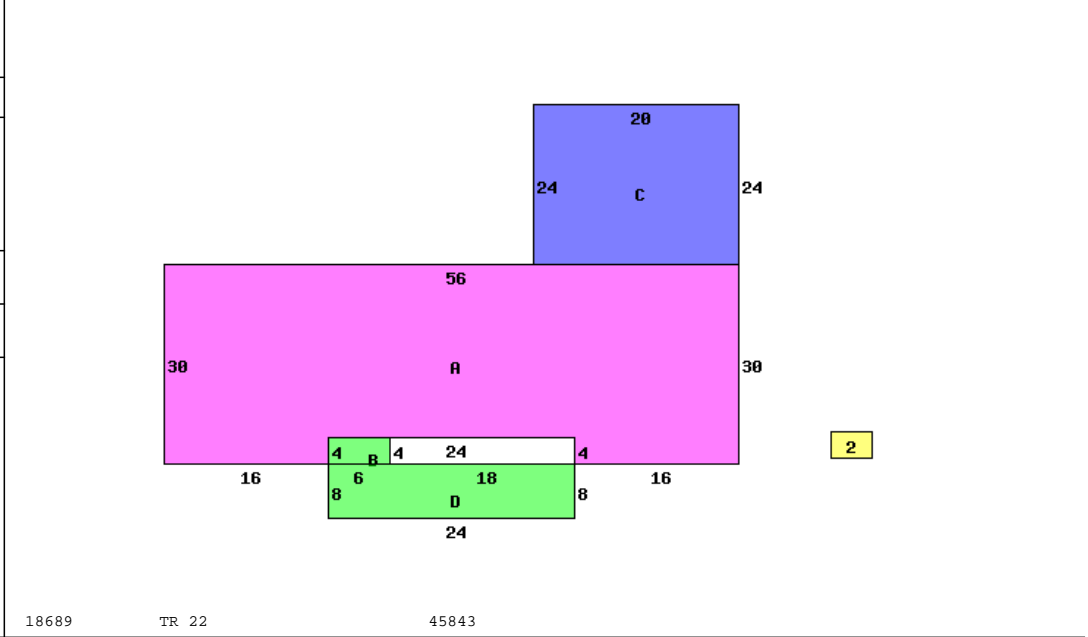

18689 TR 22 45843

|                 |                 |                            |
|-----------------|-----------------|----------------------------|
| Occupancy       | 1 Single Family | *DWELLING COMPUTATIONS     |
| Story Height    | 1               | Sq-Ft Value                |
| Floor Level     | Main            | FRAME 1584 124460          |
| Shingle         | Subtotal        | 124460                     |
|                 | Roof            | HIP                        |
| Plaster/Drywall | D               | Air Conditioning 2800      |
| Floor/Carpet    | X               | Plumbing 2100              |
| Number of Rooms | 6               | Garages and Carports 11520 |
| Bedrooms        | 3               | Extra Features 1300        |
| Central Heat    | A               | Total Value 142180         |
| Central A/C     | A               | PUB ELECTRIC               |
| Plumbing        |                 | PRIV WATER                 |
| Standard        | 1               | PRIV SEWER                 |
| Extra 3 Fixture | 1               | PUB PAVED ST/RD            |
|                 |                 | Neighborhood:              |
|                 |                 | Code: 2000                 |
|                 |                 | Dwl/Gar/NC% 1.2500         |

| Bldg Type     | SHB+Cons | DixHt     | Area     | Unit   | Grade     | Blt/Renov | Replace | Phy | Fnc | True   |
|---------------|----------|-----------|----------|--------|-----------|-----------|---------|-----|-----|--------|
| 1 DWELLING    | 1 F      | 1584      | 1584     |        | C         | 1994AV    | 142180  | .24 |     | 135070 |
| 2 Pole Build  |          | 30X50     | 1500     |        | C         | 1998AV    | 18000   | .55 |     | 8100   |
| homesite      |          | effective | depth    | actual | effective | extended  | true    |     |     |        |
| small acreage | 10.5150  | frontage  | frontage | rate   | rate      | value     | value   |     |     |        |
|               |          | 1.0000    | 1500     | 15000  | 15000     | 15000     | 15000   |     |     |        |
|               |          | 10.5150   | 5000     | 2370   | 24920     | 24920     | 24920   |     |     |        |