

JACKSON TWP
RIVERDALE SD

00190

Hardin County, Ohio
Michael T. Bacon, Auditor

20-010020.0000
E18

RES
2025

sale

Eff Rate:- 38.35 — 33.09 — 33.46 — 33.41 — a/r

| | |
|-----------------------------|----------------------------------|
| 2022 BROWN LONNIE L & RENE | 2004-02-18 |
| 2023 BROWN LONNIE L & RENE | 2004-02-18 |
| 2024 BROWN LONNIE L & RENE | 2004-02-18 |
| 2025 BROWN LONNIE L & RENEE | 2004-02-18 S 1/2 NE 1/4 S1 1.00A |
| 0481 TR 195 | 1WD |
| FOREST OH 45843 | \$120,000 |

| | | | | | | |
|------------|---------|---------|---------|---------|---------|----------------------|
| Tax Year | 2022 | 2023 | 2024 | 2025 | 2025 | CAMA |
| Prop Cls | 511 | 511 | 511 | 511 | 511 | 511 |
| Acres | 1.0000 | 1.0000 | 1.0000 | 1.0000 | 1.0000 | 15000 |
| Land100% | 12600 | 15000 | 15000 | 15000 | 15000 | 175670 |
| Bldg100% | 148290 | 175660 | 175660 | 175660 | 175660 | 190670t |
| Totl100% | 160890t | 190660t | 190660t | 190660t | 190660t | |
| Cauvl00% | | | | | | |
| Tax Value: | | | | | | |
| Land 35% | 4410 | 5250 | 5250 | 5250 | 5250 | 5250 |
| Bldg 35% | 51900 | 61480 | 61480 | 61480 | 61480 | 61480 |
| Totl 35% | 56310t | 66730t | 66730t | 66730t | 66730t | 66730t |
| Hmstd35% | 55130 | 64280 | 64280 | 63930 | 63930 | |
| Owner Oc | 45.38 | 46.72 | 46.66 | 46.32 | 46.32 | hmstd 5250 l 58680 b |
| Hmstd RB | | | | | | |
| Net Tax | 1928.68 | 1967.20 | 1992.60 | 1989.82 | 1989.82 | |
| Sp-Asmnt | 18.00 | 22.00 | 18.00 | 18.00 | | |

| | | | | | | |
|----------|--------|--------|--------|------------|-------------|---------|
| SHB+ 1 B | CONS F | TYPE M | FACT G | SQ-FT 1576 | VALUE 16130 | a *MAIN |
| | F2 | G | | 672 | 16130 | b GRAGE |
| | STP | P | | 60 | 240 | c PORCH |
| | BAY | P | | 16 | 610 | d PORCH |
| | BAY | P | | 12 | 460 | e PORCH |
| | PAT | P | | 240 | 720 | f PORCH |
| | EFP | P | | 256 | 10240 | g PORCH |

gas fireplace

| | | | | | | | | |
|-----------|-----------|----------------------|---------------------------|-----------------|-----|---------------|--------------|---------------|
| Sale# 82 | #p 1 | sale date 2004-02-18 | To BROWN LONNIE L & RENEE | Type/Invalid? E | 1WD | Sale\$ 120000 | co:land 8000 | co:blgd 88200 |
| Year 2021 | Land 4410 | Bldg 51900 | Total 56310 | Net Tax 2100.48 | | | | |
| 2020 | 4410 | 51900 | 56310 | 2105.40 | | | | |

project 921 BLANCHARD RIVER MAINT
500 HARDIN COUNTY LANDFILL

ben acres / % factor
XA/2023
XA/2025

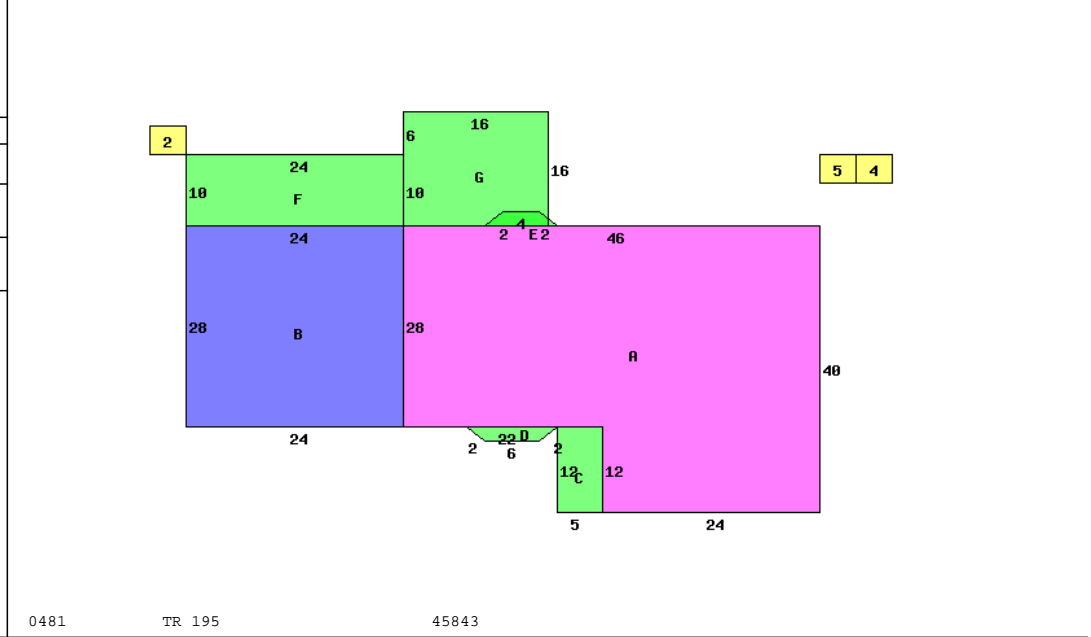

| | | |
|---------------------------|------------------------|----------------------------|
| Occupancy 1 Single Family | *DWELLING COMPUTATIONS | |
| Story Height 1 | Sq-Ft | Value |
| Floor Level | | |
| Main | FRAME | 1576 123830 |
| Basement | | 1576 29160 |
| Subtotal | | 152990 |
| Metal Roof | GABLE | |
| B 1 2 U A | | |
| Plaster/Drywall | X | Air Conditioning 2790 |
| Unfinished Wall | X | Plumbing 2100 |
| Floor/Carpet | X | Garages and Carports 16130 |
| Floor/Concrete | X | Extra Features 12270 |
| Number of Rooms | 1 5 | Total Value 186280 |
| Bedrooms | 3 | |
| Central Heat | A | PUB ELECTRIC |
| ELECTRIC | | PRIV WATER |
| Central A/C | A | PRIV SEWER |
| Plumbing | | PUB PAVED ST/RD |
| Standard | 1 | Neighborhood: |
| Extra 3 Fixture | 1 | Code: 2000 |
| | | Dwl/Gar/NC% 1.2500 |

| | | | | | | | | |
|--------------|----------|--------------------|-------|-------------|----------------|----------------|------------|--------|
| Bldg Type | SHB+Cons | DixHt | Unit | Blt/Renov | Replace | Phy | Fnc | True |
| 1 DWELLING | 1 B F | 1576 | | 1978GD | 186280 | .28 | | 167650 |
| 2 Pole Build | | 30X40 | 1200 | 1978AV | 14400 | .65 | | 5040 |
| 4 Shed | | 10X24 | 240 | 2020AV | 2300 | .15 | | 1960 |
| 5 P | OPF | 5X10 | 50 | 2020AV | 1200 | .15 | | 1020 |
| homesite | 1.0000 | effective frontage | depth | actual rate | effective rate | extended value | true value | |
| | | 1.0000 | | 15000 | 15000 | 15000 | 15000 | |

Call Back: Sign: PSN Date: 2015-11-04 Lister: 20-010020.0000-v082020R