

HALE TWP
RIDGEWAY CORP

00180

Hardin County, Ohio
Michael T. Bacon, Auditor

19-170107.0000
D52

RES
2025

sale

Eff Rate:- 50.79 — 42.71 — 43.08 — 42.02 — a/r

| | | |
|------------------------------|-------------------------|--|
| 2022 HALE ALLEN & DOROTHY | 2006-07-07 | |
| 2023 HALE ALLEN & DOROTHY | 2006-07-07 | |
| 2024 HALE ALLEN & DOROTHY | 2006-07-07 | |
| 2025 HALE ALLEN & DOROTHY TR | 2006-07-07 ORIG 106-108 | |
| 152 EAST ST | 1WD | |
| RIDGEWAY OH 43345 | \$0 | |

| | | | | | | |
|------------|---------|---------|---------|---------|---------|---------|
| Tax Year | 2022 | 2023 | 2024 | 2025 | 2025 | CAMA |
| Prop Cls | 510 | 510 | 510 | 510 | 510 | 510 |
| Acres | 14140 | 16630 | 16630 | 16630 | 16630 | 16630 |
| Land100% | 100570 | 107600 | 107600 | 107600 | 107600 | 107600 |
| Bldg100% | 114710t | 124230t | 124230t | 124230t | 124230t | 124230t |
| Totl100% | | | | | | |
| Cauv100% | | | | | | |
| Tax Value: | | | | | | |
| Land 35% | 4950 | 5820 | 5820 | 5820 | 5820 | 5820 |
| Bldg 35% | 35200 | 37660 | 37660 | 37660 | 37660 | 37660 |
| Totl 35% | 40150t | 43480t | 43480t | 43480t | 43480t | 43480t |
| Hmstd35% | | | | | | |
| Owner Oc | 41.58 | 37.84 | 37.80 | 37.44 | 37.44 | |
| Hmstd RB | 399.12 | 351.74 | 379.58 | 382.82 | 382.82 | |
| Net Tax | 1432.40 | 1316.10 | 1304.62 | 1257.00 | 1257.00 | |
| Sp-Asmnt | 29.12 | 29.12 | 33.20 | 33.20 | | |

| | | | | | | | |
|------|------|------|------|-------|-------|---|-------|
| SHB+ | CONS | TYPE | FACT | SQ-FT | VALUE | a | *MAIN |
| 1 | F/C | M | | 1532 | | | |
| | F2 | G | | 624 | 14980 | b | GRAGE |
| | DK | P | | 176 | 2640 | c | PORCH |
| | OFF | P | | 128 | 3840 | d | PORCH |

#: 108, 109 L/W
191701080000
191701090000

| | | | | | | | |
|-------|----|------------|--------------------------|---------------|--------|---------|---------|
| Sale# | #p | sale date | To | Type/Invalid? | Sale\$ | co:land | co:blgd |
| 290 | 1 | 2006-07-07 | HALE ALLEN & DOROTHY TRU | LWD * | 0 | 12430 | 87690 |

| | | | | |
|------|------|-------|-------|---------|
| Year | Land | Bldg | Total | Net Tax |
| 2021 | 4950 | 35200 | 40150 | 1453.10 |
| 2020 | 4950 | 35200 | 40150 | 1456.12 |

| | | | | |
|---------|----------------------------|-----------|-----|---------|
| Project | | ben acres | / % | factor |
| 902 | MAIN DISTRICT CONSERVANCY | | | XA/2025 |
| 500 | HARDIN COUNTY LANDFILL | | | XA/2025 |
| 149 | RIDGEWAY JT - SCIOTO RIVER | | | XA/2025 |

2

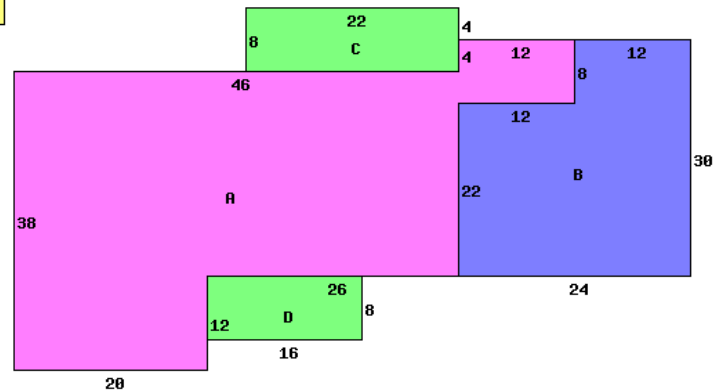

152 EAST ST 43345

| | | |
|---------------------------|------------------------|----------------------------|
| Occupancy 1 Single Family | *DWELLING COMPUTATIONS | |
| Story Height 1 | Sq-Ft | Value |
| Floor Level | 1532 | 121000 |
| Shingle | Subtotal | 121000 |
| | Main | FRAME |
| | Roof | GABLE |
| Plaster/Drywall | X | Air Conditioning 2600 |
| Floor/Carpet | X | Plumbing 2100 |
| Number of Rooms | 8 | Garages and Carports 14980 |
| Bedrooms | 3 | Extra Features 7980 |
| | | Total Value 148660 |
| Central Heat | A | |
| FORCED AIR | | PUB ELECTRIC |
| Heat Pump | A | PUB GAS |
| Central A/C | A | PUB WATER |
| Plumbing | | PRIV SEWER |
| Standard | 1 | PUB ALLEY |
| Extra 3 Fixture | 1 | |
| | | Neighborhood: |
| | | Code: 1900 |

| | | | | | | | | |
|------------|----------|-----------|-------|-----------|-----------|----------|-------|--------|
| Bldg Type | SHB+Cons | DixHt | Unit | Blt/Renov | Replace | Phy | Fnc | True |
| 1 DWELLING | 1 F/C | 1532 | | C | 1979GD | .28 | | 107040 |
| 2 Shed | | 12X14 | 168 | D | 1979AV | .65 | | 560 |
| front lot | acres/ | effective | depth | actual | effective | extended | true | |
| | frontage | frontage | depth | factor | rate | value | value | |
| | | 198.00 | 165 | 105 | 80 | 16630 | 16630 | |