

HALE TWP
MT. VICTORY CORP

00170

Hardin County, Ohio
Michael T. Bacon, Auditor

18-240016.0000
C70

RES
2025

sale

Eff Rate:- 47.75 — 40.86 — 41.23 — 40.16 — a/r

2022	CORBIN JAMES B & JULI	2021-09-01	
2023	CORBIN JAMES B & JULI	2021-09-01	
2024	CORBIN JAMES B & JULI	2021-09-01	
2025	CORBIN JAMES B & JULIAN	2021-09-01	1 ORIG 12 HOWES PT 1-12
	124 W TAYLOR ST		1TD
	MT VICTORY OH 43340		\$139,000

Tax Year	2022	2023	2024	2025	
Prop Cls	510	510	510	510	CAMA 510
Acres					
Land100%	5200	6200	6200	6200	6200
Bldg100%	105000	129710	129710	129710	129720
Totl100%	110200t	135910t	135910t	135910t	135920t
Cauvl00%					

2026	MCCAFFERTY ALEXANDER	2025-02-07	
	124 W TAYLOR ST		1WD
	MT VICTORY OH 43340		

Tax Value:					
Land 35%	1820	2170	2170	2170	2170
Bldg 35%	36750	45400	45400	45400	45400
Totl 35%	38570t	47570t	47570t	47570t	47570t
Hmstd35%					
Owner Oc	40.56	42.04	42.00	41.54	
Hmstd RB					
Net Tax	1638.94	1733.48	1751.14	1702.66	
Sp-Asmnt	102.00	120.90	120.90	120.90	

SHB+	CONS	TYPE	FACT	SQ-FT	VALUE	a	*MAIN
2	BA	F	M	1063			ADDTN
	F	A		65			PORCH
	OFF	P		48	1440		PORCH
	OFF2	P		36	1080		PORCH
	OFF	P		258	7740		PORCH
	OFF	P		65	1950		PORCH
1	F	A		36			ADDTN
	PAT	P		576	1730		PORCH

Sale#	#p	sale date	To	Type/Invalid?	Sales\$	co:land	co:bldg
54	1	2025-02-07	MCCAFFERTY ALEXANDER	1WD	299900	6200	129710
457	1	2021-09-01	CORBIN JAMES B & JULIAN	1TD	139000	5200	105000
282	1	2021-06-25	DECKLER SANDRA L TRUSTEE	1AF *	0	5200	105000
315	2	2018-08-13	DECKLER CARL E & SANDRA L	2QC *	0	4940	95060
314	2	2018-08-13	DECKLER CARL E TRUSTEE	2QC *	0	4940	95060
204	2	2011-05-25	DECKLER CARL E TRUSTEE	2QC *	0	5030	67710
404	1	2008-08-12	DECKLER SANDRA	1DD *	29000	4800	64570
168	1	2005-05-10	SCHWARTZ THOMAS	1QC *	0	4370	61570
389	1	2000-06-30	SCHWARTZ THOMAS	1WD	71000	4370	49910
424	1	1990-05-30		1WD	39000	0	31000
133	1	1990-02-21		1WD	27500	0	31000
115	1	1990-02-14		1UN *	0	0	31000
875	0	1987-10-13		*	27500	0	31000
817	0	1985-11-13		*	29000	0	22510

Year	Land	Bldg	Total	Net Tax
2021	1820	36750	38570	1694.42
2020	1820	36750	38570	1696.76

p r o j e c t		ben acres		/ % factor	
148	WILDCAT JT - SCIOTO RIVER			XA/2025	
503	MT VICTORY LIGHTS			XV/2025	
500	HARDIN COUNTY LANDFILL			XA/2025	

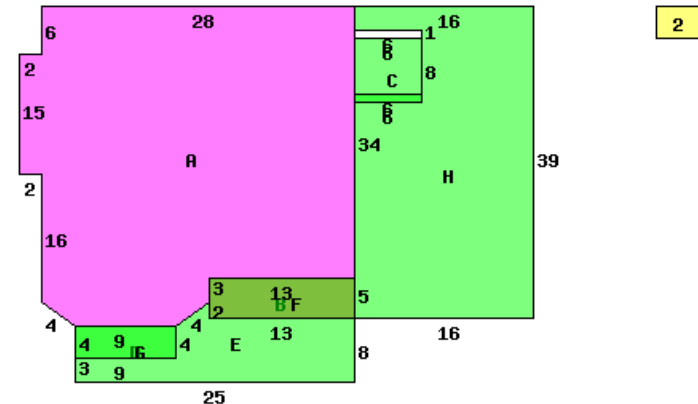

124 W TAYLOR ST 43340

Occupancy 1 Single Family		*DWELLING COMPUTATIONS	
Story Height	2	Sq-Ft	Value
Floor Level	Main	FRAME	1099 105720
	Full Upper	FRAME	1128 62420
	Qtr Story	FRAME	1063 4240
	Basement		260 5100
	Subtotal		177480

Bldg Type	SHB+Cons	DixHt	Unit	Blt/Renov	Replace	Phy	Fnc	True
1 DWELLING	1 F/C	3290	Grade	Cond	Value	Dpr	Dpr	Value
2 Shed		10X20	200	D	2022AV	.05		1820
front lot		effective	depth	actual	effective	extended	true	
		frontage	depth	factor	rate	value	value	
		66.00	132	94	100	6200	6200	

Plaster/Drywall	X X	1063 sq ft	Attic Finish	16500
Unfinished Wall	X		Air Conditioning	6000
Floor/Pine	X X		Plumbing	1400
Floor/Carpet	X		Extra Features	13940
Number of Rooms	4 4 2 2		Total Value	215320
Bedrooms	2 2			
Central Heat	A		PUB ELECTRIC	
FORCED AIR			PUB GAS	
Central A/C	A		PUB WATER	
Plumbing			PRIV SEWER	
Standard	1		PUB SIDEWALK	
Extra 2 Fixture	1		Neighborhood:	
			Code:	1800
			Dwl/Gar/NC%	.9000