

HALE TWP
MT. VICTORY CORP

00170

Hardin County, Ohio
Michael T. Bacon, Auditor

18-230061.0000
C123

RES
2025

sale

Eff Rate:- 47.75 — 40.86 — 41.23 — 40.16 — a/r

| | |
|---------------------|----------------------------------|
| 2022 MULLINS HOLLY | 2014-09-25 |
| 2023 MULLINS HOLLY | 2014-09-25 |
| 2024 MULLINS HOLLY | 2014-09-25 |
| 2025 MULLINS HOLLY | 2014-09-25 |
| 427 N HIGH ST | 2014-09-25 VICTORY MEADOWS LOT 4 |
| MT VICTORY OH 43340 | 1QC |
| | \$0 |

| | | | | | |
|------------|---------|---------|---------|---------|----------------------|
| Tax Year | 2022 | 2023 | 2024 | 2025 | CAMA |
| Prop Cls | 561 | 561 | 561 | 561 | 561 |
| Acres | | | | | |
| Land100% | 10510 | 12800 | 12800 | 12800 | 12800 |
| Bldg100% | 75290 | 98340 | 98340 | 98340 | 98350 |
| Totl100% | 85800t | 111140t | 111140t | 111140t | 111150t |
| Cauvl00% | | | | | |
| Tax Value: | | | | | |
| Land 35% | 3680 | 4480 | 4480 | 4480 | 4480 |
| Bldg 35% | 26350 | 34420 | 34420 | 34420 | 34420 |
| Totl 35% | 30030t | 38900t | 38900t | 38900t | 38900t |
| Hmstd35% | | | | 38260 | |
| Owner Oc | | | | 33.42 | |
| Hmstd RB | | | | | hmstd 4480 l 33780 b |
| Net Tax | 1307.64 | 1451.92 | 1466.32 | 1392.90 | |
| Sp-Asmnt | 83.18 | 101.82 | 106.41 | 106.41 | |

Orig Tax Year 1999
Parent: 18-230060.0000

| SHB+ | CONS | TYPE | FACT | SQ-FT | VALUE | a | *MAIN |
|------|------|------|------|-------|-------|---|-------|
| 1 | F/C | M | | 1728 | 2400 | b | PORCH |
| | DK | P | | 160 | 2400 | | |

| Sale# | #p | sale date | To | Type/Invalid? | Sale\$ | co:land | co:blgd |
|-------|----|------------|-------------------------|---------------|--------|---------|---------|
| 477 | 1 | 2014-09-25 | MULLINS HOLLY | 1QC * | 0 | 6710 | 83460 |
| 488 | 1 | 2007-09-12 | MULLINS HOLLY & PHILLIP | 1WD | 10000 | 7140 | 0 |
| 516 | 13 | 2002-09-26 | HOME CENTER INC | 13 | 180000 | 1710 | 0 |

| Year | Land | Bldg | Total | Net Tax |
|------|------|-------|-------|---------|
| 2021 | 3680 | 26350 | 30030 | 1319.26 |
| 2020 | 3680 | 26350 | 30030 | 1321.08 |

project ben acres / % factor

| | |
|-------------------------------|---------|
| 503 MT VICTORY LIGHTS | XV/2025 |
| 902 MAIN DISTRICT CONSERVANCY | XA/2025 |
| 500 HARDIN COUNTY LANDFILL | XA/2025 |

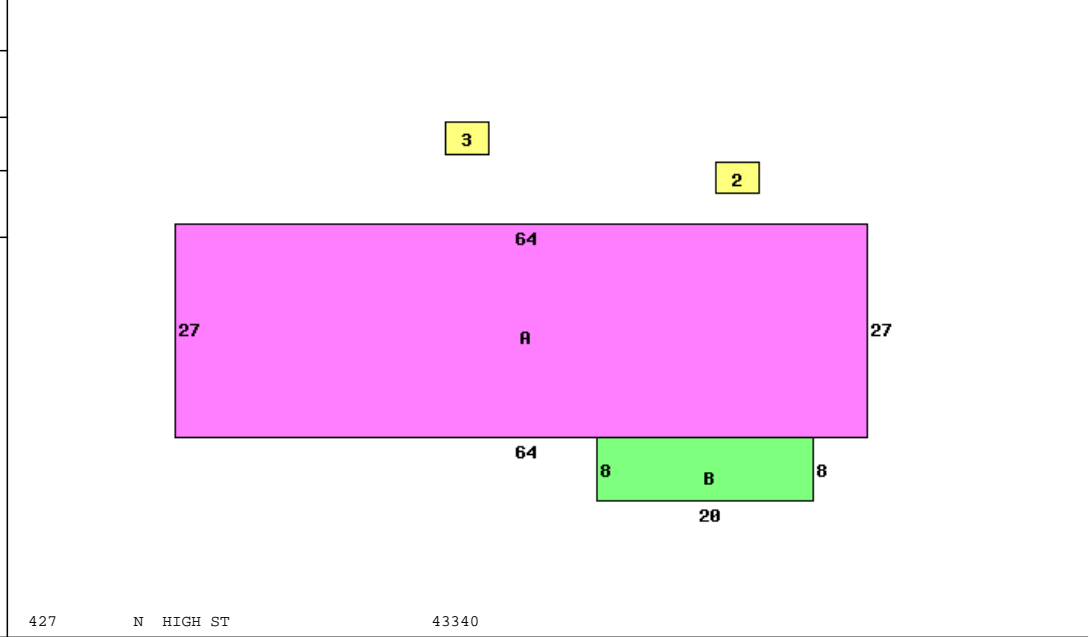

| Occupancy 4 M/H on Real Estate | | *DWELLING COMPUTATIONS | | |
|--------------------------------|----------|------------------------|-------------|--------|
| Story Height | 1 | Sq-Ft | Value | |
| Floor Level | Main | FRAME | 1728 127670 | |
| Shingle | Subtotal | Roof | GABLE | 127670 |
| Plaster/Drywall | D | Air Conditioning | 2990 | |
| Floor/Carpet | X | Plumbing | 2100 | |
| Floor/Tile-Lino | X | Extra Features | 2400 | |
| Number of Rooms | 6 | Total Value | 135160 | |
| Bedrooms | 3 | | | |
| Central Heat | A | PUB PAVED ST/RD | | |
| FORCED AIR | | Neighborhood: | | |
| Central A/C | A | Code: | 1820 | |
| Plumbing | | Dwl/Gar/NC% | 1.0500 | |
| Standard | 1 | | | |
| Extra 3 Fixture | 1 | | | |

| Bldg Type | SHB+Cons | DixHt | Unit | Blt/Renov | Replace | Phy | Fnc | True |
|-----------|----------|-----------|--------|-----------|---------|-----------|----------|-------|
| 1 MH/REAL | 1 F/C | 1728 | | MHD | 2007AV | 108130 | .15 | 96510 |
| 2 Shed | *PP | 10X14 | 140 | | 2008AV | 0 | | 0 |
| 3 Shed | | 10X24 | 240 | D | 2017AV | 2300 | .20 | 1840 |
| front lot | acres/ | effective | depth | depth | actual | effective | extended | true |
| | frontage | frontage | factor | factor | rate | rate | value | value |
| | | 80.00 | 120 | 89 | 180 | 160 | 12800 | 12800 |