

HALE TWP
RIDGEMONT SD

00150

Hardin County, Ohio
Michael T. Bacon, Auditor

16-050014.0000
C140

RES
2025

sale

Eff Rate:- 47.75 — 40.86 — 41.23 — 40.16 — a/r

| | | | | |
|------|---|------------|-----------|---------|
| 2022 | STACKLIN PATRICK D & | 2011-12-19 | | |
| 2023 | STACKLIN PATRICK D & | 2011-12-19 | | |
| 2024 | STACKLIN PATRICK D & | 2011-12-19 | | |
| 2025 | STACKLIN PATRICK D & ST 17240 TR 206 | 2011-12-19 | 10176 | 16.678A |
| | MT VICTORY OH 43340 | | \$300,000 | |

| | | | | | |
|------------|---------|---------|---------|---------|---------|
| Tax Year | 2022 | 2023 | 2024 | 2025 | CAMA |
| Prop Cls | 512 | 512 | 512 | 512 | 512 |
| Acres | 16.6800 | 16.6800 | 16.6800 | 16.6800 | |
| Land100% | 38430 | 65110 | 65110 | 65110 | 65120 |
| Bldg100% | 259830 | 302400 | 302400 | 302400 | 302400 |
| Totl100% | 298260t | 367510t | 367510t | 367510t | 367520t |
| Cauv100% | | | | | |
| Tax Value: | | | | | |
| Land 35% | 13450 | 22790 | 22790 | 22790 | 22790 |
| Bldg 35% | 90940 | 105840 | 105840 | 105840 | 105840 |
| Totl 35% | 104390t | 128630t | 128630t | 128630t | 128630t |
| Hmstd35% | 89190 | 100860 | 100860 | 100570 | |
| Owner Oc | 93.78 | 89.14 | 89.04 | 87.84 | |
| Hmstd RB | | | | | |
| Net Tax | 4451.80 | 4711.92 | 4759.66 | 4628.50 | |
| Sp-Asmnt | 20.57 | 20.57 | 27.52 | 27.52 | |

| SHB+ | CONS | TYPE | FACT | SQ-FT | VALUE | a | *MAIN |
|------|------|------|------|-------|-------|---|-------|
| 2 B | F | M | | 962 | | b | PORCH |
| | POR | P | | 222 | 7100 | c | GRAGE |
| | F2 | G | | 624 | 14980 | d | ADDTN |
| 1 B | F | A | | 338 | | e | PORCH |
| | PAT | P | | 130 | 390 | f | PORCH |
| | OFFP | P | | 110 | 3300 | g | PORCH |
| | OFFP | P | | 300 | 9000 | h | PORCH |
| | CAN | P | | 130 | 1040 | i | PORCH |
| | PAT | P | | 720 | 2160 | | |

| gas fireplace 2 | | | | | | | |
|-----------------|-------|------------|---------------------------|---------------|--------|---------|---------|
| Sale# | #p | sale date | To | Type/Invalid? | Sale\$ | co:land | co:bldg |
| 568 | 1 | 2011-12-19 | STACKLIN PATRICK D & STAC | 1WD | 300000 | 26170 | 169600 |
| Year | Land | Bldg | Total | Net Tax | | | |
| 2021 | 13450 | 85830 | 99280 | 4266.02 | | | |
| 2020 | 13450 | 85830 | 99280 | 4272.00 | | | |

| project | ben acres | % | factor |
|-------------------------------|-----------|---|--------|
| 902 MAIN DISTRICT CONSERVANCY | | | |
| 500 HARDIN COUNTY LANDFILL | | | |

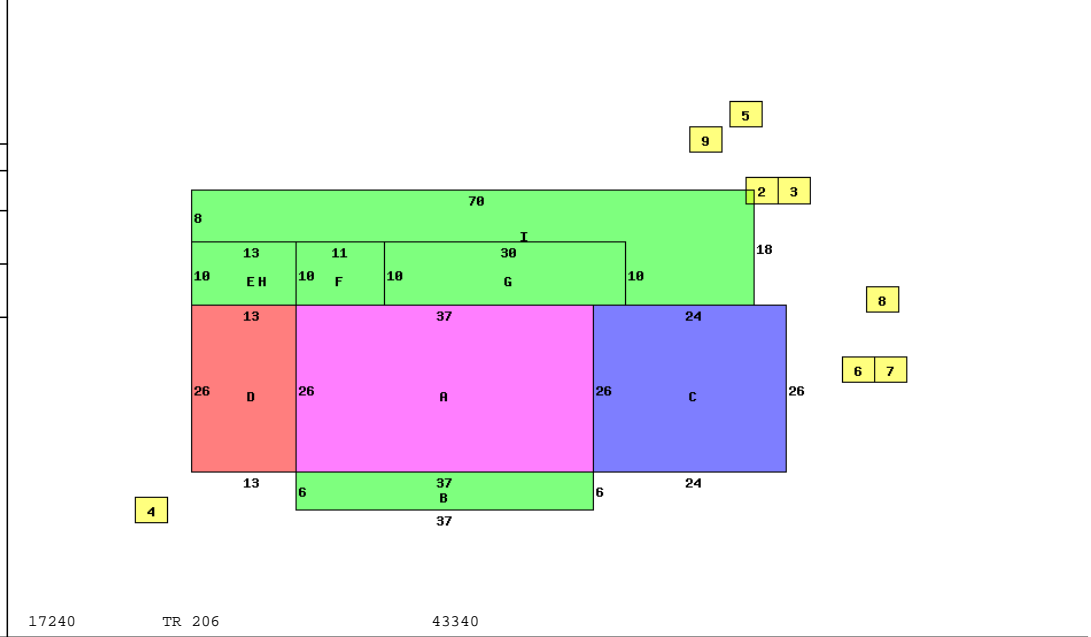

| Occupancy 1 Single Family | | *DWELLING COMPUTATIONS | |
|---------------------------|------------|------------------------|-------------|
| Story Height | 2 | Sq-Ft | Value |
| Floor Level | | | |
| | Main | FRAME | 1300 107470 |
| | Full Upper | FRAME | 962 60650 |
| | Basement | | 1300 24060 |
| | Subtotal | | 192180 |
| Shingle | Roof | GABLE | |
| Plaster/Drywall | X X | Air Conditioning | 4010 |
| Panelled Wall | X | Plumbing | 3500 |
| Unfinished Wall | X | Garages and Carports | 14980 |
| Floor/Carpet | X X X | Extra Features | 25950 |
| Number of Rooms | 2 5 4 | Total Value | 240620 |
| Bedrooms | 1 4 | | |
| Central Heat | A | PUB ELECTRIC | |
| ELECTRIC | | PRIV WATER | |
| Central A/C | A | PRIV SEWER | |
| Plumbing | | PUB PAVED ST/RD | |
| Standard | 1 | Neighborhood: | |
| Extra 3 Fixture | 1 | Code: | 1600 |
| Extra 2 Fixture | 1 | Dwl/Gar/NC% | 1.3100 |

| Bldg Type | SHB+Cons | DixHt | Area | Unit Rate | Grade | Blt/Renov | Replace | Phy | Fnc | True |
|---------------|----------|-----------|-------|-----------|-----------|-----------|---------|-----|-----|--------|
| 1 DWELLING | 2 B F | | 2262 | | B- | 1979GD | 288740 | .28 | | 272340 |
| 2 Pole Build | | 30X36 | 1080 | | C | 1979AV | 12960 | .65 | | 4540 |
| 3 P | CAN | 10X30 | 300 | | C | 1985AV | 2400 | .65 | | 840 |
| 4 POND | *.60A | | 0 | | | OLD/ | 0 | | | 0 |
| 5 Shed | *PP | 10X14 | 0 | | | 1985AV | 0 | | | 0 |
| 6 Shed | *PP | 10X12 | 0 | | | 1985AV | 0 | | | 0 |
| 7 Lean-To | *PP | 10X12 | 0 | | | 1985AV | 0 | | | 0 |
| 8 Shed | | 6X8 | 48 | | | 1985AV | 580 | .65 | | 200 |
| 9 Pole Build | | 40X48 | 1920 | | C | 2020AV | 28800 | .15 | | 24480 |
| | | effective | depth | actual | effective | extended | true | | | |
| homesite | 1.0000 | frontage | depth | rate | rate | value | value | | | |
| small acreage | 1.5400 | | | 15000 | 15000 | 15000 | 15000 | | | |
| other | 14.1400 | | | 5000 | 5000 | 7700 | 7700 | | | |
| | | | | 3000 | 3000 | 42420 | 42420 | | | |

Call Back:

Sign: PSN Date: 2014-12-18 Lister:

16-050014.0000-v082020R