

HALE TWP
RIDGEMONT SD

00150

Hardin County, Ohio
Michael T. Bacon, Auditor

16-010065.0000
D105

AGR
2025

sale

Eff Rate:- 47.75 — 40.86 — 41.23 — 40.16 — a/r

| | | | | |
|-------------------------|------------|-------|-------|--|
| 2022 ASHBA BERNADETTE T | 1987-06-18 | | | |
| 2023 ASHBA BERNADETTE T | 1987-06-18 | | | |
| 2024 ASHBA BERNADETTE T | 1987-06-18 | | | |
| 2025 ASHBA BERNADETTE T | 1987-06-18 | 13406 | 3.00A | |
| 20930 CR 265 | | | | |
| RIDGEWAY OH 43345 | \$0 | | | |

| | | | | | |
|----------|---------|---------|---------|---------|---------|
| Tax Year | 2022 | 2023 | 2024 | 2025 | CAMA |
| Prop Cls | 111 | 111 | 111 | 111 | 111 |
| Acres | 3.0000 | 3.0000 | 3.0000 | 3.0000 | |
| Land100% | 21570 | 24800 | 24800 | 24800 | 24790 |
| Bldg100% | 101510 | 158510 | 158510 | 158510 | 158520 |
| Totl100% | 123090t | 183310t | 183310t | 183310t | 183310t |
| Cauv100% | 14110 | 18710 | 18710 | 18710 | 18720 |

| | | | | |
|------------------------------|------------|--|--|--|
| 2027 COATS BERNADETTE T & ST | 2026-04-14 | | | |
| 20930 CR 265 | 2SD | | | |
| RIDGEWAY OH 43345 | | | | |

| | | | | | |
|------------|---------|---------|---------|---------|----------------------|
| Tax Value: | | | | | |
| Land 35% | 4940 | 6550 | 6550 | 6550 | 8680 |
| Bldg 35% | 35530 | 55480 | 55480 | 55480 | 55480 |
| Totl 35% | 40470t | 62030t | 62030t | 62030t | 64160t |
| Hmstd35% | 38980 | 59450 | 59450 | 59450 | |
| Owner Oc | 40.98 | 52.54 | 52.48 | 51.92 | hmstd 5250 l 54200 b |
| Hmstd RB | | | | | |
| Net Tax | 1721.26 | 2262.70 | 2285.74 | 2222.46 | |
| Cauv Sav | 113.66 | 79.50 | 80.28 | 78.10 | |
| Sp-Asmnt | 20.52 | 20.52 | 27.59 | 27.59 | |

| | | | | | | | |
|------|------|------|------|-------|-------|---|-------|
| SHB+ | CONS | TYPE | FACT | SQ-FT | VALUE | a | *MAIN |
| 2 B | F | M | | 840 | | b | ADDN |
| 1 | F/C | A | | 72 | | c | ADDN |
| 1 | F/C | A | | 90 | 3600 | d | PORCH |
| | FFP | P | | 518 | 7770 | e | PORCH |
| | DK | P | | 192 | 7680 | f | PORCH |
| | FFP | P | | | | | |

| | | | | | | | |
|-------|----|------------|-------------------------|---------------|--------|---------|---------|
| Sale# | #p | sale date | To | Type/Invalid? | Sale\$ | co:land | co:bldg |
| 168 | 2 | 2026-04-14 | COATS BERNADETTE T & ST | 2SD * | 0 | 24800 | 158510 |
| 494 | 0 | 1987-06-18 | | * | 0 | 0 | 36800 |

| | | | | |
|------|------|-------|-------|---------|
| Year | Land | Bldg | Total | Net Tax |
| 2021 | 4940 | 35530 | 40470 | 1736.18 |
| 2020 | 4940 | 35530 | 40470 | 1738.60 |

| | | | | |
|-------------------------------|---------|-----------|-----|--------|
| p r o j e c t | | ben acres | / % | factor |
| 902 MAIN DISTRICT CONSERVANCY | XA/2025 | | | |
| 500 HARDIN COUNTY LANDFILL | XA/2025 | | | |

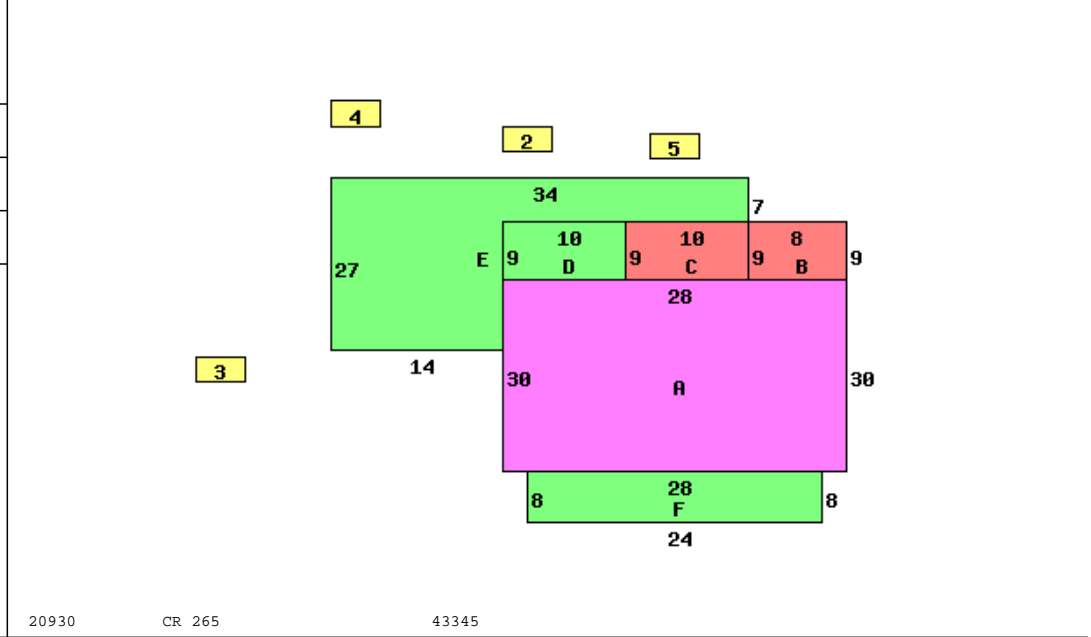

| | |
|---------------------------|-------------------------|
| Occupancy 1 Single Family | *DWELLING COMPUTATIONS |
| Story Height 2 | Sq-Ft Value |
| Floor Level | |
| Main | FRAME 1002 100850 |
| Full Upper | FRAME 840 59620 |
| Basement | 420 8070 |
| Subtotal | 168540 |
| Metal | Roof HIP |
| B 1 2 U A | |
| Plaster/Drywall | X Air Conditioning 3270 |
| Panelled Wall | X Extra Features 19050 |
| Unfinished Wall | X Total Value 190860 |
| Floor/Pine | X X |
| Floor/Carpet | X X |
| Number of Rooms | 1 4 3 |
| Bedrooms | 3 |
| Central Heat | A PUB ELECTRIC |
| FORCED AIR | PRIV WATER |
| Central A/C | A PRIV SEWER |
| Plumbing | PUB PAVED ST/RD |
| Standard | 1 Dwl/Gar/NC% 1.3100 |

| | | | | | | | | | |
|--------------|-------------------------|-----------|--------|--------|-----------|---------|-------|--------|--------|
| Bldg Type | SHB+Cons | DixHt | Unit | Grade | Blt/Renov | Replace | Phy | Fnc | True |
| 1 DWELLING | 2 B F | 1842 | | C | OLD/GD | 190860 | .40 | | 150020 |
| 2 Garage | | 20X22 440 | | C | 1940AV | 10560 | .65 | | 4840 |
| 3 Grain Bin | *PP | 10X10 100 | | C | OLD/FR | 0 | | | 0 |
| 4 Pole Build | | 18X25 450 | | C | 1980AV | 5400 | .65 | | 1890 |
| 5 Shed | | 22X24 528 | | D | OLD/AV | 5070 | .65 | | 1770 |
| Tab # | S O I L | Acres | Mkt/Ac | Market | Au/Ac | Cauv | | | |
| C 2 | BOB BLOUNT SILT LOAM, 2 | 1.0008 | 5770 | 5770 | 2360 | 2360 | | | |
| C 14 | GWB GLYNWOOD SILT LOAM | .6962 | 5400 | 3760 | 1750 | 1220 | | | |
| C 39 | PM PEWAMO SILTY CLAY L | .0405 | 6490 | 260 | 3560 | 140 | | | |
| 670 | HSITE HOMESITE | 1.0000 | 15000 | 15000 | 15000 | 15000 | | | |
| 980 | ROAD ROAD | .2625 | | | | | | | |
| | | 3 | | | 24790 | (100%) | 18720 | CAUV # | 1595 |
| | | | | | 8680 | (35%) | 6550 | | |

Call Back:

Sign: PSN Date: 2015-01-19 Lister:

16-010065.0000-v082020R