

GOSHEN TWP KENTON SD 00130 Hardin County, Ohio Michael T. Bacon, Auditor 14-270018.0000 RES 2025

sale

Eff Rate:- 51.44 44.77 47.15 46.85 a/r

Table with columns for year (2022-2025), name (COLLINS RENEE L), address (23385 TR 126), and value (\$11,000).

Table with columns for Tax Year (2022-2025), Prop Cls, Acres, Land100%, Bldg100%, Totl100%, Cauvl00%, Tax Value, and various percentages (Land 35%, Bldg 35%, etc.).

Orig Tax Year 1998 Parent: 14-270003.0000

Table with columns for SHB+ (1H, 1), CONS (F, F/S, PAT), TYPE (M, A, P), FACT (1200, 1225, 630), SQ-FT (1890), VALUE (1890), and Type/Invalid? (a, b, c).

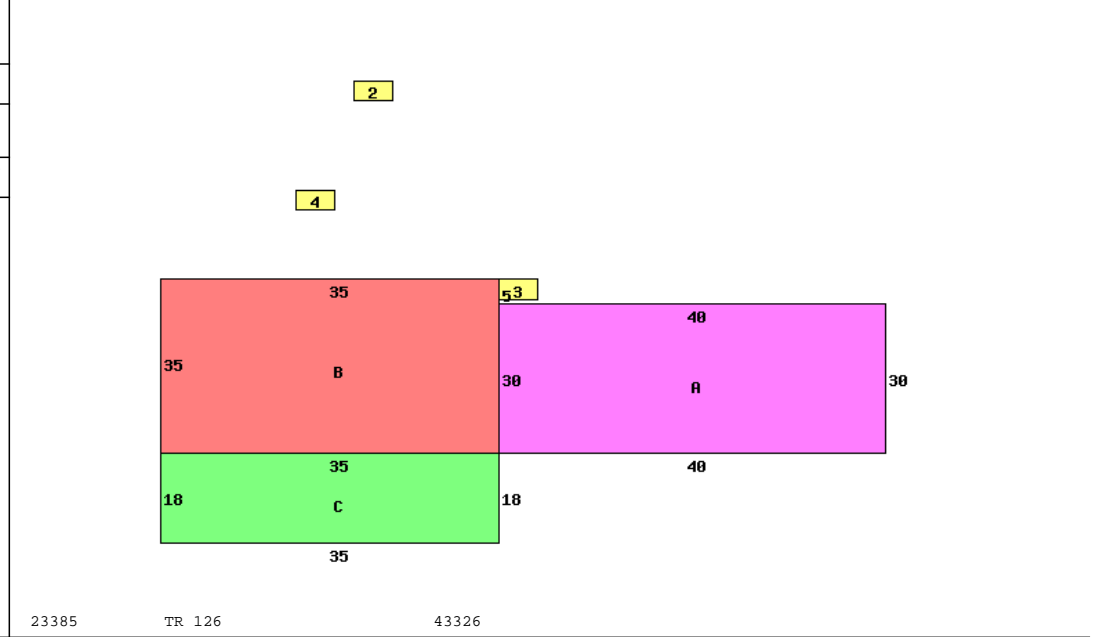

project 500 HARDIN COUNTY LANDFILL XA/2025 ben acres / % factor

Table with columns for occupancy (1 Single Family), story height (1), floor level, shingle, and plumbing details (Plumbing, Extra Features, PUB ELECTRIC, etc.).

Table with columns for Bldg Type (1 DWELLING, 2 Pole Build, 3 Stable, 4 Shed), SHB+Cons (1 F), DixHt (48X64, 12X20), Area (3625, 3072, 10140, 240), Unit Rate, Grade (D, C, D), Blt/Renov (1996A, 2002AV, 1996AV, 2002AV), Replace (161820, 44540, 152100, 2300), Phy Dpr (.24, .55, .60, .55), Fnc Dpr, True Value (152500, 20040, 60840, 1040).