

GOSHEN TWP 00130 Hardin County, Ohio Michael T. Bacon, Auditor 14-270009.0000 AGR 2023 KENTON SD

sale

Eff Rate:- 45.49 51.61 51.44 44.77 a/r

Table with columns for year, owner name, address, and tax amount. Includes entries for 2020-2023 COOK CHRISTINA M and KENTON OH 43326.

Table with columns for Tax Year (2020-2023), Prop Cls, Acres, Land100%, Bldg100%, Totl100%, and Cauv100%. Includes values for 2020-2023.

Orig Tax Year 2001 Parent: 14-270008.0000

Table with columns for Tax Value (Land 35%, Bldg 35%, Totl 35%, Hmstd35%, Owner Oc, Hmstd RB, Net Tax) and Sp-Asmnt (18.00).

Table with columns for SHB+, CONS, TYPE, FACT, SQ-FT, VALUE, and various codes (a-e).

Table with columns for Sale#, #p, sale date, To, Type/Invalid?, Sale\$, co:land, co:blgd.

Table with columns for Year, Land, Bldg, Total, Net Tax.

Project 500 HARDIN COUNTY LANDFILL ben acres / % factor

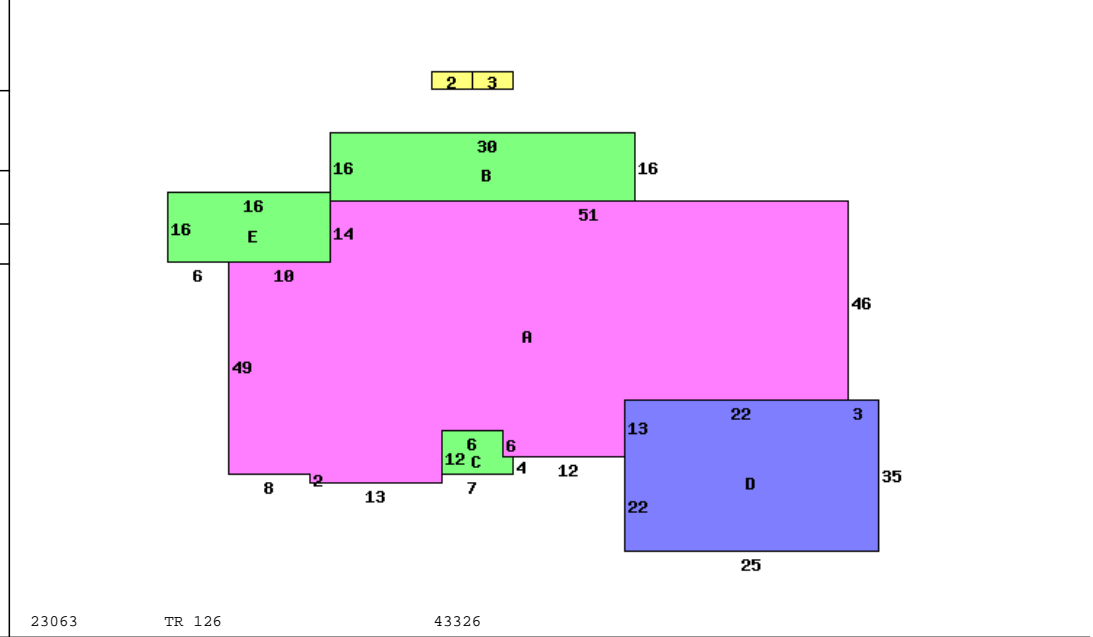

Table with columns for Occupancy, Story Height, Floor Level, Shingle, and various room/feature descriptions with values.

Table with columns for Bldg Type, SHB+Cons, DixHt, Area, Unit Rate, Grade, Blt/Renov, Replace, Phy, Fnc, True Value.

Table with columns for Tab #, S O I L, Acres, Mkt/Ac, Market, Au/Ac, Cauv.

Table with columns for PUB ELECTRIC, PRIV WATER, PRIV SEWER, PUB PAVED ST/RD.

Table with columns for Neighborhood, Code, Dwl/Gar/NC%.