

GOSHEN TWP KENTON SD 00130 Hardin County, Ohio Michael T. Bacon, Auditor 14-260009.0000 RES 2025

sale

Eff Rate:- 51.44 44.77 47.15 46.85 a/r

Table with columns for year (2022-2025), name (HARBISON THOMAS L & C), date (1994-07-15), and value (\$70,000).

Table with columns for Tax Year (2022-2025), Prop Cls, Acres, Land100%, Bldg100%, Totl100%, and Cauv100%. Includes Tax Value and Net Tax.

Table with columns for SHB+ (2 B), CONS (F), TYPE (M, A), FACT (A), SQ-FT (960, 105, 180, 75, 90, 2700), and VALUE (5400, 2700).

Table with columns for Sale# (639), #p (1), sale date (1994-07-15), To (HARBISON THOMAS L & CARL), Type/Invalid?, Sales\$ (70000), co:land (0), and co:blgd (51830).

Table with columns for Year (2021, 2020), Land (7430), Bldg (34910), Total (42340), and Net Tax (1979.38, 1718.70).

Table with columns for project (500 HARDIN COUNTY LANDFILL), ben acres, and factor.

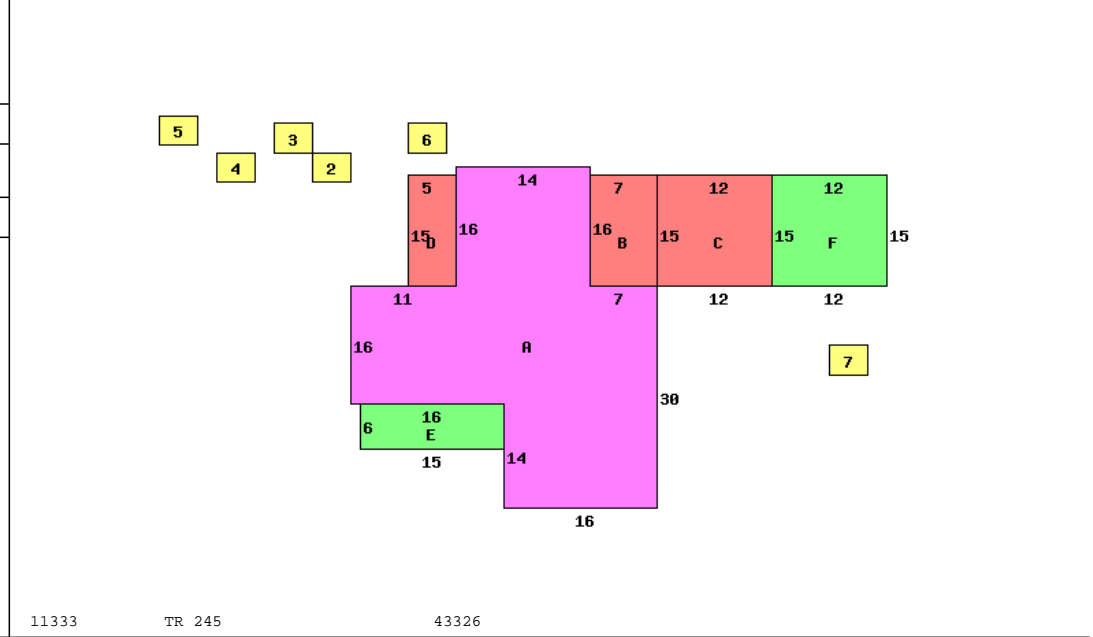

Table with columns for Occupancy (1 Single Family), *DWELLING COMPUTATIONS (Sq-Ft, Value), and various building details like Story Height, Floor Level, and Shingle.

Table with columns for Bldg Type, SHB+Cons, DixHt, Area, Unit Rate, Grade, Blt/Renov, Replace, Phy Dpr, Fnc Dpr, and True Value.

Table with columns for homesite, small acreage, acres/frontage, effective frontage, depth, depth factor, actual rate, effective rate, extended value, and true value.