

GOSHEN TWP 00130 Hardin County, Ohio Michael T. Bacon, Auditor 14-230038.0000 RES 2025 KENTON SD C46

sale

Eff Rate:- 51.44 44.77 47.15 46.85 a/r

Table with columns for year (2022-2025), name (PHILLIPS KIMBERLY J, MCMAHON JENNIFER & MCMAHON JENNIFER &), address (11224 TR 205), and value (\$425,000).

Table with columns for Tax Year (2022-2025), Prop Cls, Acres, Land100%, Bldg100%, Totl100%, Cauvl00%, Tax Value, and various percentages (Land 35%, Bldg 35%, etc.).

Orig Tax Year 2005 Parent: 14-230001.0000

Table with columns for SHB+, CONS, TYPE, FACT, SQ-FT, VALUE, and various codes (a-i).

Table with columns for Sale#, #p, sale date, To, Type/Invalid?, Sales\$, co:land, co:bldg.

Table with columns for Year, Land, Bldg, Total, Net Tax.

Table with columns for project, range, hardin county landfill, sanders ditch, tymochttee, ben acres, and factor.

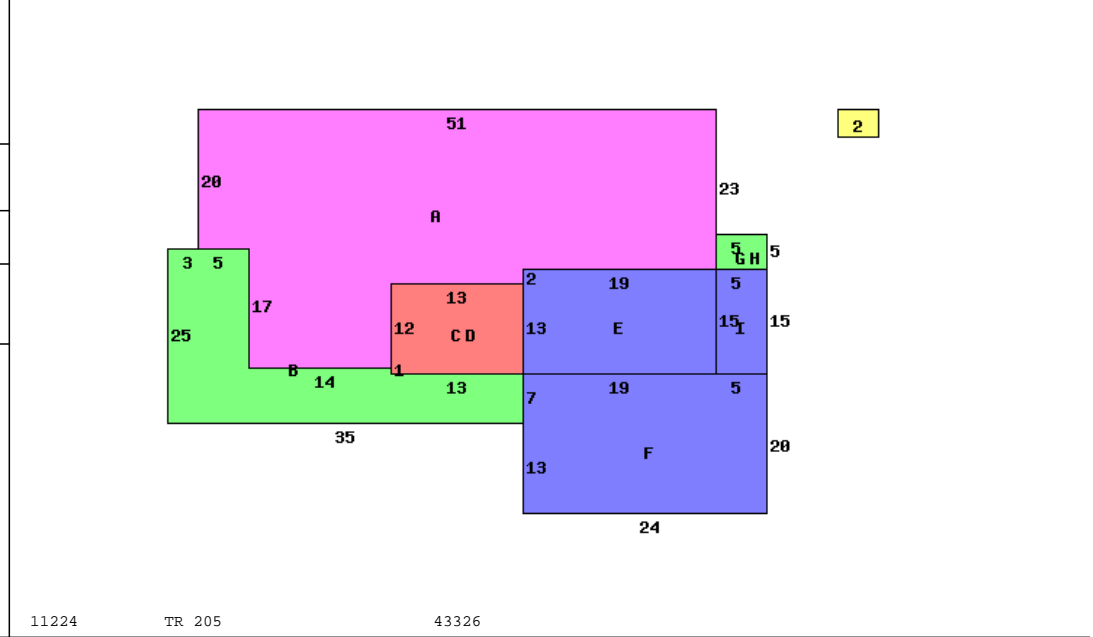

11224 TR 205 43326

Table with columns for Occupancy (1 Single Family), *DWELLING COMPUTATIONS (Sq-Ft, Value), and various building details (Story Height, Floor Level, Shingle, etc.).

Table with columns for Bldg Type, SHB+Cons, DixHt, Area, Unit, Rate, Grade, Blt/Renov, Replace, Phy, Fnc, True Value.

Table with columns for homesite, small acreage, effective frontage, depth, actual depth, effective rate, extended value, true value.

Call Back: Sign: PSN Date: 2015-05-11 Lister: 14-230038.0000-v082020R