

GOSHEN TWP 00130 Hardin County, Ohio Michael T. Bacon, Auditor 14-230037.0000 RES 2025 KENTON SD

sale

Eff Rate:- 51.44 44.77 47.15 46.85 a/r

Table with columns: Year, Sale#, Sale Date, To, Type/Invalid?, Sale\$, Co:land, Co:blgd. Includes entries for 2022-2025 SPEARMAN KARISSA and KENTON OH 43326.

Table with columns: Tax Year, Prop Cls, Acres, Land100%, Bldg100%, Totl100%, Cauv100%, Tax Value, Land 35%, Bldg 35%, Totl 35%, Hmstd35%, Owner Oc, Hmstd RB, Net Tax, Sp-Asmnt. Includes values for 2022-2025.

Orig Tax Year 1998 Parent: 14-230022.0000

Table with columns: SHB+, CONS, TYPE, FACT, SQ-FT, VALUE. Includes rows for F/C, OFP, DK, PAT with values 1680, 224, 100, 224 and values 6720, 1500, 670.

Table with columns: Sale#, #p, sale date, To, Type/Invalid?, Sale\$, co:land, co:blgd. Includes project history for 336, 476, 343, 85, 59, 569, 308, 264, 594.

Table with columns: Year, Land, Bldg, Total, Net Tax. Includes rows for 2021 and 2020.

Table with columns: Project, Range, County, Ditch, TyMOCHTEE. Includes rows for 105, 500, 362, 387.

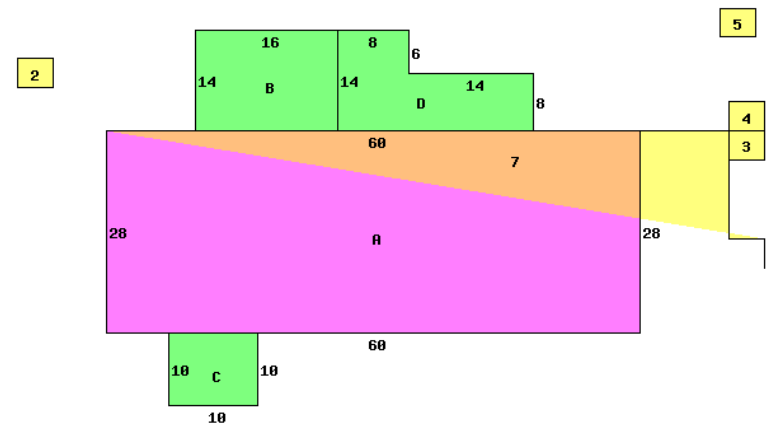

11700 TR 205 43326

Table with columns: Occupancy, Story Height, Floor Level, Shingle, Plaster/Drywall, Floor/Carpet, Floor/Tile-Lino, Number of Rooms, Bedrooms, Central Heat, FORCED AIR, Central A/C, Plumbing, Standard, Extra 3 Fixture. Includes details for Dwelling Computations and Dwelling Features.

Table with columns: Bldg Type, SHB+Cons, DixHt, Area, Unit Rate, Grade, Blt/Renov, Replace, Phy, Fnc, True Value. Includes rows for Dwelling, Shed, Garage, Pond, Lean-To, Shed.

Table with columns: homesite, small acreage, acres/frontage, effective frontage, depth, depth factor, actual rate, effective rate, extended value, true value. Includes values for 1.0000 and 1.0020.