

GOSHEN TWP 00130 Hardin County, Ohio Michael T. Bacon, Auditor 14-230023.0000 RES C59 2025

sale

Table with columns: Year, Name (CLEMENT ARTHUR RAY), Address (11808 TR 205), and Value (\$0).

Table with columns: Tax Year (2022-2025), Prop Cls, Acres, Land/Building/Totals, and Tax Value (Land, Bldg, Total).

Table with columns: SHB+, CONS, TYPE, FACT, SQ-FT, VALUE, and other details.

#: 26, L/W 142300260000 1.49a

Table with columns: Sale#, #p, sale date, To, Type/Invalid?, Sale\$, co:land, co:blgd.

Table with columns: Year, Land, Bldg, Total, Net Tax.

Table with columns: project, name (RANGE - TYMOCHTEE, SANDERS DITCH), and other details.

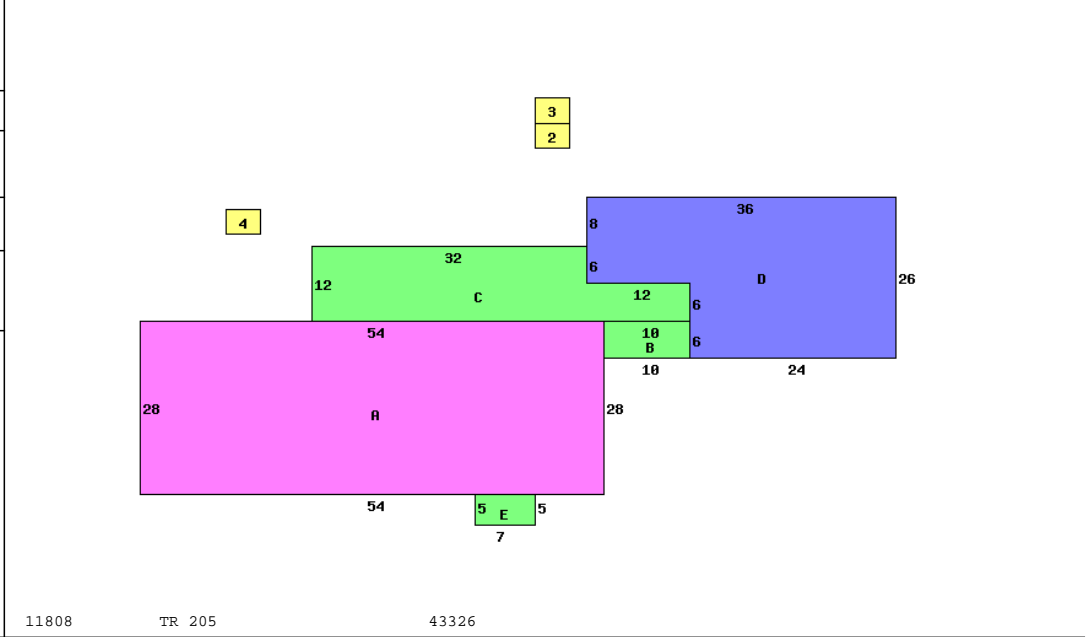

Table with columns: Occupancy (1 Single Family), *DWELLING COMPUTATIONS (Sq-Ft, Value), and other details.

Table with columns: Bldg Type, SHB+Cons, DixHt, Area, Unit, Grade, Blt/Renov, Replace, Phy, Fnc, True Value.

Table with columns: homesite, small acreage, effective frontage, depth, actual rate, effective rate, extended value, true value.

Call Back: Sign: PSN Date: 2015-05-11 Lister: 14-230023.0000-v082020R