

GOSHEN TWP  
KENTON SD

00130

Hardin County, Ohio  
Michael T. Bacon, Auditor

14-220047.0000  
C18

RES  
2025

sale

Eff Rate:- 51.44 — 44.77 — 47.15 — 46.85 — a/r

2022	HEGE P	HAROLD & WILDA	2006-05-01		
2023	HEGE P	HAROLD & WILDA	2006-05-01		
2024	HEGE P	HAROLD & WILDA	2006-05-01		
2025	HEGE P	HAROLD TRUSTEE	2024-02-26	PT SE4 SW4 S31	3.00A
	18437	SR 309		1QC	
			\$0		

Tax Year	2022	2023	2024	2025	CAMA
Prop Cls	511	511	511	511	511
Acres	3.0000	3.0000	3.0000	3.0000	
Land100%	18600	25000	25000	25000	25000
Bldg100%	106830	119830	119830	119830	119820
Totl100%	125430t	144830t	144830t	144830t	144820t
Cauv100%					

Orig Tax Year	2007
Parent:	14-220011.0000

Tax Value:					
Land 35%	6510	8750	8750	8750	8750
Bldg 35%	37390	41940	41940	41940	41940
Totl 35%	43900t	50690t	50690t	50690t	50690t
Hmstd35%					
Owner Oc					
Hmstd RB					
Net Tax	2084.40	2088.86	2209.58	2195.04	
Sp-Asmnt	31.48	31.48	34.48	34.48	

SHB+	CONS	TYPE	FACT	SQ-FT	VALUE				
1	F/C	M		1697		a	*MAIN		
	OPF	P		64	1920	b	PORCH		
	F2	G		432	10370	c	GRAGE		
	DK	P		300	4500	d	PORCH		

Sale#	#p	sale date	To	Type/Invalid?	Sale\$	co:land	co:blgd
110	1	2024-02-26	HEGE P HAROLD TRUSTEE OF	1QC *	0	25000	119830
109	1	2024-02-26	HEGE P HAROLD	1AF *	0	25000	119830
255	1	2006-05-01	HEGE P HAROLD & WILDA I	1SD	120000	0	0

Year	Land	Bldg	Total	Net Tax
2021	6510	37390	43900	2091.82
2020	6510	37390	43900	1821.82

Project	ben acres	/ %	factor
500 HARDIN COUNTY LANDFILL			XA/2025
105 RANGE - TYMOCHTEE			XA/2025
106 REELHORN - TYMOCHTEE			XA/2025
362 SANDERS DITCH-TYMOCHTEE			XA/2025
387 SANDERS DITCH			XA/2024

4

2

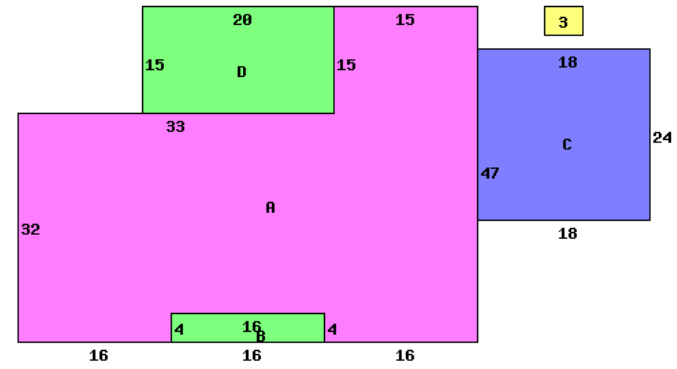

18437 SR 309 43326

Occupancy	1 Single Family	*DWELLING COMPUTATIONS
Story Height	1	Sq-Ft Value
Floor Level	Main	FRAME 1697 127120
Shingle	Subtotal	127120
	Roof	GABLE
	B 1 2 U A	

Bldg Type	SHB+Cons	DixHt	Unit	Grade	Blt/Renov	Replace	Phy	Fnc	True
1 DWELLING	1 F/C	1697		C	1967GD	148010	.35	Dpr	119300
2 Shed	*PP	10X12	120		1978AV	0			0
3 Shed		10X18	180	D	1980FR	1730	.70		520
4 POND	*.25AC		0		OLD/	0			0

Panelled Wall	X	Fireplaces	2000
Floor/Carpet	X	Plumbing	2100
Floor/Tile-Lino	L	Garages and Carports	10370
Number of Rooms	5	Extra Features	6420
Bedrooms	2	Total Value	148010

homesite	1.0000	effective	depth	actual	effective	extended	true
small acreage	2.0000	frontage	depth	rate	rate	value	value
				15000	15000	15000	15000
				5000	5000	10000	10000

Fireplace		PUB ELECTRIC	
Openings	1	PRIV WATER	
Stacks	1	PRIV SEWER	
Central Heat	A	PUB PAVED ST/RD	
ELECTRIC			
Plumbing		Neighborhood:	
Standard	1	Code:	1400
Extra 3 Fixture	1	Dwl/Gar/NC%	1.2400

Call Back:	Sign: PSN Date: 2015-05-11	Lister:	
------------	----------------------------	---------	--