

GOSHEN TWP 00130 Hardin County, Ohio Michael T. Bacon, Auditor 14-210015.0000 AGR 2025 KENTON SD

sale

Eff Rate:- 51.44 44.77 47.15 46.85 a/r

Table with columns for year (2022-2025), name (DETWEILER SAMUEL P & MA), address (10364 CR 195), and value (\$175,000).

Table with columns for Tax Year (2022-2025), Prop Cls, Acres, Land100%, Bldg100%, Totl100%, Cauv100%, Tax Value (Land 35%, Bldg 35%, Totl 35%, Hmstd35%), Owner Oc, Hmstd RB, Net Tax, Cauv Sav, Sp-Asmnt, and CAMA (111, 89960, 186250, 276210t, 49320).

Table with columns for SHB+, CONS, TYPE, FACT, SQ-FT, VALUE, and a \*MAIN (a \*MAIN, b PORCH, c PORCH, d PORCH, e GRAGE, f PORCH).

#: 2 L/W 142100020000 5.00a

Table with columns for Sale#, #p, sale date, To, Type/Invalid?, Sales\$, co:land, co:blgd.

Table with columns for Year, Land, Bldg, Total, Net Tax.

Project 106 REELHORN - TYMOCHTEE 500 HARDIN COUNTY LANDFILL XA/2025 XA/2025

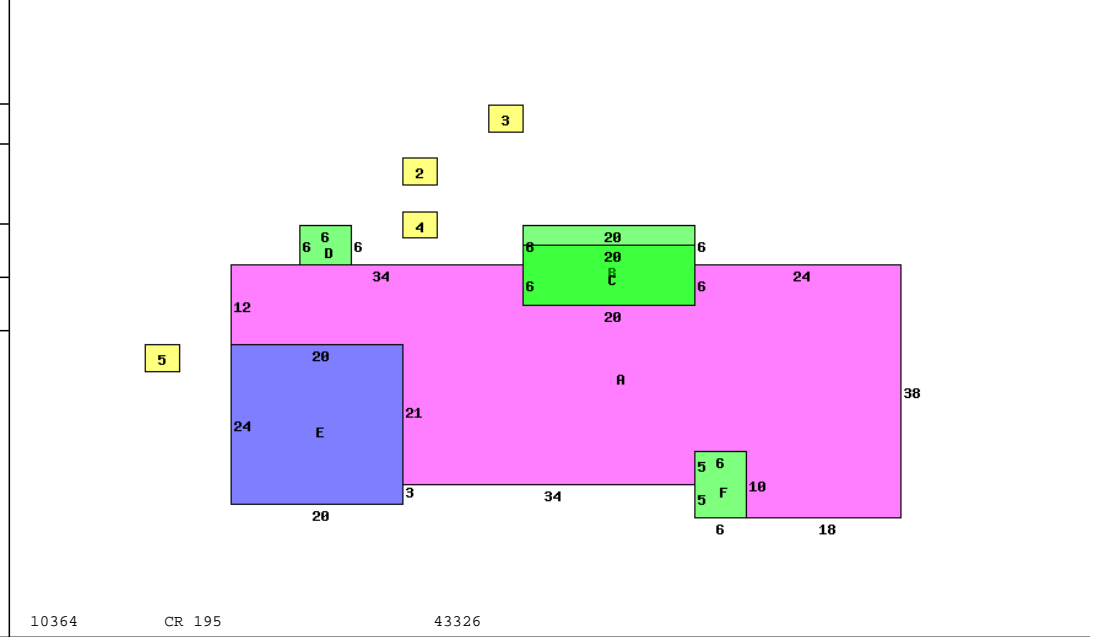

10364 CR 195 43326

Table with columns for Occupancy (1 Single Family), \*DWELLING COMPUTATIONS (Sq-Ft, Value), Story Height (1), Floor Level (Main, Subtotal, Shingle), and various fixtures (Plaster/Drywall, Fireplaces, Air Conditioning, Plumbing, etc.).

Table with columns for Bldg Type, SHB+Cons, DixHt, Area, Unit, Rate, Grade, Blt/Renov, Replace, Phy, Fnc, True Value, and a summary table with columns for Tab #, S O I L, Acres, Mkt/Ac, Market, Au/Ac, Cauv.