

GOSHEN TWP 00130 Hardin County, Ohio Michael T. Bacon, Auditor 14-210015.0000 C05 AGR 2025

sale

Eff Rate:- 51.44 44.77 47.15 46.85 a/r

Table with columns for year (2022-2025), name (DETWEILER SAMUEL P & MA), address (10364 CR 195), and value (\$175,000).

Table with columns for Tax Year (2022-2025), Prop Cls, Acres, Land100%, Bldg100%, Totl100%, Cauv100%, Tax Value (Land 35%, Bldg 35%, Totl 35%, Hmstd35%), Owner Oc, Hmstd RB, Net Tax, Cauv Sav, Sp-Asmnt.

Table with columns SHB+, CONS, TYPE, FACT, SQ-FT, VALUE, and a list of features (a-f) with their respective values.

#: 2 L/W 142100020000 5.00a

Table with columns Sale#, #p, sale date, To, Type/Invalid?, Sales\$, co:land, co:blgd.

Table with columns Year, Land, Bldg, Total, Net Tax.

Project 106 REELHORN - TYMOCHTEE 500 HARDIN COUNTY LANDFILL

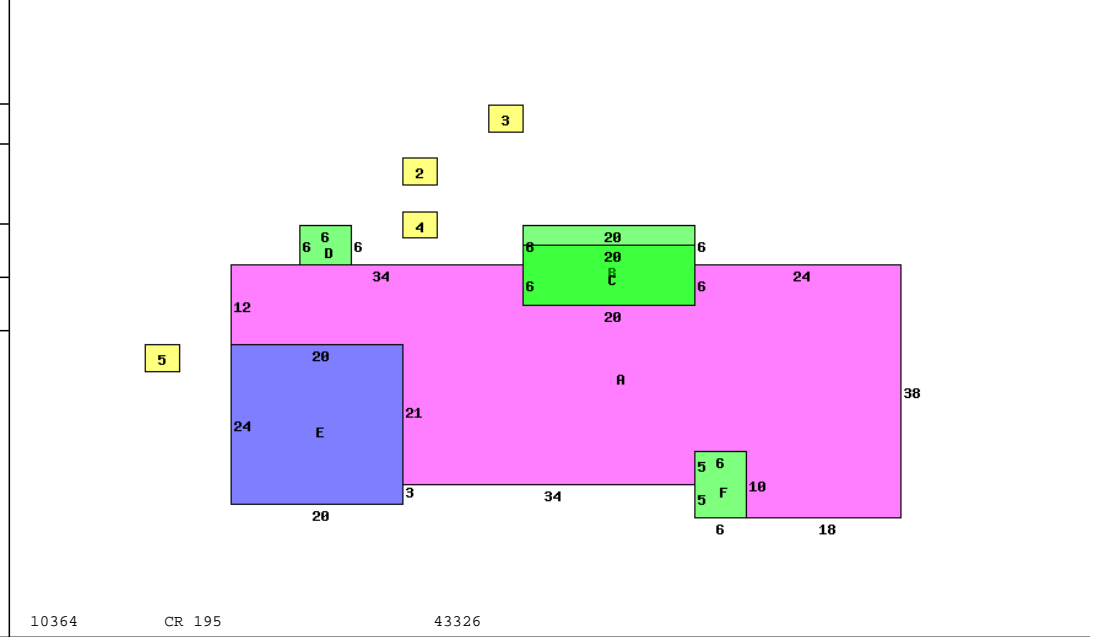

Table with columns Occupancy (1 Single Family), \*DWELLING COMPUTATIONS (Sq-Ft, Value), Story Height (1), Floor Level (Main, Subtotal, Shingle), and various fixtures (Plaster/Drywall, Fireplaces, etc.).

Table with columns Bldg Type, SHB+Cons, DixHt, Area, Unit, Rate, Grade, Bld/Renov, Replace, Phy, Fnc, True Value, and a summary row for CAUV # 3858.