

GOSHEN TWP 00130 Hardin County, Ohio Michael T. Bacon, Auditor 14-210012.0000 RES 2025 KENTON SD C88

sale

Eff Rate:- 51.44 44.77 47.15 46.85 a/r

Table with columns: Year, Owner Name, Address, Sale Price, Tax Value. Includes entries for 2022-2025 HASTINGS TIMOTHY A & KI.

Table with columns: Tax Year, Land 35%, Bldg 35%, Totl 35%, Hmstd35%, Owner Oc, Hmstd RB, Net Tax, Sp-Asmnt. Includes values for years 2022-2025.

Table with columns: SHB+, CONS, TYPE, FACT, SQ-FT, VALUE, a, *MAIN. Includes details for various lots and structures.

#: 14, L/W 142100140000 .071a

Table with columns: Sale#, #p, sale date, To, Type/Invalid?, Sale\$, co:land, co:bldg. Includes sales history for 541, 549, 107.

Table with columns: Year, Land, Bldg, Total, Net Tax. Includes data for years 2021 and 2020.

Table with columns: project, ben acres, / % factor. Includes projects like HARDIN COUNTY LANDFILL, SANDERS DITCH-TYMOCHTEE.

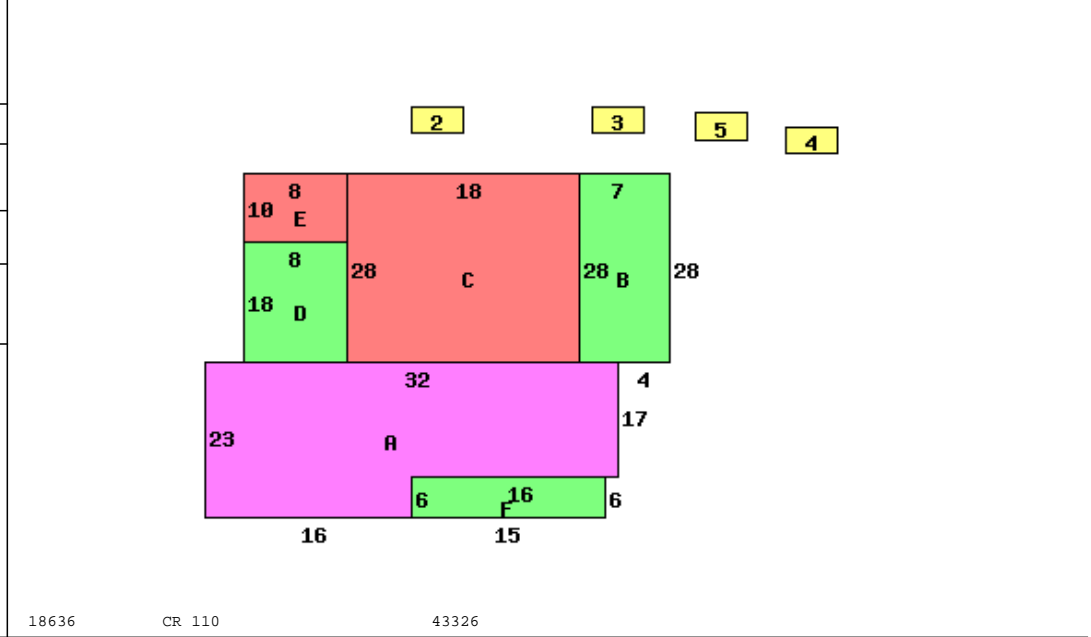

Table with columns: Occupancy, *DWELLING COMPUTATIONS, Sq-Ft, Value. Includes details for Single Family occupancy and building features like Attic Finish, PUB ELECTRIC.

Table with columns: Bldg Type, SHB+Cons, DixHt, Area, Unit Rate, Grade, Blt/Renov, Replace, Phy Dpr, Fnc Dpr, True Value. Includes details for Dwelling and Shed structures.

Table with columns: Plaster/Drywall, Floor/Pine, Number of Rooms, Bedrooms, Central Heat, FUEL OIL, Plumbing, Standard. Includes details for building materials and systems.

Table with columns: homesite, acres/frontage, effective frontage, depth, depth factor, actual rate, effective rate, extended value, true value. Includes site area and valuation details.