

GOSHEN TWP 00130 Hardin County, Ohio Michael T. Bacon, Auditor 14-210012.0000 RES 2023 KENTON SD

sale Eff Rate:- 45.49 51.61 51.44 44.77 a/r

Table with columns for year, name, address, and value. Includes entries for 2020-2023 Hastings Shirley E and Timothy A & KI.

Table with columns for Tax Year (2020-2023) and various tax categories like Land 35%, Bldg 35%, etc.

Table with columns SHB+, CONS, TYPE, FACT, SQ-FT, VALUE, and other details for property items.

Table with columns Sale#, #p, sale date, To, Type/Invalid?, Sale\$, co:land, co:blgd.

Table with columns Year, Land, Bldg, Total, Net Tax.

project 500 HARDIN COUNTY LANDFILL XA/2023 ben acres / % factor

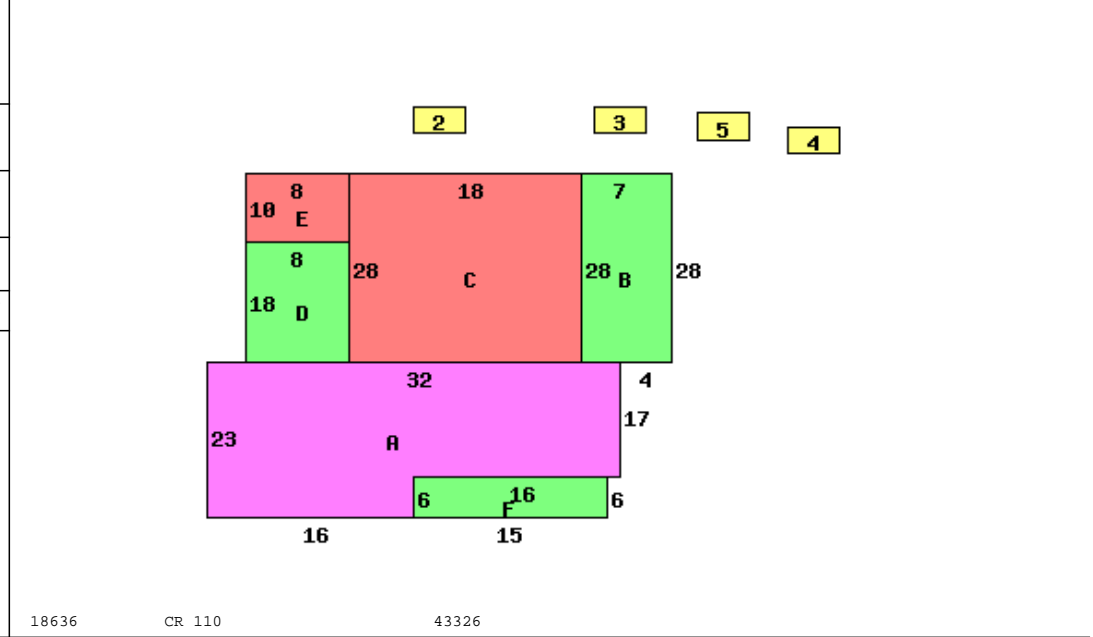

Table with columns for occupancy, story height, floor level, metal roof, and other building details.

Table with columns for Bldg Type, SHB+Cons, DixHt, Area, Unit Rate, Grade, Blt/Renov, Replace, Phy Dpr, Fnc Dpr, True Value.

Table with columns for Plaster/Drywall, Floor/Pine, Number of Rooms, Bedrooms, Central Heat, FUEL OIL, Plumbing, Standard.

Table with columns for homesite, acres/frontage, effective frontage, depth, depth factor, actual rate, effective rate, extended value, true value.