

GOSHEN TWP KENTON SD 00130 Hardin County, Ohio Michael T. Bacon, Auditor 14-210007.0000 C82 AGR 2025

sale

Eff Rate:- 51.44 44.77 47.15 46.85 a/r

Table with columns: Year, Land, Bldg, Total, Net Tax. Rows include 2022, 2023, 2024, 2025 for RALL PARRY J and 2027 for RALL PARRY J & 18241 CR 120.

Table with columns: Tax Year, Prop Cls, Acres, Land100%, Bldg100%, Totl100%, Cauv100%, Tax Value, Hmstd35%, Owner Oc, Hmstd RB, Net Tax, Cauv Sav, Sp-Asmnt. Rows include 2022, 2023, 2024, 2025.

Table with columns: Sale#, #p, sale date, To, Type/Invalid?, Sale\$, co:land, co:bldg. Rows include 184, 132, 542, 538, 123, 115, 256, 255.

12-4-2013 ETAL REFERS TO VAUGHN R & SUSAN M RALL MOBILE HOME ACCT: 14-0241 TITLE: 3300343671 2013 GILES. Includes a site plan with numbered markers 1, 2, 4, 5, 6, 7.

Table with columns: Year, Land, Bldg, Total, Net Tax. Rows include 2021, 2020. Also includes project information for REELHORN - TYMOCHTEE and HARDIN COUNTY LANDFILL.

Table with columns: PUB ELECTRIC, PRIV WATER, PRIV SEWER, PUB PAVED ST/RD, Neighborhood, Code, Dwl/Gar/NC%. Includes details for 1400 and 1.2400.

Table with columns: Bldg Type, SHB+Cons, DixHt, Area, Unit Rate, Grade, Blt/Renov, Cond, Replace Value, Phy Dpr, Fnc Dpr, True Value. Rows include 1 MH/LRE, 2 Garage, 4 Dairy Barn, 5 Pole Build, 6 Silo, 7 Pole Build.

18241 CR 120 43326 20.101 124850 (100%) 63310 CAUV # 4187 43700 (35%) 22160

Call Back: Sign: PSN Date: 2015-05-11 Lister: 14-210007.0000-v082020R

CAMA / Cont: 1

SHB+	CONS	TYPE	FACT	SQ-FT	VALUE		
1HB	F	M		1024		a	*MAIN
1	F/C	A		144		b	ADDTN
	OFFP	P		70	2100	c	PORCH
H	F	G		20	480	d	GRAGE
1HB	F	M		1024		e	*MAIN

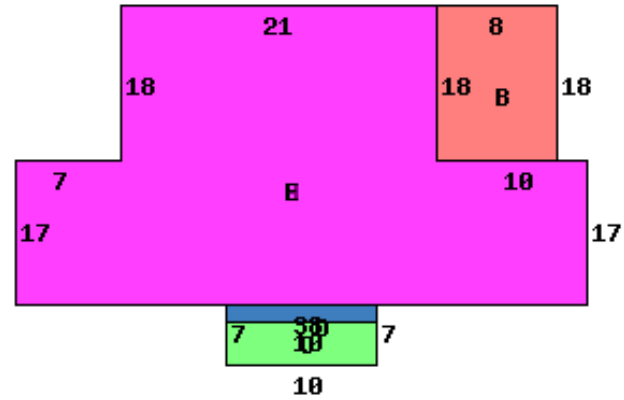

18241 CR 120 43326

Occupancy 1 Single Family		*DWELLING COMPUTATIONS	
Story Height	1H	Sq-Ft	Value
Floor Level	Main	FRAME	2192 148000
	Part Upper	FRAME	2068 52030
	Basement		2048 37750
	Subtotal		237780
Shingle	Roof	GABLE	
	B 1 2 U A		
Plaster/Drywall	P P	Heating	-4880
Panelled Wall	X	Plumbing	-3800
Unfinished Wall	X	Garages and Carports	480
Floor/Carpet	X X	Extra Features	2100
Floor/Concrete	X	Total Value	231680
Number of Rooms	1 5 2		
Bedrooms	2		

Bldg Type	SHB+Cons	DixHt	Area	Unit	Grade	Blt/Renov	Replace	Phy	Fnc	True
8 DWELLING	1HB F	FtxFt	4260	Rate	C	1926VP	231680	.85	.95	2160

Call Back: - - - - Sign: Date: Lister: 14-210007.0000-v082020R