

GOSHEN TWP KENTON SD 00130 Hardin County, Ohio Michael T. Bacon, Auditor 14-200017.0000 C97 AGR 2025

sale

Eff Rate:- 51.44 44.77 47.15 46.85 a/r

Table with columns: Year, Range, Name, Date, Area, Value. Includes entries for 2022-2025 Ranges and KENTON OH 43326.

Table with columns: Tax Year, Prop Cls, Acres, Land100%, Bldg100%, Totl100%, Cauv100%, Tax Value, Land 35%, Bldg 35%, Totl 35%, Hmstd35%, Owner Oc, Hmstd RB, Net Tax, Cauv Sav, Sp-Asmnt. Includes values for years 2022-2025.

Table with columns: SHB+, CONS, TYPE, FACT, SQ-FT, VALUE. Lists various property features and their values.

Table with columns: Sale#, #p, sale date, To, Type/Invalid?, Sale\$, co:land, co:bldg. Shows sale history for 446 and 355.

Table with columns: Year, Land, Bldg, Total, Net Tax. Shows tax data for years 2021 and 2020.

Table with columns: Project, Range, Name, Date, Acres, Factor. Lists project details for 105, 500, 362, and 387.

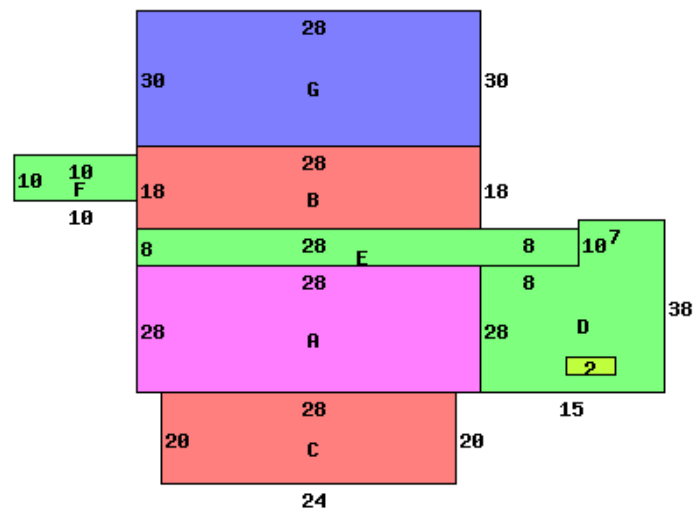

19133 CR 120 43326

Table with columns: Occupancy, *DWELLING COMPUTATIONS, Sq-Ft, Value. Includes details for Single Family occupancy and various construction items like Air Conditioning, Plumbing, etc.

Table with columns: Bldg Type, SHB+Cons, DixHt, Area, Unit Rate, Grade, Blt/Renov, Replace, Phy Fnc, True Value. Includes details for DWELLING and POND.

Table with columns: Tab #, S O I L, Acres, Mkt/Ac, Market, Au/Ac, Cauv. Includes details for soil types and market values.