

GOSHEN TWP 00130 Hardin County, Ohio Michael T. Bacon, Auditor 14-200016.0000 RES 2025 KENTON SD

sale

Eff Rate:- 51.44 44.77 47.15 46.85 a/r

Table with columns: Year, Property Description, SQ-FT, VALUE, and other details for Lawrence Robert L & D and Lawrence Deborah A.

Table with columns: Tax Year, Prop Cls, Acres, Land100%, Bldg100%, Totl100%, Cauv100%, Tax Value, and other tax-related metrics.

Table with columns: SHB+, CONS, TYPE, FACT, SQ-FT, VALUE, and other structural details.

Table with columns: Sale#, #p, sale date, To, Type/Invalid?, Sale\$, co:land, co:bldg.

Table with columns: Year, Land, Bldg, Total, Net Tax.

Table with columns: project, HARDIN COUNTY LANDFILL, SANDERS DITCH-TYMOCHTEE, SANDERS DITCH, and other project details.

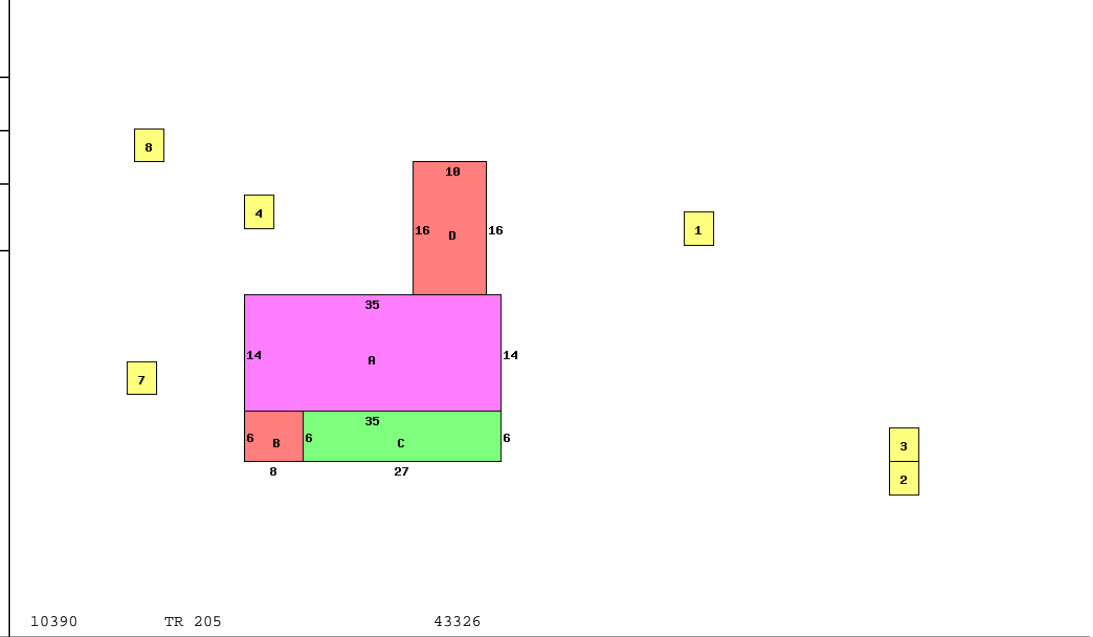

Table with columns: Occupancy, *DWELLING COMPUTATIONS, Sq-Ft, Value, and other occupancy-related details.

Table with columns: Bldg Type, SHB+Cons, DixHt, Area, Unit Rate, Grade, Blt/Renov, Replace, Phy Fnc, True Value.

Table with columns: homesite, small acreage, effective frontage, depth, actual rate, effective rate, extended value, true value.

Table with columns: Neighborhood, Code, Dwl/Gar/NC%, and other neighborhood-related details.