

GOSHEN TWP 00130 Hardin County, Ohio Michael T. Bacon, Auditor 14-200009.0000 RES 2025 KENTON SD

sale

Eff Rate:- 51.44 44.77 47.15 46.85 a/r

Table with columns for year (2022-2025), description (WILSON CARRIE K), date (2018-05-07), and value (\$86,000).

Table with columns for Tax Year (2022-2025), Prop Cls, Acres, Land100%, Bldg100%, Totl100%, and Cauv100%. Includes Tax Value and Net Tax.

Table with columns SHB+, CONS, TYPE, FACT, SQ-FT, VALUE, and various codes (a-h).

Table with columns Sale#, #p, sale date, To, Type/Invalid?, Sales\$, co:land, co:blgd.

Table with columns Year, Land, Bldg, Total, Net Tax.

Table with columns project, ben acres, and % factor.

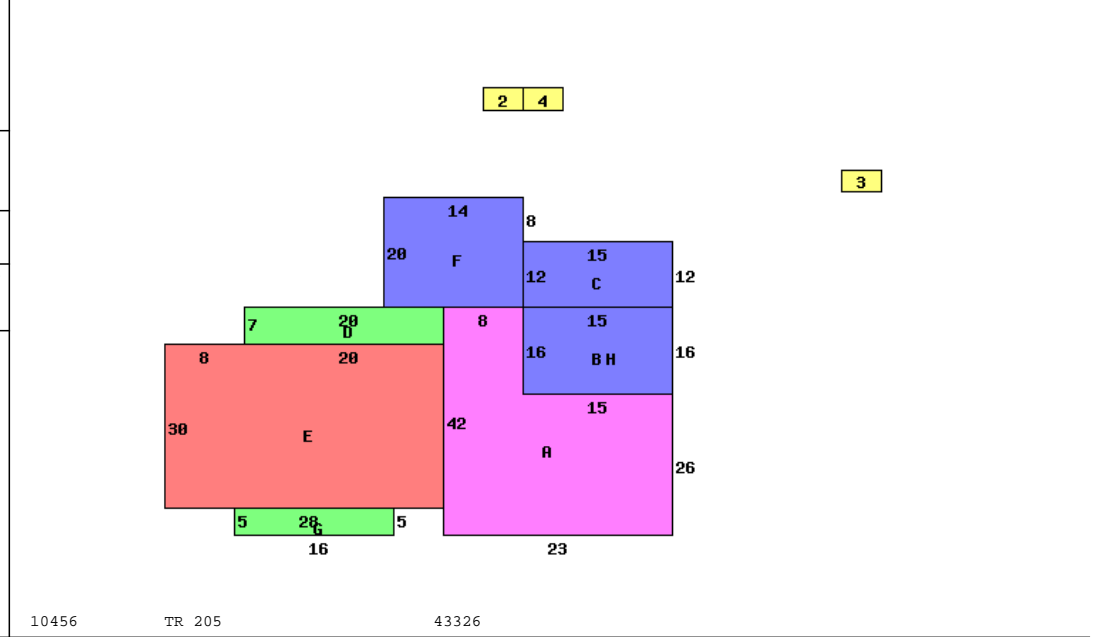

Table with columns Occupancy, *DWELLING COMPUTATIONS, Sq-Ft, Value, and various building details.

Table with columns Bldg Type, SHB+Cons, DixHt, Area, Unit Rate, Grade, Blt/Renov, Replace, Phy Dpr, Fnc Dpr, True Value, and various building details.