

GOSHEN TWP KENTON SD 00130 Hardin County, Ohio Michael T. Bacon, Auditor 14-190014.0000 RES 2025 E20

sale

Eff Rate:- 51.44 44.77 47.15 46.85 a/r

Table with columns for year (2022-2025), name (JUSTICE MARY), address (20161 CR 120), and value (\$0).

Table with columns for Tax Year (2022-2025), Prop Cls, Acres, Land100%, Bldg100%, Totl100%, and Cauv100%. Includes Tax Value breakdown and Net Tax.

Table with columns for SHB+ (2 BA), CONS (F, OFP, DK), TYPE (M, P, A), FACT, SQ-FT, VALUE, and other details.

Table with columns for Sale#, #p, sale date, To JUSTICE MARY, Type/Invalid?, Sale\$, co:land, co:blgd.

Table with columns for Year (2021-2022), Land, Bldg, Total, Net Tax.

Project 500 HARDIN COUNTY LANDFILL XA/2025 ben acres / % factor

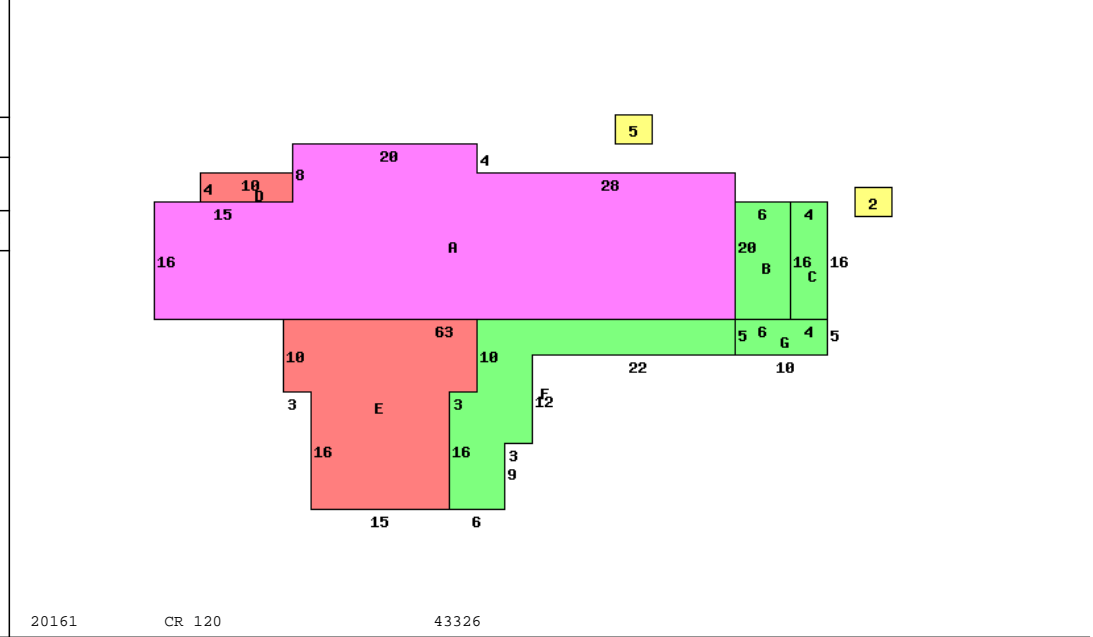

Table with columns for Occupancy (Single Family), \*DWELLING COMPUTATIONS (Sq-Ft, Value), and various features like Air Conditioning, PUB ELECTRIC, etc.

Table with columns for Bldg Type, SHB+Cons, DixHt, Area, Unit, Rate, Grade, Blt/Renov, Replace, Phy, Fnc, True Value.

Table with columns for homesite, small acreage, acres/frontage, effective frontage, depth, depth factor, actual rate, effective rate, extended value, true value.