

GOSHEN TWP 00130 Hardin County, Ohio Michael T. Bacon, Auditor 14-190011.0000 E17 AGR 2025

sale

Eff Rate:- 51.44 44.77 47.15 46.85 a/r

Table with columns for year, date, and property description (SHICK FARMS FAMILY LI, etc.)

Table with columns for Tax Year (2022-2025), Prop Cls, Acres, Land100%, Bldg100%, Totl100%, Cauv100%, Tax Value, and various percentages.

Table with columns for SHB+, L B, CONS, TYPE, FACT, SQ-FT, VALUE, and other details.

#: 12, L/W 141900120000 55.997a

Table with columns for Sale#, #p, sale date, To, Type/Invalid?, Sales\$, co:land, co:bldg

Table with columns for Year, Land, Bldg, Total, Net Tax

Table with columns for Project, address, and factor

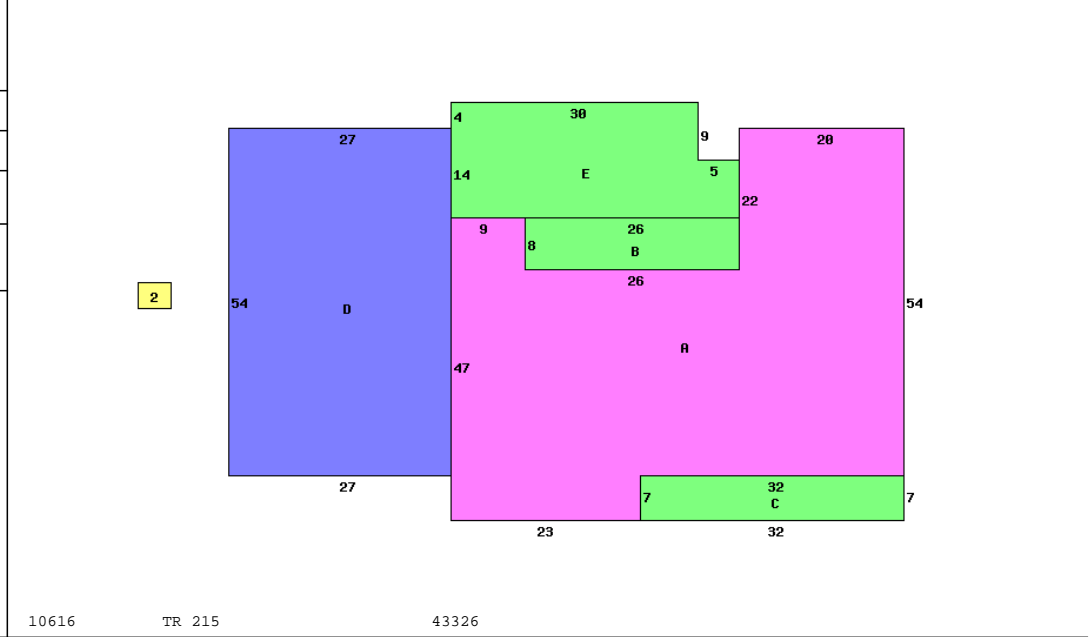

Table with columns for Occupancy, Story Height, Floor Level, Shingle, and Dwelling Computations (Sq-Ft, Value).

Table with columns for Bldg Type, SHB+Cons, DixHt, Area, Unit Rate, Grade, Blt/Renov, Replace, Phy Dpr, Fnc Dpr, True Value, and other details.

Call Back: Sign: PSN Date: 2015-05-18 Lister: 14-190011.0000-v082020R