

GOSHEN TWP 00130 Hardin County, Ohio Michael T. Bacon, Auditor 14-190011.0000 E17 AGR 2025

sale

Eff Rate:- 51.44 44.77 47.15 46.85 a/r

Table with columns for year (2022-2025), address (SHICK FARMS FAMILY LI, SHICK FARMS FAMILY LIMI), and value (\$0).

Table with columns for Tax Year (2022-2025), Prop Cls, Acres, Land100%, Bldg100%, Totl100%, Cauv100%, Tax Value (Land 35%, Bldg 35%, Totl 35%), Hmstd35%, Owner Oc, Hmstd RB, Net Tax, Cauv Sav, Sp-Asmnt, and CAMA (111, 111, 458420, 303480, 761900t, 227110).

Table with columns for SHB+ (1 B), CONS (F, OFF, F, PAT), TYPE (M, P, G, P), FACT (2433, 208, 224, 1458, 585), SQ-FT (2433, 208, 224, 1458, 585), VALUE (6240, 6720, 34990, 1760), and a \*MAIN (a, b, c, d, e).

#: 12, L/W 141900120000 55.997a

Table with columns for Year (2021, 2020), Land (42820), Bldg (96500), Total (139320), and Net Tax (6130.32, 5326.62).

Table with columns for project (500, 362, 387) and ben acres / % factor.

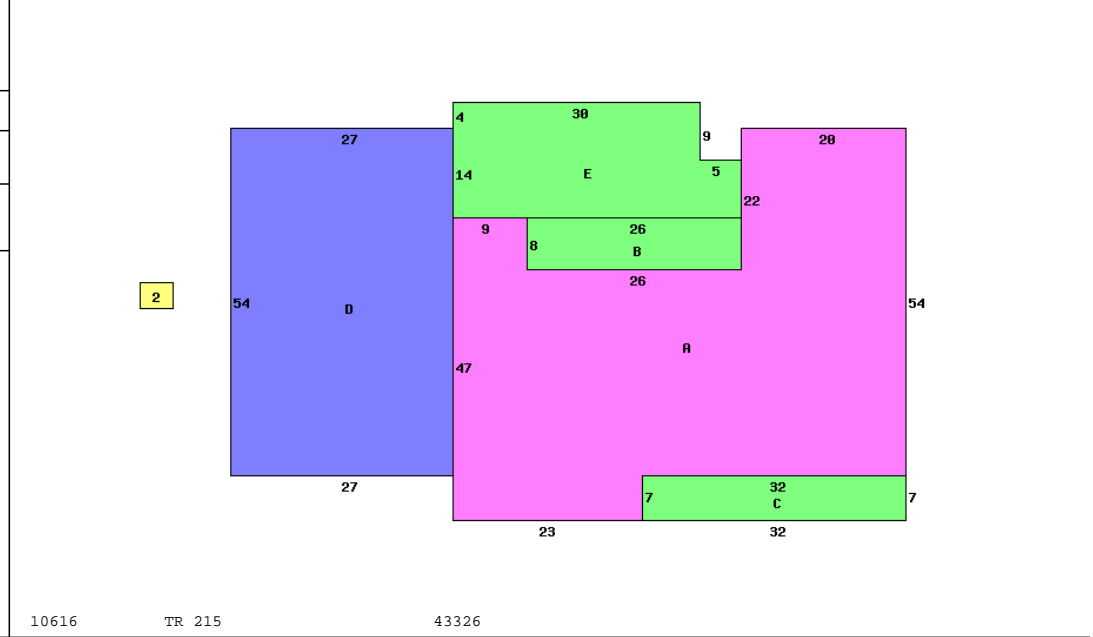

10616 TR 215 43326

Table with columns for Occupancy (1 Single Family), \*DWELLING COMPUTATIONS (Sq-Ft, Value), Story Height (1), Floor Level (Main, Basement, Subtotal, Roof), Shingle (B 1 2 U A), Plaster/Drywall, Unfinished Wall, Floor/Carpet, Floor/Concrete, Number of Rooms (6 Bedrooms), Central Heat (FORCED AIR, Central A/C), Plumbing (Standard, Extra 3 Fixture, Extra 2 Fixture), and PUB ELECTRIC, PRIV WATER, PRIV SEWER, PUB PAVED ST/RD, Neighborhood: Code: 1400, Dwl/Gar/NC% 1.2400.

Table with columns for Bldg Type (1 DWELLING, 2 Shed), SHB+Cons (1 B F, \*PP), DixHt (8X14), Area (2433, 112), Unit Rate, Grade (C+), Blt/Renov (2004GD, OLD/), Replace Value (291360, 0), Phy Dpr (.16), Fnc Dpr, True Value (303480, 0), Tab # (C 1, C 2, C 39, W 1, W 2, W 39, 670, 980), S O I L (BOA BLOUNT SILT LOAM 0-, BOB BLOUNT SILT LOAM, 2, PM PEWAMO SILTY CLAY L, BOA BLOUNT SILT LOAM 0-, BOB BLOUNT SILT LOAM, 2, PM PEWAMO SILTY CLAY L, HSITE HOMESITE, ROAD ROAD), Acres (29.3246, 2.9803, 32.6860, 1.3505, .7680, 5.5828, 1.0000, .3048), Mkt/Ac (6030, 5770, 6490, 3610, 3130, 5370, 15000), Market (176830, 17200, 212130, 4880, 2400, 29980, 15000), Au/Ac (2660, 2360, 3560, 770, 470, 1670, 15000), Cauv (78000, 7030, 116360, 1040, 360, 9320, 15000), and CAUV # 1096.