

GOSHEN TWP KENTON SD 00130 Hardin County, Ohio Michael T. Bacon, Auditor 14-190007.0000 RES 2025 E23

sale

Table with columns for year (2022-2025), name (SHERMAN TYE ANDREW JO, JOSE), address (20857 CR 120), and value (\$160,000).

Table with columns for Eff Rate (51.44, 44.77, 47.15, 46.85), Tax Year (2022-2025), Prop Cls, Acres, Land100%, Bldg100%, Totl100%, Cauv100%, Tax Value (Land, Bldg, Totl 35%, Hmstd35%, Owner Oc, Hmstd RB, Net Tax), and Sp-Asmnt (18.00).

Table with columns for SHB+ (1 B), CONS (F, F2, STP, OFP, RFP, OFP), TYPE (M, G, P, P, P, P), FACT (2104, 576, 24, 150, 308, 172), SQ-FT (2104, 576, 24, 150, 308, 172), VALUE (13820, 13820, 100, 4500, 12320, 5160), and a *MAIN (a-f).

Table with columns for Sale#, #p, sale date, To (SHERMAN TYE ANDREW JOSEPH, HEILMAN DONNA L), Type/Invalid?, Sale\$, co:land, co:blgd.

Table with columns for Year (2021, 2020), Land (6510), Bldg (49720), Total (56230), Net Tax (2625.74, 1925.10).

Project 500 HARDIN COUNTY LANDFILL ben acres / % factor

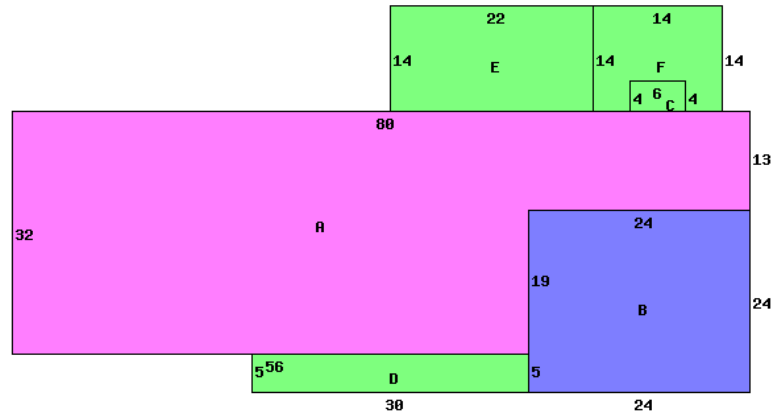

20857 CR 120 43326

Table with columns for Occupancy (1 Single Family), *DWELLING COMPUTATIONS (Sq-Ft, Value), and various building details like Fireplaces, Plumbing, Garages, etc.

Table with columns for Bldg Type (1 DWELLING), SHB+Cons (1 B F), DixHt (2104), Area (2104), Unit Grade (C), Blt/Renov (OLD/GD), Replace Value (222880), Phy Dpr (15000), Fnc Dpr (15000), True Value (15000).