

GOSHEN TWP 00130 Hardin County, Ohio Michael T. Bacon, Auditor 14-190001.0000 AGR 2025 KENTON SD E15

sale

Eff Rate:- 51.44 44.77 47.15 46.85 a/r

Table with columns for year (2022-2025), description (PFEIFFER WILLIAM W & JU), and value (\$0).

Table with columns for Tax Year (2022-2025), Prop Cls, Acres, Land100%, Bldg100%, Totl100%, Cauv100%, Tax Value, and various percentages.

Table with columns for SHB+ (1HB, 1H), CON (F, OFP, F/C, STP, CAN), TYPE (M, P, A, P), FACT (972, 90, 504, 56, 56), SQ-FT (2700, 504, 220, 450), and VALUE (2700, 504, 220, 450).

ck06 for compl of pole bldg and remvl of old outbldgs and old dwlg and a new dwlg built

Table with columns for Sale#, #p, sale date, To, Type/Invalid?, Sales, co:land, co:blgd.

Table with columns for Year, Land, Bldg, Total, Net Tax.

Table with columns for project (500, 362, 387), location (HARDIN COUNTY LANDFILL, SANDERS DITCH-TYMOCHTEE, SANDERS DITCH), and date (XA/2025).

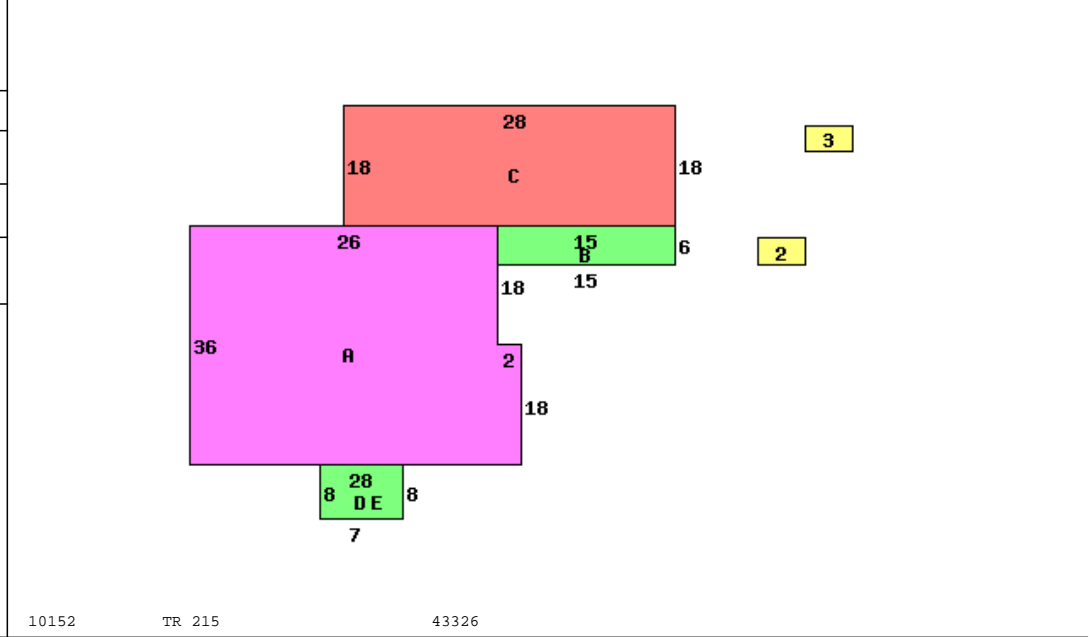

Table with columns for Occupancy (1 Single Family), \*DWELLING COMPUTATIONS (Sq-Ft, Value), and various building details like Story Height, Floor Level, Metal Roof, etc.

Table with columns for Bldg Type, SHB+Cons, DixHt, Area, Unit Rate, Grade, Blt/Renov, Replace, Phy, Fnc, True Value, and other building specifications.