

GOSHEN TWP 00130 Hardin County, Ohio Michael T. Bacon, Auditor 14-190001.0000 AGR 2025 KENTON SD E15

sale

Eff Rate:- 51.44 44.77 47.15 46.85 a/r

Table with columns for year (2022-2025), name (PFEIFFER WILLIAM W & JU), address (10152 TR 215), and value (\$0).

Table with columns for Tax Year (2022-2025), Prop Cls, Acres, Land100%, Bldg100%, Totl100%, Cauv100%, Tax Value (Land 35%, Bldg 35%, Totl 35%), Hmstd35%, Owner Oc, Hmstd RB, Net Tax, Cauv Sav, Sp-Asmnt, and CAMA (111).

Table with columns for SHB+ (1HB, 1H), CONS (F, OFP, F/C, STP, CAN), TYPE (M, P, A, P, P), FACT (972, 90, 504, 56, 56), SQ-FT (2700, 90, 504, 220, 450), VALUE (2700, 90, 504, 220, 450), and a \*MAIN (a, b, c, d, e).

ck06 for compl of pole bldg and remvl of old outbldgs and old dwlg and a new dwlg built

Table with columns for Sale# (46, 88), #p (3, 0), sale date (2007-02-02, 1988-02-10), To (PFEIFFER WILLIAM W & JUL), Type/Invalid? (3SD, \*), Sale\$ (0, 65000), co:land (173060, 0), co:blgd (107940, 125200).

Table with columns for Year (2021, 2020), Land (45360, 45360), Bldg (48280, 48280), Total (93640, 93640), Net Tax (4018.44, 3496.18).

Table with columns for project (500 HARDIN COUNTY LANDFILL, 362 SANDERS DITCH-TYMOCHTEE, 387 SANDERS DITCH), ben acres, and % factor.

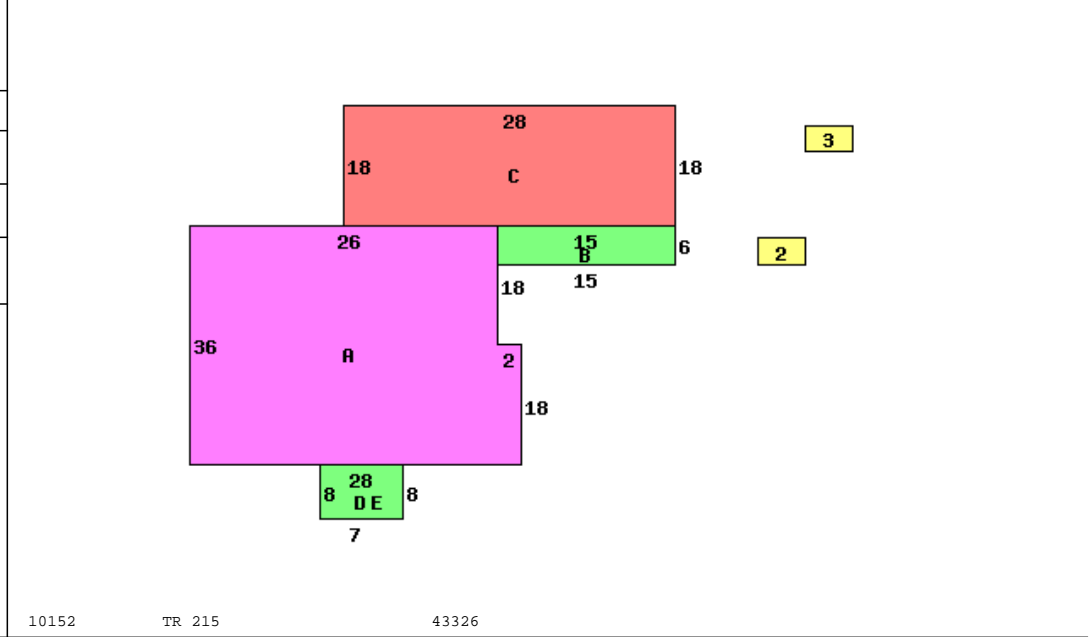

10152 TR 215 43326

Table with columns for Occupancy (1 Single Family), \*DWELLING COMPUTATIONS (Sq-Ft, Value), Story Height (1H), Floor Level (Main, Part Upper, Basement, Subtotal), Metal Roof (GABLE), Plaster/Drywall, Unfinished Wall, Floor/Hardwood, Floor/Pine, Floor/Carpet, Number of Rooms (1 6 3 Bedrooms), Central Heat (FORCED AIR), Plumbing (Standard).

Table with columns for Bldg Type (1 DWELLING, 2 Garage, 3 Pole Build), SHB+Cons (1HB F), DixHt (2952, 14X26, 135X70), Area (9450), Unit Rate, Grade (C, D, C), Blt/Renov (1928GD, OLD/FR, 2005AV), Replace Value (171750, 6990, 113400), Phy Dpr (.40, .70, .50), Fnc Dpr, True Value (127780, 2600, 56700), Tab # (C 1, C 2, C 39, 670, 980), S O I L (BLOUNT SILT LOAM, BOB BLOUNT SILT LOAM, PM PEWAMO SILTY CLAY L, HSITE HOMESITE, ROAD ROAD), Acres (22.1663, 22.9803, 31.3706, 1.0000, 2.4828), Mkt/Ac (6030, 5770, 6490, 15000, 15000), Market (133660, 132600, 203600, 15000, 15000), Au/Ac (2660, 2360, 3560, 15000, 15000), Cauv (58960, 54230, 111680, 15000, 15000), 80, 484860 (100%), 169700 (35%), 239870, 83950, CAUV # 773.