

GOSHEN TWP 00130 Hardin County, Ohio Michael T. Bacon, Auditor 14-180023.0000 RES 2023 KENTON SD E10.01

sale

Table with columns for year (2020-2023), description (WATKINS MARSHA HEILMA, AMWEG ELMER RAYMOND S), and value (\$0).

Table with columns for Orig Tax Year (2021), Parent (14-180001.0000), and other tax-related details.

Table with columns for Eff Rate (45.49, 51.61, 51.44, 44.77), Tax Year (2020-2023), and various tax values.

Table with columns for SHB+ (1 B), CONS (F, DK, EFP, F2), TYPE (M, P), FACT (1400, 32, 143, 676), SQ-FT (1400, 480, 5720, 16220), and VALUE (1400, 480, 5720, 16220).

Table with columns for Sale# (308, 32), #p (1), sale date (2020-08-06, 0001-01-01), To (AMWEG ELMER RAYMOND SR & WATKINS MARSHA HEILMAN ET), Type/Invalid? (LSD *), Sale\$ (0), co:land (0), and co:bldg (0).

project 500 HARDIN COUNTY LANDFILL XA/2023 ben acres / % factor

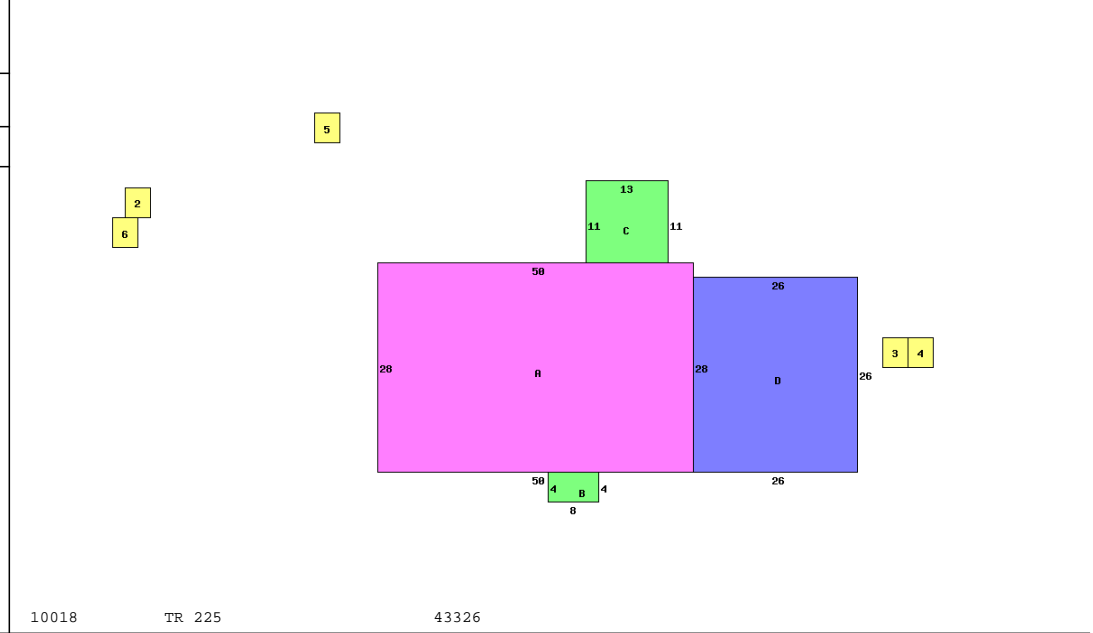

Table with columns for Occupancy (1 Single Family), *DWELLING COMPUTATIONS (Sq-Ft, Value), and various building details like Story Height, Floor Level, Metal, etc.

Table with columns for Bldg Type (1 DWELLING, 2 Shed, 3 Shed, 4 Shed, 5 Shed, 6 Shed), SHB+Cons (1 B F, *PP), DixHt (10X12, 10X15, 30X30, 14X20), Area (1400, 120, 1000, 150, 900, 280), Unit Rate, Grade (C-, D, D), Blt/Renov Cond (1991AV, OLD/, 2010AV, 2017AV, 2020AV), Replace Value (145610, 0, 9600, 1440, 8640, 2690), Phy Dpr (.26, .40, .20, .15), Fnc Dpr, True Value (133610, 0, 5760, 860, 6910, 2290).

Table with columns for homesite (1.0000), small acreage (2.0010), effective frontage (15000, 5000), depth (15000, 5000), actual rate (15000, 5000), effective rate (15000, 5000), extended value (15000, 10010), and true value (15000, 10010).