

GOSHEN TWP 00130 Hardin County, Ohio Michael T. Bacon, Auditor 14-170023.0000 RES 2025 KENTON SD

sale

Eff Rate:- 51.44 44.77 47.15 46.85 a/r

Table with columns: Year, SQ-FT, VALUE, a, *MAIN, b, GRAGE, c, ADDTN, d, ADDTN, e, PORCH. Rows for 2022-2025.

Table with columns: Tax Year, Prop Cls, Acres, Land100%, Bldg100%, Totl100%, Cauv100%. Rows for 2022-2025.

Orig Tax Year 2021 Parent: 14-170004.0000

Table with columns: Tax Value, Land 35%, Bldg 35%, Totl 35%, Hmstd35%, Owner Oc, Hmstd RB, Net Tax, Sp-Asmnt. Rows for 2022-2025.

Table with columns: SHB+, CONS, TYPE, FACT, SQ-FT, VALUE, a, *MAIN, b, GRAGE, c, ADDTN, d, ADDTN, e, PORCH. Rows for 2021-2022.

Table with columns: Sale#, #p, sale date, To, HEILMAN J DOUGLAS, Type/Invalid?, Sales\$, co:land, co:bldg. Row for 2020-01-30.

Table with columns: Year, Land, Bldg, Total, Net Tax. Rows for 2021-2022.

Project 500 HARDIN COUNTY LANDFILL XA/2025 ben acres / % factor

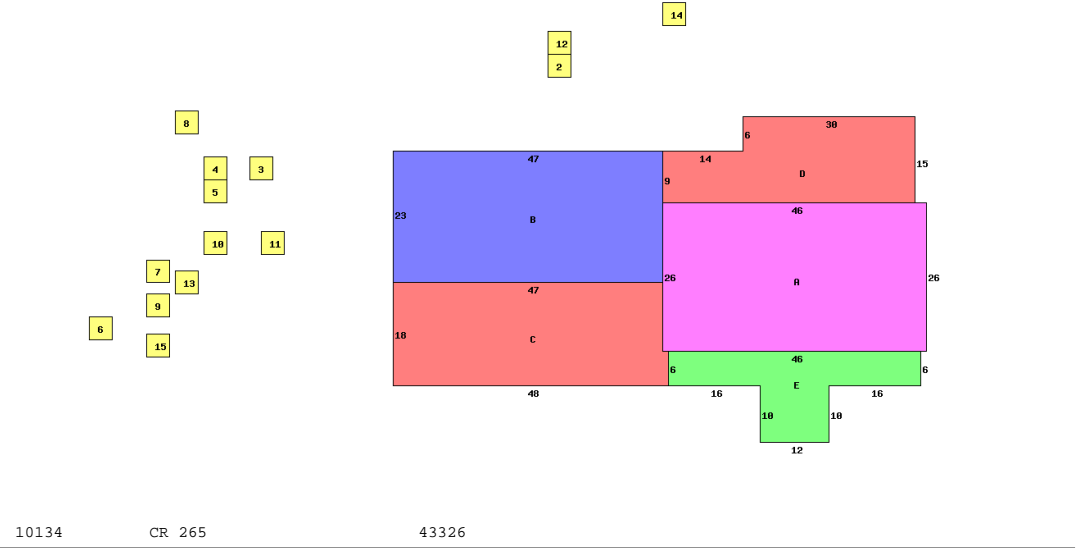

Table with columns: Occupancy, *DWELLING COMPUTATIONS, Sq-Ft, Value. Rows for Single Family, Story Height, Floor Level, Metal, Plaster/Drywall, etc.

Table with columns: Bldg Type, SHB+Cons, DixHt, Area, Unit Rate, Grade, Blt/Renov, Replace, Phy, Fnc, True Value. Rows for 1 DWELLING, 2 Pole Build, 3 Shed, etc.

Table with columns: homesite, small acreage, road, acres/ frontage, effective depth, depth factor, actual rate, effective rate, extended value, true value. Rows for 1.0000, 15.1736, .3904.