

GOSHEN TWP 00130 Hardin County, Ohio Michael T. Bacon, Auditor 14-110019.0000 RES 2025 KENTON SD

sale

Table with columns: Year, Sale#, Date, To, Type/Invalid, Sale\$, Co:land, Co:blgd. Includes entries for 2022, 2023, 2024, 2025.

Table with columns: Tax Year, Prop Cls, Acres, Land100%, Bldg100%, Totl100%, Cauvl00%, Tax Value, Net Tax, Sp-Asmnt. Includes values for years 2022-2025.

Table with columns: Orig Tax Year, Parent, Tax Value, Net Tax, Sp-Asmnt. Includes values for 2002 and 14-110003.0000.

Table with columns: SHB+, CON, TYPE, FACT, SQ-FT, VALUE, a, \*MAIN, b, ADDTN, c, PORCH, d, PORCH, e, PORCH.

Table with columns: Year, Land, Bldg, Total, Net Tax. Includes data for 2021 and 2020.

Table with columns: Project, Acres, Factor. Includes entries for HARDIN COUNTY LANDFILL, OBORN-TYMOCHTEE, SANDERS DITCH, SANDERS DITCH-TYMOCHTEE.

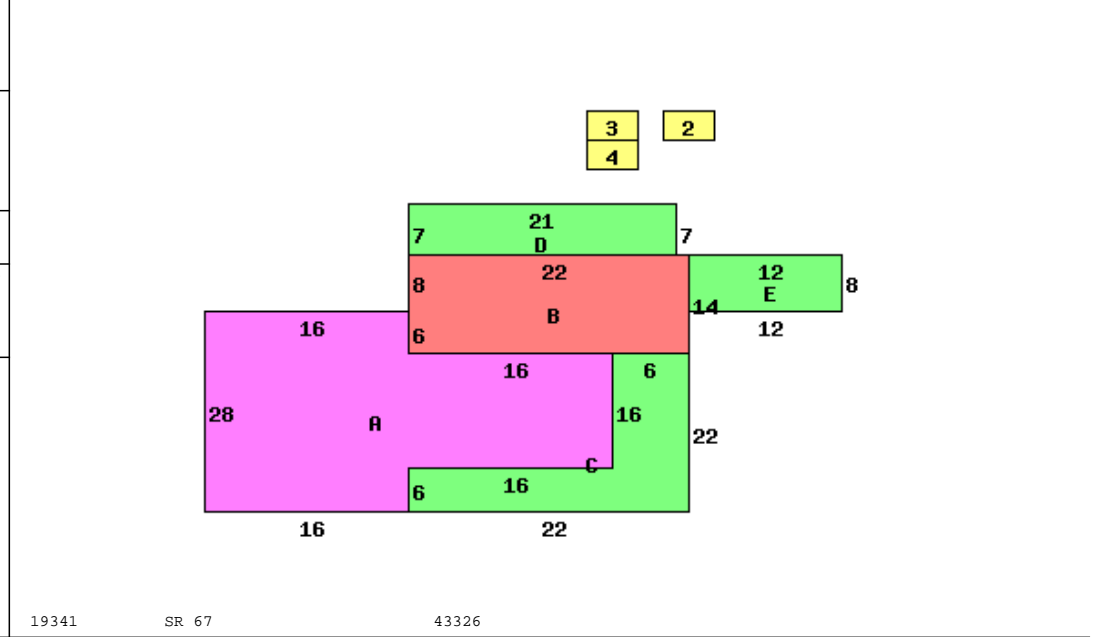

Table with columns: Occupancy, Story Height, Floor Level, Main, Part Upper, Subtotal, Shingle, Roof, GABLE, Plaster/Drywall, Floor/Hardwood, Number of Rooms, Bedrooms, Central Heat, Heat Pump, Central A/C, Plumbing, Standard.

Table with columns: Bldg Type, SHB+Cons, DixHt, Area, Unit Rate, Grade, Blt/Renov, Replace, Phy, Fnc, True Value, homesite, small acreage, effective frontage, depth, actual, effective, extended, true value.