

GOSHEN TWP 00130 Hardin County, Ohio Michael T. Bacon, Auditor 14-110019.0000 RES 2025 KENTON SD B46

sale

Table with columns for year, name, address, and value. Includes entries for 2022-2025 MARKLEY GREGORY D and KENTON OH 43326.

Table with columns for Eff Rate, Tax Year, Prop Cls, Acres, Land100%, Bldg100%, Totl100%, Cauvl00%, Tax Value, and Sp-Asmnt. Includes values for 2022-2025.

Table with columns for SHB+, CON, TYPE, FACT, SQ-FT, VALUE, and other details. Includes entries for 1H, 1, 1, 1, 1, 1, 1, 1, 1, 1.

Table with columns for Sale#, #p, sale date, To, Type/Invalid?, Sale\$, co:land, co:bldg. Includes entries for 17, 192, 693, 347, 234, 721, 558.

Table with columns for Year, Land, Bldg, Total, Net Tax. Includes entries for 2021 and 2020.

Table with columns for project, ben acres, and factor. Includes entries for 500, 654, 387, 362, 363.

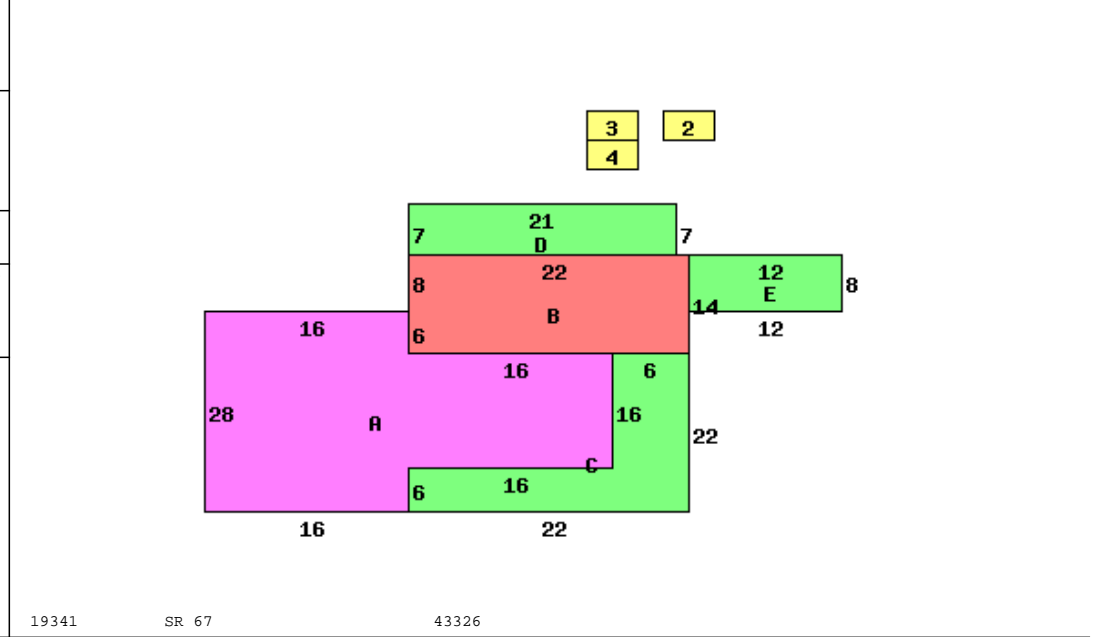

Table with columns for Occupancy, Dwelling Computations, and other details. Includes entries for Single Family, 1T, Main, Part Upper, Subtotal, Shingle, Roof, GABLE, Plaster/Drywall, etc.

Table with columns for Bldg Type, SHB+Cons, DixHt, Area, Unit, Grade, Blt/Renov, Replace, Phy, Fnc, True Value. Includes entries for 1, 2, 3, 4.

Call Back: Sign: PSN Date: 2015-05-06 Lister: 14-110019.0000-v082020R