

GOSHEN TWP 00130 Hardin County, Ohio Michael T. Bacon, Auditor 14-100030.0000 RES 2025 KENTON SD

sale

Eff Rate:- 51.44 44.77 47.15 46.85 a/r

Table with columns: Year, Sale#, Sale Date, To, Type/Invalid?, Sale\$, Co:land, Co:blgd. Includes entries for 2022-2025.

Table with columns: Tax Year, Prop Cls, Acres, Land100%, Bldg100%, Totl100%, Cauv100%, Tax Value, Land 35%, Bldg 35%, Totl 35%, Hmstd35%, Owner Oc, Hmstd RB, Net Tax, Sp-Asmnt. Includes values for years 2022-2025.

2027 LETHAM ANNA & DANIEL 2026-01-28 18322 SR 67 KENTON OH 43326

Table with columns: SHB+, CONS, TYPE, FACT, SQ-FT, VALUE, a, *MAIN, b, PORCH, c, GRAGE, d, PORCH.

Table with columns: Sale#, #p, sale date, To, Type/Invalid?, Sale\$, co:land, co:blgd. Includes historical sales data.

Table with columns: Year, Land, Bldg, Total, Net Tax. Shows tax history for years 2021 and 2020.

Project 106 REELHORN - TYMOCHTEE 500 HARDIN COUNTY LANDFILL XA/2025

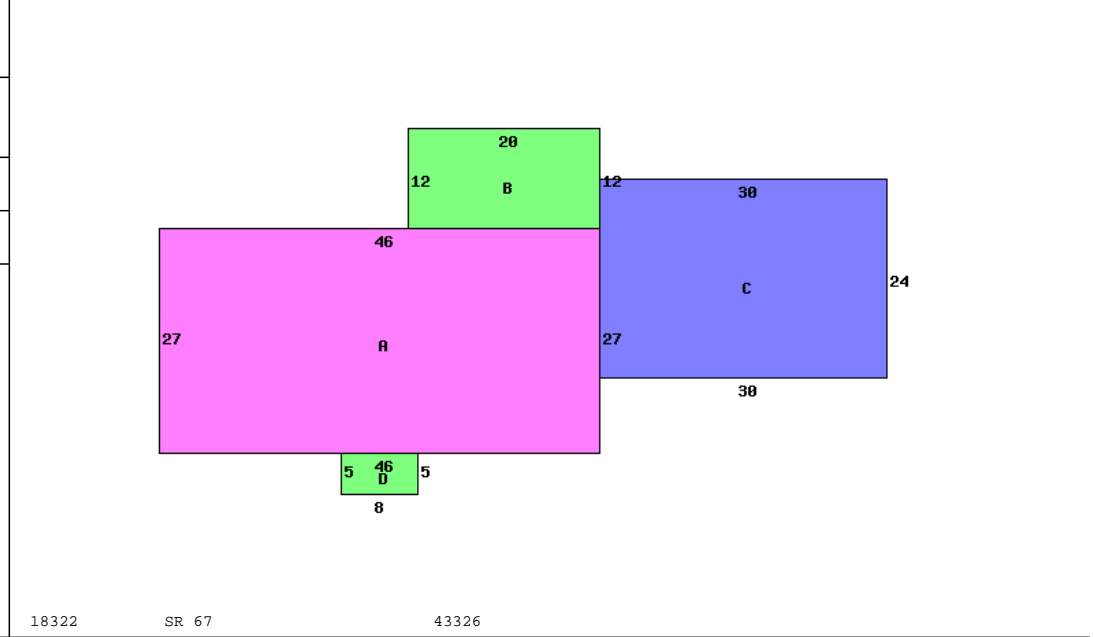

18322 SR 67 43326

Table with columns: Occupancy, Story Height, Floor Level, Main, Qtr Story, Subtotal, Roof, Shingle, Bedrooms, Central Heat, Plumbing, Standard, Extra 3 Fixture, Extra 2 Fixture. Includes Dwelling Computations and other details.

Table with columns: Bldg Type, SHB+Cons, DixHt, Area, Unit Rate, Grade, Blt/Renov, Replace, Phy Fnc, True Value. Includes details for Dwelling, homesite, and small acreage road.