

GOSHEN TWP KENTON SD 00130 Hardin County, Ohio Michael T. Bacon, Auditor 14-100027.0000 RES 2025 B40.03

sale

Table with columns for year, owner name (JOHNSON GREGORY L & E), address (18438 SR 67), and value (\$55,000).

Table with columns for Eff Rate (51.44, 44.77, 47.15, 46.85), Tax Year (2022-2025), and various tax components like Land 35%, Bldg 35%, etc.

Table with columns for SHB+, CONS, TYPE, FACT, SQ-FT, VALUE, and ADDTN.

Table with columns for Sale#, #p, sale date, To, Type/Invalid?, Sales\$, co:land, co:bldg.

Table with columns for Year, Land, Bldg, Total, Net Tax.

Project 106 REELHORN - TYMOCHTEE 500 HARDIN COUNTY LANDFILL

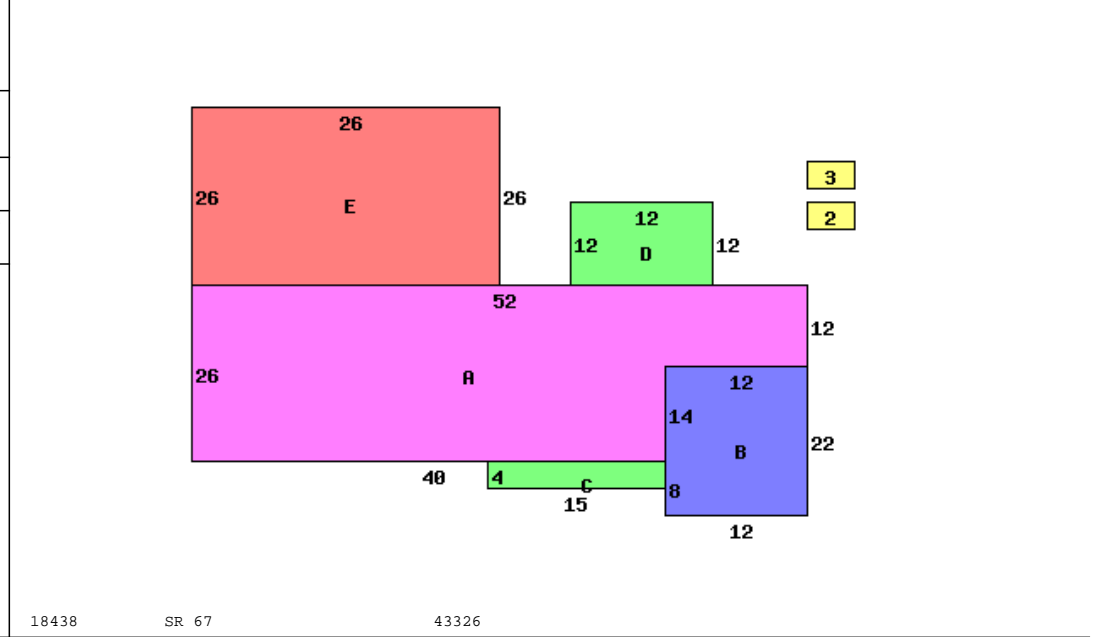

Table with columns for Occupancy (Single Family), Dwelling Computations (Sq-Ft, Value), and various building details like Story Height, Floor Level, etc.

Table with columns for Bldg Type, SHB+Cons, DixHt, Area, Unit Rate, Grade, Blt/Renov, Replace, Phy Fnc, True Value, and other property metrics.