

GOSHEN TWP KENTON SD 00130 Hardin County, Ohio Michael T. Bacon, Auditor 14-090034.0000 RES 2025 B75.01

sale

Table with columns for year (2022-2025), name (SHERMAN MARK P & MICHELE), address (8703 CR 205), and value (\$149,200).

Table with columns for Eff Rate (51.44-46.85), Tax Year (2022-2025), and various tax components like Land 35%, Bldg 35%, etc.

Table with columns for SHB+ (1HB), CONS (F), TYPE (M), FACT (A), SQ-FT (800), and VALUE (1440).

Table with columns for Sale# (671), #p (1), sale date (2021-12-17), and other sale details.

Table with columns for Year (2021), Land (7520), Bldg (27940), Total (35460), and Net Tax (1252.14).

Table with columns for project (500 HARDIN COUNTY LANDFILL) and ben acres / % factor (XA/2025).

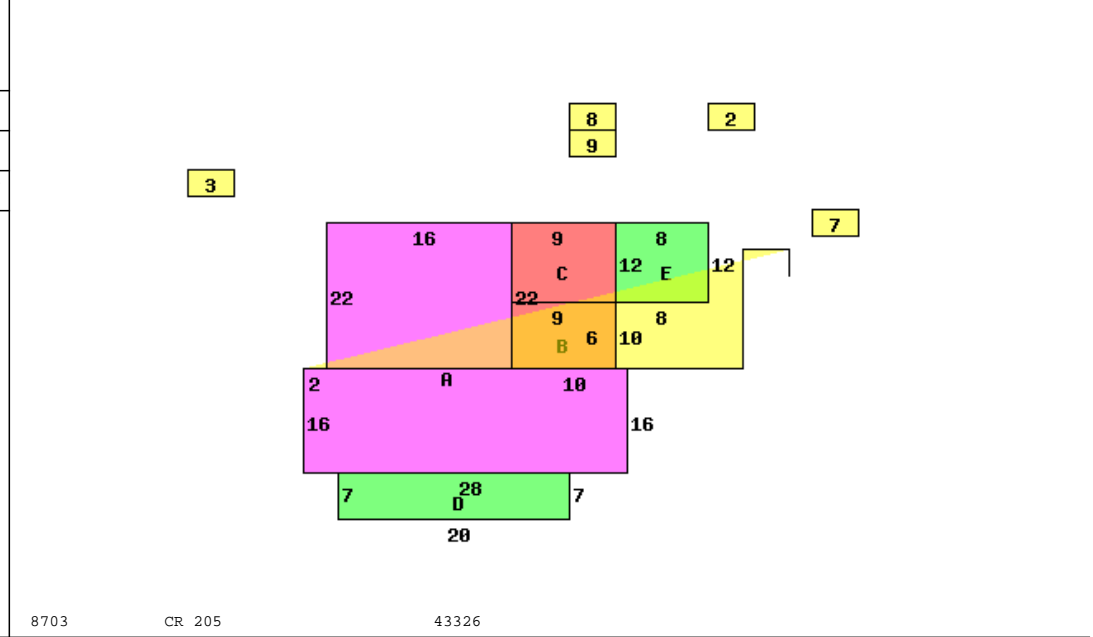

Table with columns for occupancy (Single Family), dwelling computations (Sq-Ft, Value), and various building features like floor level, metal roof, and plumbing.

Table with columns for Bldg Type (DWELLING, Flat Barn, Shed, Hog House, CABIN), SHB+Cons (1HB F, \*SV, OFP), and various dimensions and values.

GOSHEN TWP  
KENTON SD

00130

Hardin County, Ohio  
Michael T. Bacon, Auditor

14-090034.0000  
B75.01

RES  
2025

CAMA / Cont: 1

SHB+	CONS	TYPE	FACT	SQ-FT	VALUE		
2	M	M		1520		a	*MAIN
1	M	G		1140	31920	b	GRAGE
	OFF	P		840	25200	c	PORCH
	OFF	P		120	3600	d	PORCH

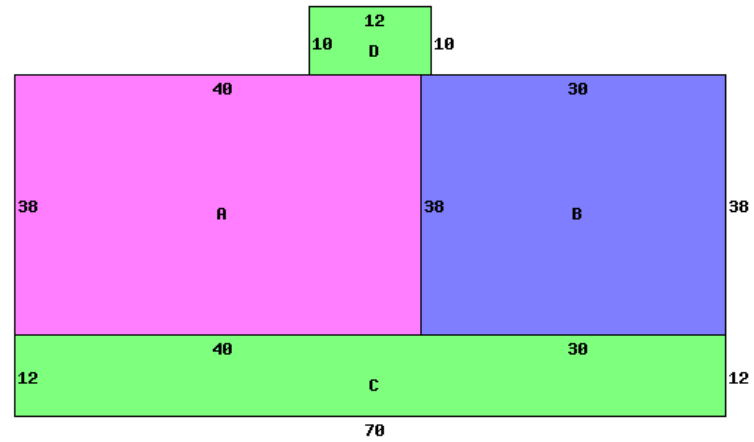

Occupancy 1 Single Family		*DWELLING COMPUTATIONS	
		Sq-Ft	Value
Story Height	2		
Floor Level	Main	FRAME	1520 120050
	Full Upper	FRAME	1520 71930
	Subtotal		191980
Metal			
Plaster/Drywall	B 1 2 U A		
Bedrooms	D D	Air Conditioning	5160
	3	Plumbing	2100
Central Heat	A	Garages and Carports	31920
Central A/C	A	Extra Features	28800
Plumbing		Total Value	259960
Standard	1		
Extra 3 Fixture	1		

Bldg Type	SHB+Cons	DixHt	Area	Unit	Grade	Blt/Renov	Replace	Phy	Fnc	True
1 DWELLING	1HB F	FtxFt	1798	Rate	C	1910AV	161730	Dpr	Dpr	Value
								.55		90250

Call Back: - - - - Sign: Date: Lister: 14-090034.0000-v082020R