

GOSHEN TWP KENTON SD 00130 Hardin County, Ohio Michael T. Bacon, Auditor 14-090017.0000 RES 2025 B74

sale

Eff Rate:- 51.44 44.77 47.15 46.85 a/r

Table with columns: Year, SQ-FT, VALUE, a, b, c, d, e, f. Rows include 2022-2025 for WOOD ROBERT W & BARBA and KENTON OH 43326.

Table with columns: Tax Year, Prop Cls, Acres, Land100%, Bldg100%, Totl100%, Cauv100%, Tax Value, Land 35%, Bldg 35%, Totl 35%, Hmstd35%, Owner Oc, Hmstd RB, Net Tax, Sp-Asmnt. Rows include 2022-2025 and various tax values.

Table with columns: SHB+, 1 B, 1, CONS, TYPE, FACT, SQ-FT, VALUE, a, b, c, d, e, f. Rows include 178, 571, 1991-07-19.

Table with columns: Sale#, #p, sale date, To, Type/Invalid?, Sales\$, co:land, co:blgd. Rows include 178, 571, 1991-07-19.

Table with columns: Year, Land, Bldg, Total, Net Tax. Rows include 2021, 2020.

Project 500 HARDIN COUNTY LANDFILL XA/2025 ben acres / % factor

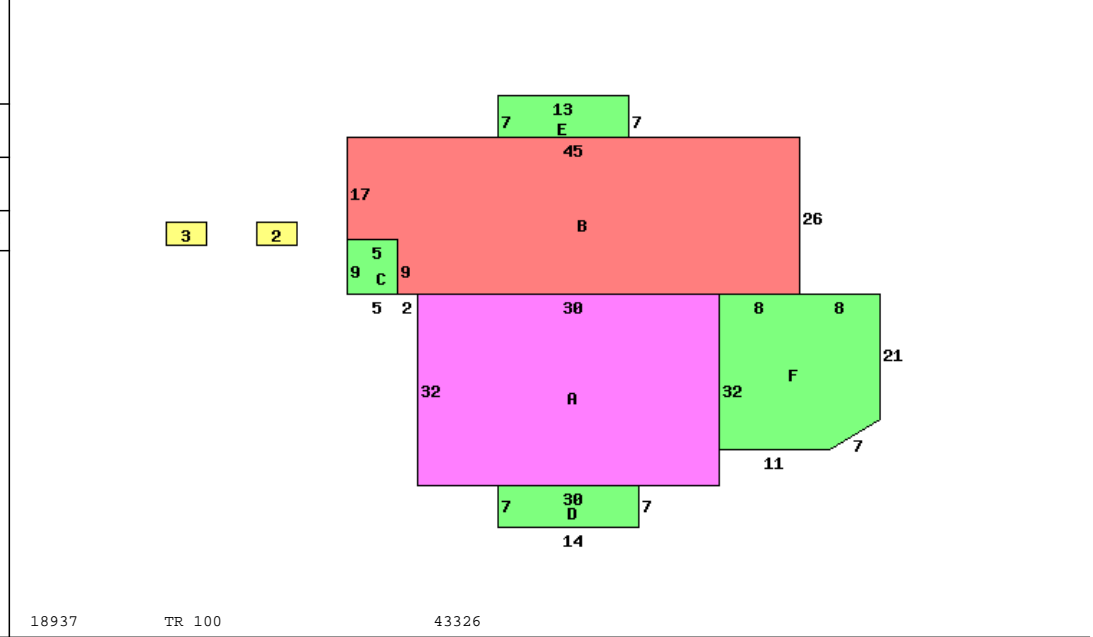

Table with columns: Occupancy, *DWELLING COMPUTATIONS, Sq-Ft, Value. Rows include Story Height, Floor Level, Shingle, Plaster/Drywall, Unfinished Wall, etc.

Table with columns: Bldg Type, SHB+Cons, DixHt, Area, Unit, Grade, Blt/Renov, Replace, Phy, Fnc, True Value. Rows include 1 DWELLING, 2 Garage, 3 Flat Barn.

Table with columns: acres/frontage, effective frontage, depth, actual rate, effective rate, extended value, true value. Rows include homesite, small acreage, Total Value.