

GOSHEN TWP KENTON SD 00130 Hardin County, Ohio Michael T. Bacon, Auditor 14-070021.0000 RES 2025 D04

sale

Eff Rate:- 51.44 44.77 47.15 46.85 a/r

Table with columns: Year, Sale#, #p, sale date, To, Type/Invalid?, Sale\$, co:land, co:bldg. Includes rows for 2022-2025 sales to SCHUTTE ROBERT E & INA.

Table with columns: Tax Year, Prop Cls, Acres, Land100%, Bldg100%, Totl100%, Cauvl00%, Tax Value, Land 35%, Bldg 35%, Totl 35%, Hmstd35%, Owner Oc, Hmstd RB, Net Tax, Sp-Asmnt. Includes rows for years 2022-2025.

Table with columns: SHB+, CONS, TYPE, FACT, SQ-FT, VALUE. Includes rows for 1, 160, 2400, 160, 4800, 648, 15550.

Table with columns: Year, Land, Bldg, Total, Net Tax. Includes rows for 2021 and 2020.

Table with columns: project, ben acres, / % factor. Includes rows for 500 HARDIN COUNTY LANDFILL, 387 SANDERS DITCH, 362 SANDERS DITCH-TYMOCHTEE.

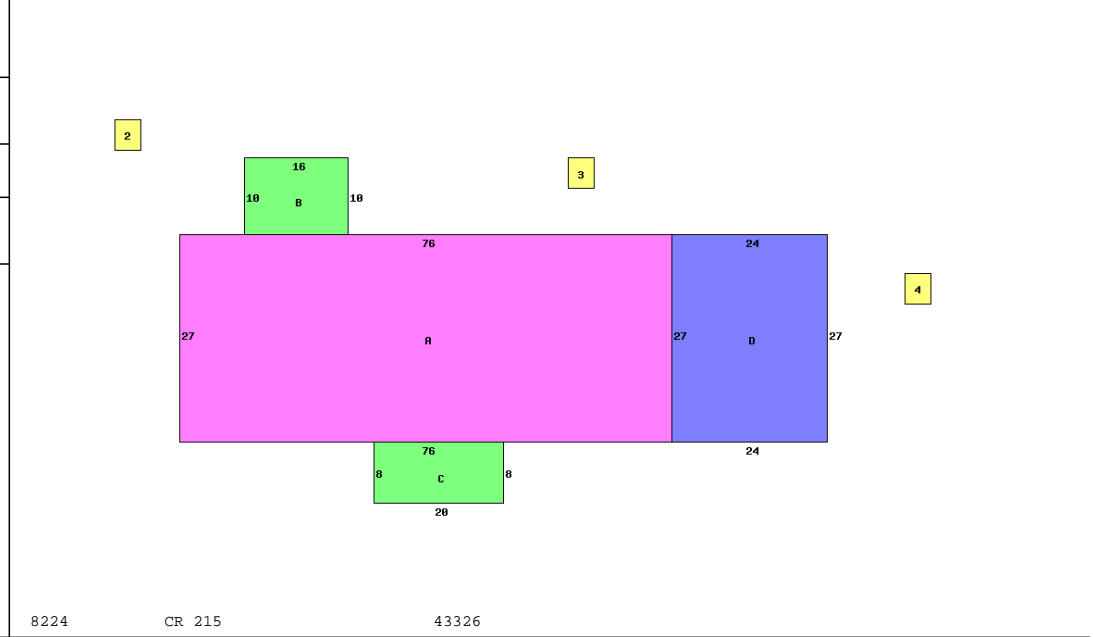

Table with columns: Occupancy, \*DWELLING COMPUTATIONS, Sq-Ft, Value. Includes rows for Story Height, Floor Level, Metal Roof, Plaster/Drywall, etc.

Table with columns: Bldg Type, SHB+Cons, DixFt, Area, Unit Rate, Grade, Blt/Renov, Replace, Phy, Fnc, True Value. Includes rows for MH/REAL, Shed, Pole Build, homesite, small acreage.