

GOSHEN TWP 00130 Hardin County, Ohio Michael T. Bacon, Auditor 14-060010.0000 D35 AGR 2025 KENTON SD

sale

2022 HEILMAN GARY IBER
2023 HEILMAN GARY IBER
2024 HEILMAN GARY IBER
2025 HEILMAN GARY I & PATRIC
21391 CR 100
KENTON OH 43326

2024-10-02 E 1/2 SW 1/4 S15 76.00A
2SD
\$0

Table with columns: Tax Year (2022-2025), Prop Cls, Acres, Land100%, Bldg100%, Totl100%, Cauv100%, Tax Value (Land 35%, Bldg 35%, Totl 35%, Hmstd35%, Owner Oc, Hmstd RB), Net Tax, Cauv Sav, Sp-Asmnt. Includes values for 2022-2025 and CAMA 111.

Table with columns: SHB+, LHB, 1, CONS, TYPE, FACT, SQ-FT, VALUE, a, \*MAIN, ADDTN, PORCH, PORCH.

Table with columns: Sale#, #p, sale date, To, Type/Invalid?, Sales\$, co:land, co:blgd.

Table with columns: Year, Land, Bldg, Total, Net Tax.

Table with columns: project, ben acres, % factor.

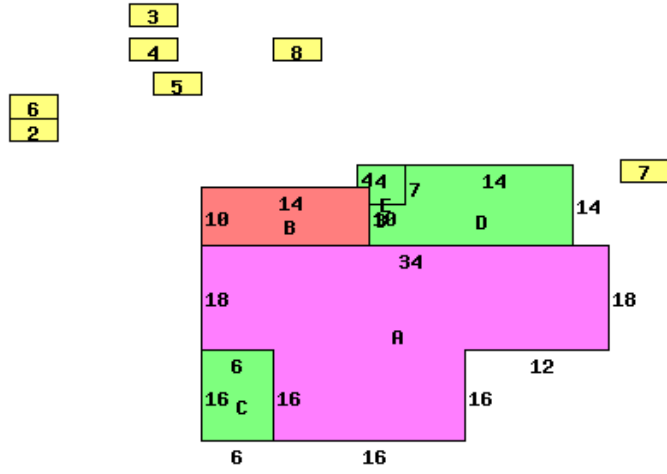

21391 CR 100 43326

Table with columns: Occupancy, \*DWELLING COMPUTATIONS, Story Height, Floor Level, Shingle, Plaster/Drywall, Unfinished Wall, Floor/Pine, Number of Rooms, Bedrooms, Central Heat, Plumbing, Standard.

Table with columns: Bldg Type, SHB+Cons, DixHt, Area, Unit Rate, Grade, Blt/Renov, Replace, Phy Dpr, Fnc Dpr, True Value, Tab #, S O I L, Acres, Mkt/Ac, Market, Au/Ac, Cauv.

Call Back: Sign: PSN Date: 2015-05-14 Lister: 14-060010.0000-v082020R