

GOSHEN TWP 00130 Hardin County, Ohio Michael T. Bacon, Auditor 14-050009.0000 AGR 2025 KENTON SD F04

sale

Table with columns for year, name (HEILMAN GARY), address (22317 & 22341 CR 100), and value (\$0).

Table with columns for Tax Year (2022-2025), Acres, Land/Building values, and Tax Value breakdown.

Table with columns for SHB+, CONS, TYPE, FACT, SQ-FT, VALUE, and various codes (a-f).

Table with columns for Sale#, #p, sale date, To, Type/Invalid?, Sales\$, co:land, co:bdg.

Table with columns for Year, Land, Bldg, Total, Net Tax.

Project: 500 HARDIN COUNTY LANDFILL, XA/2025, ben acres / % factor

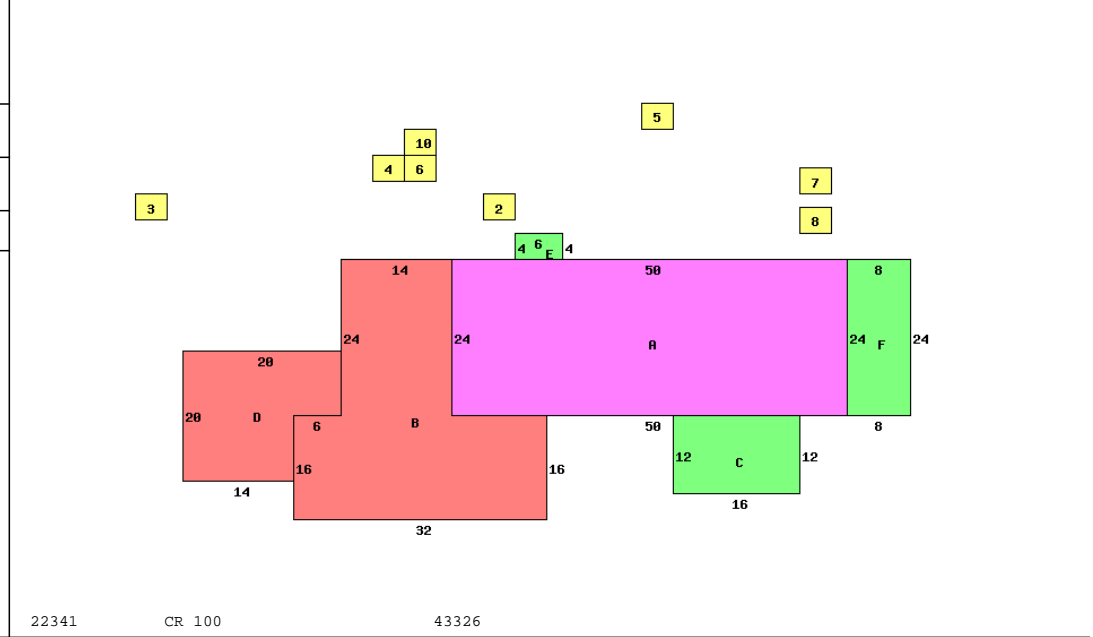

Table with columns for Occupancy (Single Family), Dwelling Computations (Sq-Ft, Value), and other details like Fireplaces, Plumbing.

Table with columns for Bldg Type, SHB+Cons, DixHt, Area, Unit Rate, Grade, Blt/Renov, Replace, Phy, Fnc, True Value, and other specifications.

Call Back: Sign: PSN Date: 2015-04-28 Lister: 14-050009.0000-v082020R