

GOSHEN TWP 00130 Hardin County, Ohio Michael T. Bacon, Auditor 14-040019.0000 RES 2025 KENTON SD A56

sale

Eff Rate:- 51.44 44.77 47.15 46.85 a/r

Table with columns: Year, Bldg, Land, Total, Net Tax. Rows for 2022-2025 BAILEY BRUCE A and 19397 TR 90.

Table with columns: Tax Year, Land 35%, Bldg 35%, Totl 35%, Hmstd35%, Owner Oc, Hmstd RB, Net Tax, Sp-Asmnt. Rows for years 2022-2025.

Table with columns: SHB+, CONS, TYPE, FACT, SQ-FT, VALUE. Rows for various building components like *MAIN, ADDTN, PORCH, GRAGE.

Table with columns: Sale#, #p, sale date, To, Type/Invalid?, Sale\$, co:land, co:bldg. Row for 740 1 1995-08-09 BAILEY JOHN H & AMINELLE.

Table with columns: Year, Land, Bldg, Total, Net Tax. Rows for 2021 and 2020.

Project 250 PFEIFFER DITCH TYMOCHTEE CRE 500 HARDIN COUNTY LANDFILL XA/2025

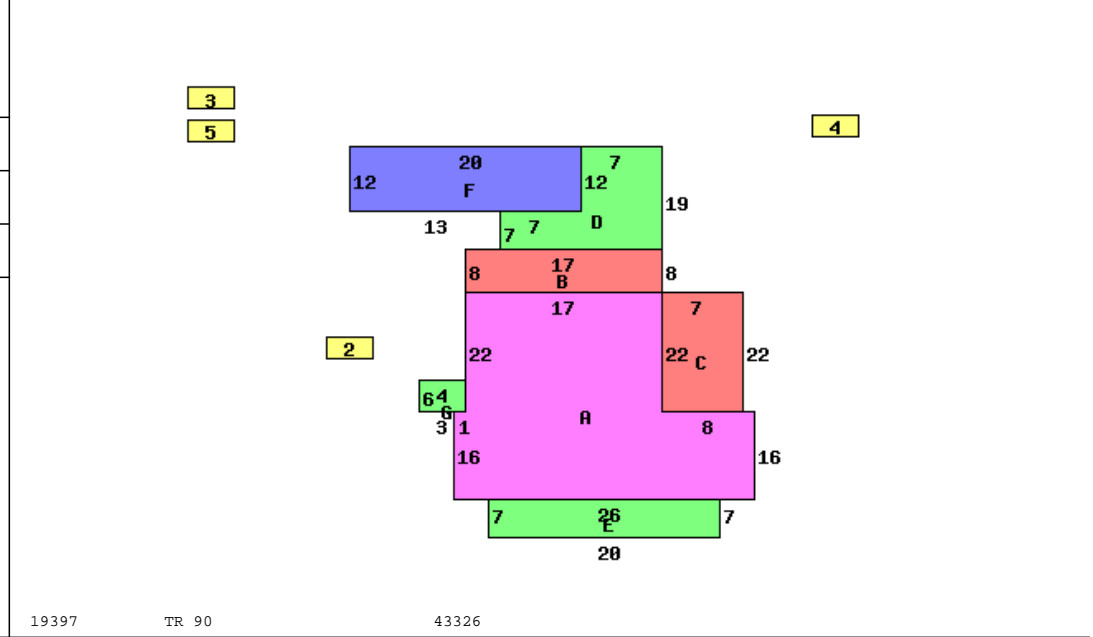

Table with columns: Occupancy, Story Height, Floor Level, Shingle, Plaster/Drywall, etc. Rows for Single Family, 1T, Main, Part Upper, Subtotal, Roof, B 1 2 U A.

Table with columns: Bldg Type, SHB+Cons, DixHt, FtxFt, Area, Unit Rate, Grade, Blt/Renov, Replace, Phy, Fnc, True Value. Rows for DWELLING, Flat Barn, Shed, Hog House, Shed.

Call Back: Sign: PSN Date: 2015-04-30 Lister: 14-040019.0000-v082020R