

GOSHEN TWP KENTON SD 00130 Hardin County, Ohio Michael T. Bacon, Auditor 14-040006.0000 A59 AGR 2025

sale

Eff Rate:- 51.44 44.77 47.15 46.85 a/r

Table with columns for year (2022-2025), owner (PFEIFFER FAMILY TRUST, TONY R), and acreage (80.00A).

Table with columns for Tax Year (2022-2025), Prop Cls, Acres, Land/Blgd/Totl 100%, and Tax Value (Land, Bldg, Totl 35%, Hmstd35%, Owner Oc, Hmstd RB, Net Tax, Cauv Sav, Sp-Asmnt).

Table with columns for SHB+ (1T), CONS (F/C), TYPE (M, A, P), FACT (A, P), SQ-FT (960, 160, 80, 286, 208), VALUE (2400, 6240), and a-e (\*MAIN, ADDTN, PORCH).

Table with columns for Sale#, #p, sale date, To, Type/Invalid?, Sale\$, co:land, co:blgd.

Table with columns for Year (2021, 2020), Land, Bldg, Total, Net Tax.

Table with columns for project (250 PFEIFFER DITCH TYMOCHTEE CRE, 500 HARDIN COUNTY LANDFILL), ben acres, and % factor.

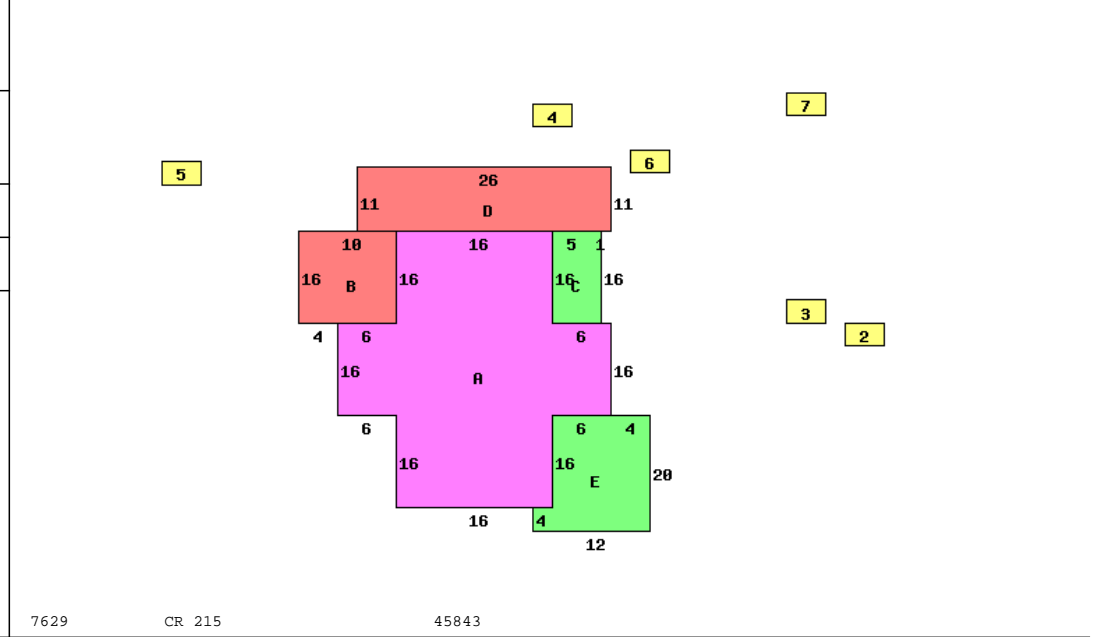

7629 CR 215 45843

Table with columns for Occupancy (1 Single Family), \*DWELLING COMPUTATIONS (Sq-Ft, Value), and various building details (Story Height, Floor Level, Metal, Plaster/Drywall, etc.).

Table with columns for Bldg Type, SHB+Cons, DixHt, Area, Unit Rate, Grade, Blt/Renov, Replace, Phy Fnc, True Value, and a list of soil types (BOA, BOB, PM, W, W 39) with their respective Acres, Mkt/Ac, Market, Au/Ac, and Cauv values.

Call Back: Sign: PSN Date: 2015-04-30 Lister: 14-040006.0000-v082020R